

← A4 →

← LETTER →

1915

LEVEL BOOK

370



Pl def 34°

Elv S40°W 66'
 Corabuck S10°W 54'
 Sta 0 + 62

Joe A. Hadley Rd.

L def 23° 6'
 Sycamore 36 N65W 25.5'
 Concrete post S 38' Sta 1 + 79
 L def 26° 45'
 W 22.4' back post 270 25'
 N40W 29.4 concrete post 3 + 65

N25°E .99 / spruce 14' dia
 N70W 1.29 cherry 11' dia

Squid post 35.5 ch Sta 10 + 26
 Ingate post 35.5 ch
 N def 90 15'

Send Stamp post 115' → Sta 17 + 46
 Ingate N65°W 58'

610 y'
 Send W post E 116'
 SE corner N60W 44' 1/8 + 80

2

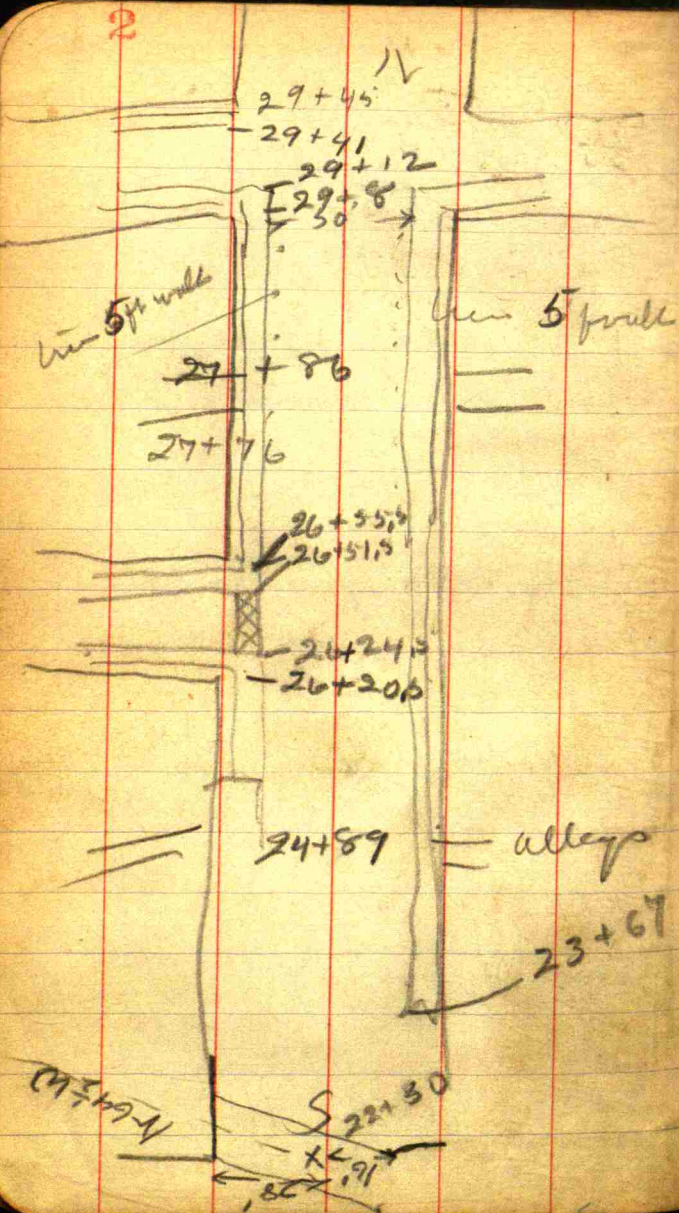

50
10
40
16
24

41
12
2) 29
14.5
12
26.5
23
37.5
48.5

3

W

Only 9

$36+37$
 $36+32$
 $35+83$
 $35+78$

$34+17$

$34+7$

width $29\frac{1}{2}$

East edge walk
 North side
 West edge walk

$32+87$

$32+30$

$30+87$

$30+77$

$29+51\frac{1}{2}$
 East edge walk

width $29\frac{1}{2}$

W

5

$2/295$
 14.75
 20
 14.75
 5.25

$45 @ 9.25$
 14.50
 449470

East edge walk
 North side
 West edge walk

$39+44$
 $39+13$

6
Linn 49
B wal 20
Chery 24

Cor Vin and W
Cor Veranda
11

7
Cente Roundball Red
N60E 31'
N10W 22½'

SL
N30W 5.3'
S40W 29.7

Sta	BS	HI	FS	elev
	10.00	10.00		
0			1.00	9.00
1			4.70	5.30
2			4.90	5.10
3			4.00	6.00
4			3.20	6.80
4	6.10	12.90		
5			5.30	7.60
6			5.10	7.80
7			4.85	8.05
8			4.30	8.60
9			3.50	9.40
9	10.70	20.10		
9+30	W		11.50	8.60
	E		13.20	6.90
10			9.00	11.10
10+30			8.70	11.40

Edge water pond
N end bridge

level of land

Spring 6 1/2 miles

Gas Hadley bar gate

10

bs hi fs

11 20.10 4.05 16.05

12 -15 20.25

12 6.10 26.35

11 + 70 5.10 21.25

BM 12 + 50 5.40 20.95

13 5.00 21.35

13 + (-) 4.65 21.70

14 5.10 21.25

15 9.10 17.25

16 11.60 14.75

16 4.95 19.70

16 + 50 W 8.00 11.70

E 9.50 9.90

17 4.50 14.90

17 + 20 36.40

3.30 16.40

18 3.40 16.30

11

Jan Huddy's yd gate
Eds yd gate

Eds van gate

100 A level land

Ry trace 21.50 ft above
Bridge NE

18 19.70 270 17.00

19 635 28.35

11.00 12.35

5.30 18.05

20

4.60 18.75

17+50 W

8.90 14.45

E

9.60 13.75

19 W

7.00 16.35

21

3.60 19.75

22

.80 22.55

22 9.10 31.65

22+30 W

12.00 19.65

23

5.00 26.65

~~24~~

.90 30.75

24 11.10 41.85

24,

8.90 32.95

25

5.20 36.65

Intersect west

delete bottom under body
top finished

60 ft

culvert

14

41.85 800 33.85

6.40 35.45

2.80 39.05

1.50 40.35

3.50 38.35

2.00 39.85

27 6.90 46.75

6.90 39.85

6.60 40.15

4.85 41.90

6.40 40.35

5.90 40.85

5.40 41.35

6.80 48.15

5.90 42.25

5.00 43.15

5.30 42.85

4.90 43.25

15

Send walk E side
ground front beyond
South end W walk
Street crossing west

alley

Crossing West

alley

~~Street~~

East Crossing West St

West

alley

Cur

alley

16

48.15 530 42.85

470 43.45

650 49.95

490 45.05

450 45.45

3.50 46.45

H0

H1

H1 10.70 57.15

H2

10.00 47.15

B M

9.70 47.45

H3

8.40 48.75

H4

2.55 54.60

330 53.85

12.00 45.15

1.60 55.55

H6

H6 10.60 66.15

H7

850 57.65

H8

4.30 61.85

H9

H.70 61.45

17

E on Cal St

W "

Bundy alk St

Street

end walk right hand

turn north
one square south

walk 37.85

18

BS HI

Bridge

14.00 ~~1.80~~ 13.20

11.20 2.80

11.00

300

Sta 37+55

19

Grade Sta 38

Shear button

elev jump ²⁴elev bridge ²⁰⁰ ~~400~~

20

$$\begin{array}{r} 56 \\ 5380 \\ \hline \end{array}$$

$$\begin{array}{r} 5380 \\ 350 \\ \hline 5730 \\ 56 \\ \hline 1.30 \end{array}$$

H I

$$\begin{array}{r} 250 \\ 130 \\ \hline 1.20 \end{array}$$

$$\begin{array}{r} 5730 \\ 950 \\ \hline 4780 \\ 4500 \\ \hline 280 \end{array}$$

950

21

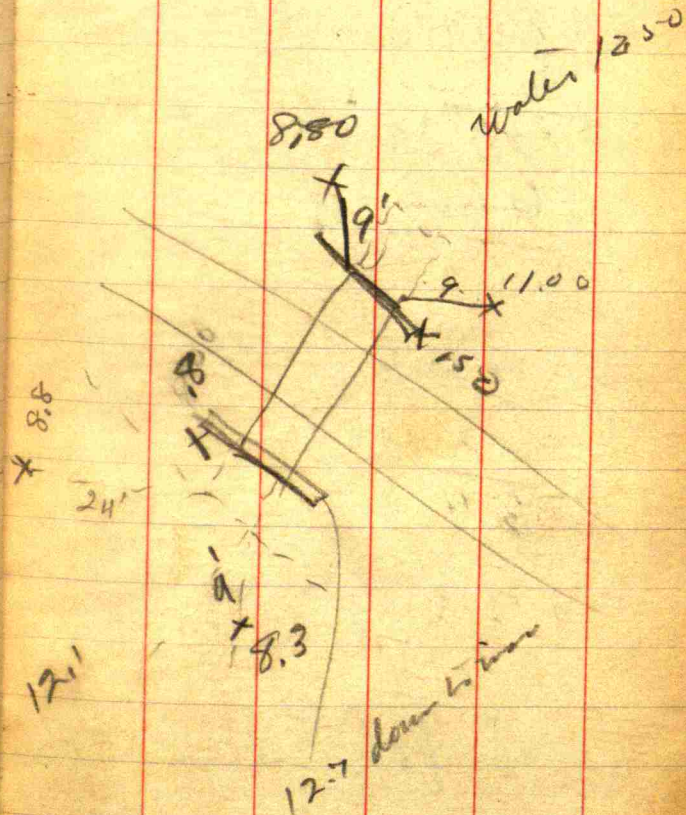

22

10 1 — 64.60
 Roadway 66.30

$$\begin{array}{r}
 64.60 \\
 5.60 \\
 \hline
 70.20 \\
 66.30 \\
 \hline
 0
 \end{array}$$

$$\begin{array}{r}
 70.20 \\
 5.60 \\
 \hline
 64.60
 \end{array}$$

$$\begin{array}{r}
 66.30 \\
 64.60 \\
 \hline
 1.70
 \end{array}$$

23

Greasy Creek
\$600.00

Robt Hunt Bridge flow 16 x 92 4 x 15 - 2 x 16

Fitcher Bridge Nov 24 1,000.00

Spencey Win 14 x 56 4 - 14
5' over beam

Stanley Bridge 24' roadway 26' span

John Hodley Br idg 60' arch 2000.00

Robert Bridge 60' arch 2000.00

John Hodley " 2000.00

Hansen flat arch 40 " 1200

16' span 6' roadway

26

McClain Arch 10' span 6'

Elmer Jenkins Bridge

Kille Bridge black

Wilbur Hanna Arch

Cox Bridge steel 60'

Sunder Bridge black

New James Bridge 8'

Fahley Bridge 12'

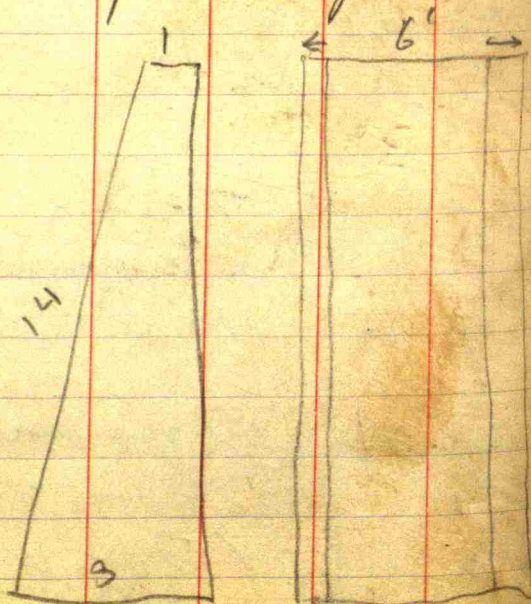

waterway

400⁰⁰

16 x 6

700⁰⁰

16' road

floor 16 x 33

5 x 8

20' road

span

3000⁰⁰

floor 20.5 x 54.3

flat top 30' long 600⁰⁰

flat top 500

$$2 \times 2 \times 14 \times 6$$

27

9 11 12

19 gravel

65 by concrete

27

820 91

pt 170' west of N-MW 4

N 49° 44' E

92 + 84

N 68° 25' E

94 + 9

S 80° E

86

S 81° E

108

N 76° E

111 + 42

S 86° E

113

S 89° 31' E

120 + 2

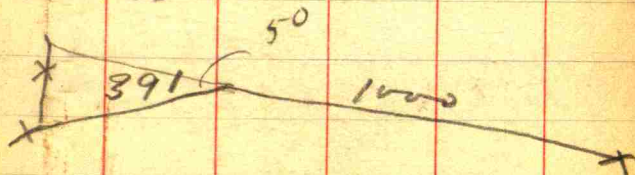

$$\begin{array}{r}
 x = \sin 50 \\
 391 = \frac{391}{.766} \\
 x = 508.7 \\
 \hline
 2737 \\
 3128 \\
 \hline
 34017
 \end{array}$$

$$\begin{array}{r}
 33.5 \\
 15 \\
 4 \\
 \hline
 52.5
 \end{array}$$

$$\begin{array}{r}
 32.7 \\
 15 \\
 4 \\
 \hline
 51.7 \\
 38 \\
 \hline
 13.7
 \end{array}$$

30

$$2 \frac{2}{8} = \frac{14}{8}$$

$$60 \times 12 = 720$$

$$720 \times 8$$

$$19 \overline{) 6260} \quad (330$$

$$57$$

$$56$$

$$55$$

$$330 \times 7 \times 4 \times 14$$

$$\begin{array}{r} 12 \\ 6 \end{array}$$

$$55$$

$$56$$

$$330$$

$$275$$

$$3080$$

$$7 \times 3 \times 3 \times 60^5$$

$$12$$

$$15$$

$$21$$

$$15$$

$$30$$

$$315$$

$$3050$$

$$3395$$

31

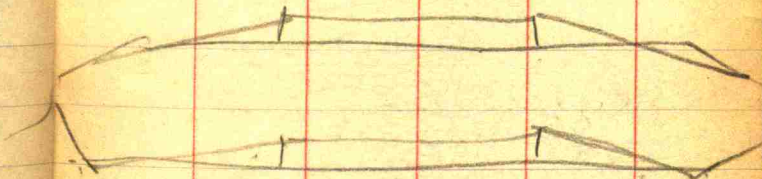

32

Can Road walk 54.11
 Plain St walk 49.95

$$\begin{array}{r} 50.21 \\ \underline{66} \\ 49.55 \end{array}$$

$$\begin{array}{r} 50.28 \\ \underline{49.55} \\ .73 \end{array}$$

Curb top 73 above

33

grade 53.00 curb top 53.73
 50.26

$$\begin{array}{r} 54.11 \\ \underline{5.16} \\ 59.27 \\ \underline{54.73} \\ 4.54 \end{array}$$

Sub-grade

$$\begin{array}{r} 49.85 \\ \underline{6.10} \\ 55.95 \\ \underline{51.26} \\ 4.69 \end{array}$$

	RS		F/S class
0	12.30	12.70	
1			360 8.70
1	13.00	21.70	
2			3.80 17.90
2	10.00	27.90	
3			2.50 25.40

8.7

9.2

7.5

$$\frac{3}{2540}$$

9.5

Curt deviation

Bank St	1380	East side
Vine St	15:20	"
Corn St	1500	East side
Mill St	1390	West side
Fifth St	1310	State 3

Edge & walk E St	299	W. line
" & walk NW St	336	E line
" "	32.2	
	<u>24</u>	
	8.2	

Sta	+	Stake -	T	Ground Elev	Stake Elev	Ground Elev	Old Channel
0-5			103.85	7.25		96.65	
0		4.25		5.78	99.25	98.12	
Starting B.M.		3.85			100.00		Ash 24" Tack & Notch in Root
1		4.17		4.60	99.68	99.25	98.35
2		3.04		3.55	100.81	100.30	+90 - 5.30 1 Bottom
3		2.60		3.20	101.25	3+15	29.71
0	5.95	2.62	107.18			100.65	7.47
4		5.18		5.71	102.00	101.47	100.03
5		4.44		6.54	102.78	4+20	7.15
B.M.		3.51			103.67	100.64	
6		3.36		4.05	103.82	Tack Notch	Root Stump
7		2.92		3.35	104.26	103.13	West of Sta. 5
0	6.11	2.94	110.35			103.83	
8		6.37		7.33	103.98	103.02	
9		4.65		5.18	105.72	105.17	103.65
10		4.29		5.00	106.06	9+15	6.70
11		3.22		4.10	107.12	105.35	
						106.25	105.30
						11+	5.05

101.23
5.95
90.7+18

104.24
6.11
103.5

Sta	+	Slope		Crossing		Elev
		-	A	-		
12		2.80	110.35	3.45	107.55	106.90
0	7.28	2.80	114.83			
13		7.03		7.70	107.80	107.13
14		5.83		6.68	109.00	108.15
BM		3.33			111.50	Tack in stub of small Ash cut off to
15		5.30		5.72	109.53	Left of Sta. 13.
0	5.95	5.30	115.48			
16		5.55		6.50	109.93	108.98
17		4.34		4.95	111.12	110.53
B.M.		4.40			111.00	Tack + notch in root of Elm 20" L of
18.		3.87		4.50	111.61	110.98
19.		3.48		4.00	112.00	111.48
20		3.12		3.90	112.36	111.58
0	5.97	3.12	118.33			
21		4.65		6.98	113.68	111.35
B.M.		4.31			114.03	Tack in Root of Double Elm 30" L. of
22		4.11		4.95	114.22	21 + 30
						113.38

114.83
 5.30
 109.53
 5.95
 113.48

110.35
 2.80
 107.55
 7.28
 114.83

54		Stake		Ground		Elev		55	
Sta	+	-	π	-					
23.		3.50	^{118.33}	4.20	114.53	114.13			
24		2.18		2.65	116.53	115.68			
0	6.00	2.18	122.15	3.08					
25		4.78		5.40	117.37	116.73			
B.M.		3.22			118.93	High point Large Rock	L of 25 + 50		
26.		4.92		5.58	117.23	116.57			
27		3.67		4.41	118.4	117.74			
28		2.85		3.70	119.30	118.45			
29.		2.01		2.76	120.14	120.01			
0	6.86	2.01	126.00						
30		6.20		6.88	119.80	119.12	High point Large Flat Rock		
B.M.		4.10			121.44	to L of Sta 30 + 50. 50 Feet			
31.		5.54		6.35	120.44	119.65			
+ 72		2.65			123.35	^{123.35} Road.			
32.		3.22		3.95	122.71	122.03			
33		4.31		5.30	121.60	120.60			
0	6.33	4.31	128.02						
B.M.		5.20			122.62	Top of Flowing Well			

56		Stake		Ground	
Sta	+	-	Σ	-	
34		6.12	128.02	6.92	122.90 121.10
35		4.42		5.14	123.60 122.88
36		3.35 4.42		4.10 5.14	124.61 123.72
37		2.90		3.53	125.15 124.47
0	8.65	2.90	133.77		
38		8.10		8.90	125.71 124.87
39		6.76		7.40	127.01 126.37
B.M.		6.40			127.31
40		5.53		6.14	128.22
41		3.70		4.20	130.01 129.57
42		2.18		2.75	131.59 131.02
42+55		1.15		2.08	132.65 131.69

Tack & notch Root Walnut 14" L. of
Sta. 39.