

1913

AVON SHOOL DRAIN
BLAIR ROARCK et al DITCH
DICKERSON DITCH
DANVILLE PARK DRAIN

8 Avon School House Drain

Stat.	B.S.	H.I.	F.S.	Elev
B.M.				100
	4.24	104.24		
			2.90	101.34
	9.50 + .50 = 10.00		1.0	
			12.90	90.34
				91.34
14			5.59	98.60
13			4.61	99.63
12			5.80	98.44
110			8.27	95.97
π	3.11	99.08		
10			4.55	94.53
9			4.42	94.66
8			5.56	93.52
7			7.63	91.45
60			9.05	90.03
π	4.40	94.47		
5			5.61	88.86
4			6.22	88.25
3			8.48	85.99
2			9.24	85.23
1			10.56	83.91
0			7.72	86.75
π	4.45	91.20		
			11.73	79.47
			11.65	79.55

91.34 100.00
 5.0 91.34
 90.84 8.66

9

Extreme S.E. corner walk on E. side of S.H.

Window ledge

Bottom of ditch at school house

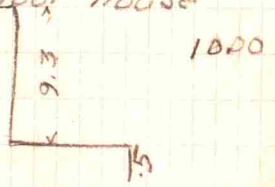

N. rail switch at culvert

Bottom of sewer tile N end

Stat.	B.S.	H.I	FS	Elev
0		91.20	11.25	79.95
		Check	Back	
		91.20		
0			2.76	88.44
π	11.31	99.75		
6			9.71	90.04
11 0			3.96	95.79
π	8.50	104.29		
14			5.92	98.37
			4.52	99.77
	4.36	104.36		
			11.89	92.47
14			12.16	92.20
			5.76	98.60
		Check		
	2.44	102.44		
14			3.84	98.60
13			2.79	99.65
12			3.99	98.45
11			6.42	96.02

92.20
 91.34
 .86

79.95
 79.47
 .48

97
 79
 .18

Stat 0

98.37
 18.65
 28

23

Floor under man-hole
 " at chute entrance

12

Stat.	B.S.	H.I.	F.S.	Elev
		102.44		
10.			7.85	94.59
9.			7.69	94.75
8.			8.85	93.59
7.			10.85	91.59
6.			12.26	90.18

Ditch around S.H.

	4.10	104.10		
+ 87			4.74	99.36
	4.97	103.33		
2.			4.90	98.43
			4.46	98.87

13

$$\begin{array}{r} 98.43 \\ 90.36 \\ \hline 8.07 \end{array}$$

$$\begin{array}{r} 98.87 \\ 90.36 \\ \hline 8.51 \end{array}$$

$$\begin{array}{r} 49.36 \\ 90.75 \\ \hline \end{array}$$

$$\begin{array}{r} 99.36 \\ 90.25 \\ \hline 9.11 \end{array}$$

S.W. corner

N.W. corner

Walk

16

25. 98.90 - 26 - 99.43

Bearing $N 99^{\circ} 15' E$

17

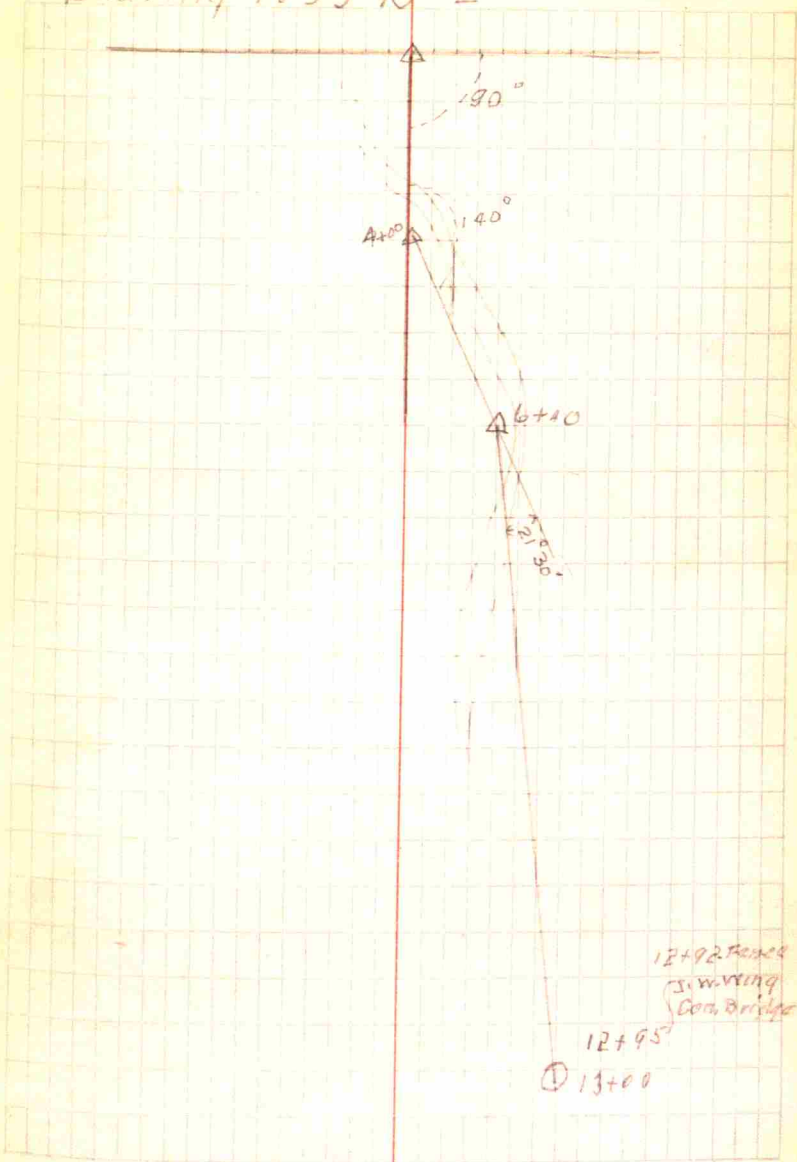

Sta 6100
4174DINA 31
4174

Rocosty

Sta 1400
4174

4172

5735

1400 deprecias

Power 32.2

Sta 1700

Edwin D. Green

5735

no. 11 379 Road

Sta 3100

E. Green

B. N. 39.12

3498 P. Bank

W. H. Green 197

Sta 4100

BAC 95.14

4658

119W5

5100

12.20

4.76

5735

ECV

3.10

7808K

7808K

103.24

7.89

94.14

19.0

96.07

16.25

89.82

9.42

11.64K

13.50

46.14

2.20

16.16

6.42

18.68K

Ph. solvent 150

2 FEB	0.00	Stas 5.00	61 FEB	4.00	13/11/18	W.C.A. 1/18
5 FEB	0.50	Stas 6.00	16 FEB	4.00	14/11/18	10/11/18
5 FEB	0.50	Stas 7.00	17 FEB	4.00	15/11/18	11/11/18
2 FEB	0.10	Stas 8.00	18 FEB	4.00	16/11/18	12/11/18
2 FEB	0.10	Stas 9.00	19 FEB	4.00	17/11/18	13/11/18
2 FEB	0.10	Stas 10.00	20 FEB	4.00	18/11/18	14/11/18
2 FEB	0.10	Stas 11.00	21 FEB	4.00	19/11/18	15/11/18
2 FEB	0.10	Stas 12.00	22 FEB	4.00	20/11/18	16/11/18
2 FEB	0.10	Stas 13.00	23 FEB	4.00	21/11/18	17/11/18
2 FEB	0.10	Stas 14.00	24 FEB	4.00	22/11/18	18/11/18
2 FEB	0.10	Stas 15.00	25 FEB	4.00	23/11/18	19/11/18
2 FEB	0.10	Stas 16.00	26 FEB	4.00	24/11/18	20/11/18
2 FEB	0.10	Stas 17.00	27 FEB	4.00	25/11/18	21/11/18
2 FEB	0.10	Stas 18.00	28 FEB	4.00	26/11/18	22/11/18
2 FEB	0.10	Stas 19.00	29 FEB	4.00	27/11/18	23/11/18
2 FEB	0.10	Stas 20.00	30 FEB	4.00	28/11/18	24/11/18
2 FEB	0.10	Stas 21.00	31 FEB	4.00	29/11/18	25/11/18
2 FEB	0.10	Stas 22.00	1 MAR	4.00	30/11/18	26/11/18
2 FEB	0.10	Stas 23.00	2 MAR	4.00	1/12/18	27/11/18
2 FEB	0.10	Stas 24.00	3 MAR	4.00	2/12/18	28/11/18
2 FEB	0.10	Stas 25.00	4 MAR	4.00	3/12/18	29/11/18
2 FEB	0.10	Stas 26.00	5 MAR	4.00	4/12/18	30/11/18
2 FEB	0.10	Stas 27.00	6 MAR	4.00	5/12/18	1/12/18
2 FEB	0.10	Stas 28.00	7 MAR	4.00	6/12/18	2/12/18
2 FEB	0.10	Stas 29.00	8 MAR	4.00	7/12/18	3/12/18
2 FEB	0.10	Stas 30.00	9 MAR	4.00	8/12/18	4/12/18
2 FEB	0.10	Stas 31.00	10 MAR	4.00	9/12/18	5/12/18
2 FEB	0.10	Stas 32.00	11 MAR	4.00	10/12/18	6/12/18
2 FEB	0.10	Stas 33.00	12 MAR	4.00	11/12/18	7/12/18
2 FEB	0.10	Stas 34.00	13 MAR	4.00	12/12/18	8/12/18
2 FEB	0.10	Stas 35.00	14 MAR	4.00	13/12/18	9/12/18
2 FEB	0.10	Stas 36.00	15 MAR	4.00	14/12/18	10/12/18
2 FEB	0.10	Stas 37.00	16 MAR	4.00	15/12/18	11/12/18
2 FEB	0.10	Stas 38.00	17 MAR	4.00	16/12/18	12/12/18
2 FEB	0.10	Stas 39.00	18 MAR	4.00	17/12/18	13/12/18
2 FEB	0.10	Stas 40.00	19 MAR	4.00	18/12/18	14/12/18
2 FEB	0.10	Stas 41.00	20 MAR	4.00	19/12/18	15/12/18
2 FEB	0.10	Stas 42.00	21 MAR	4.00	20/12/18	16/12/18
2 FEB	0.10	Stas 43.00	22 MAR	4.00	21/12/18	17/12/18
2 FEB	0.10	Stas 44.00	23 MAR	4.00	22/12/18	18/12/18
2 FEB	0.10	Stas 45.00	24 MAR	4.00	23/12/18	19/12/18
2 FEB	0.10	Stas 46.00	25 MAR	4.00	24/12/18	20/12/18
2 FEB	0.10	Stas 47.00	26 MAR	4.00	25/12/18	21/12/18
2 FEB	0.10	Stas 48.00	27 MAR	4.00	26/12/18	22/12/18
2 FEB	0.10	Stas 49.00	28 MAR	4.00	27/12/18	23/12/18
2 FEB	0.10	Stas 50.00	29 MAR	4.00	28/12/18	24/12/18
2 FEB	0.10	Stas 51.00	30 MAR	4.00	29/12/18	25/12/18
2 FEB	0.10	Stas 52.00	31 MAR	4.00	30/12/18	26/12/18
2 FEB	0.10	Stas 53.00	1 APR	4.00	31/12/18	27/12/18
2 FEB	0.10	Stas 54.00	2 APR	4.00	1/1/19	28/12/18
2 FEB	0.10	Stas 55.00	3 APR	4.00	2/1/19	29/12/18
2 FEB	0.10	Stas 56.00	4 APR	4.00	3/1/19	30/12/18
2 FEB	0.10	Stas 57.00	5 APR	4.00	4/1/19	31/12/18
2 FEB	0.10	Stas 58.00	6 APR	4.00	5/1/19	1/1/19
2 FEB	0.10	Stas 59.00	7 APR	4.00	6/1/19	2/1/19
2 FEB	0.10	Stas 60.00	8 APR	4.00	7/1/19	3/1/19
2 FEB	0.10	Stas 61.00	9 APR	4.00	8/1/19	4/1/19
2 FEB	0.10	Stas 62.00	10 APR	4.00	9/1/19	5/1/19
2 FEB	0.10	Stas 63.00	11 APR	4.00	10/1/19	6/1/19
2 FEB	0.10	Stas 64.00	12 APR	4.00	11/1/19	7/1/19
2 FEB	0.10	Stas 65.00	13 APR	4.00	12/1/19	8/1/19
2 FEB	0.10	Stas 66.00	14 APR	4.00	13/1/19	9/1/19
2 FEB	0.10	Stas 67.00	15 APR	4.00	14/1/19	10/1/19
2 FEB	0.10	Stas 68.00	16 APR	4.00	15/1/19	11/1/19
2 FEB	0.10	Stas 69.00	17 APR	4.00	16/1/19	12/1/19
2 FEB	0.10	Stas 70.00	18 APR	4.00	17/1/19	13/1/19
2 FEB	0.10	Stas 71.00	19 APR	4.00	18/1/19	14/1/19
2 FEB	0.10	Stas 72.00	20 APR	4.00	19/1/19	15/1/19
2 FEB	0.10	Stas 73.00	21 APR	4.00	20/1/19	16/1/19
2 FEB	0.10	Stas 74.00	22 APR	4.00	21/1/19	17/1/19
2 FEB	0.10	Stas 75.00	23 APR	4.00	22/1/19	18/1/19
2 FEB	0.10	Stas 76.00	24 APR	4.00	23/1/19	19/1/19
2 FEB	0.10	Stas 77.00	25 APR	4.00	24/1/19	20/1/19
2 FEB	0.10	Stas 78.00	26 APR	4.00	25/1/19	21/1/19
2 FEB	0.10	Stas 79.00	27 APR	4.00	26/1/19	22/1/19
2 FEB	0.10	Stas 80.00	28 APR	4.00	27/1/19	23/1/19
2 FEB	0.10	Stas 81.00	29 APR	4.00	28/1/19	24/1/19
2 FEB	0.10	Stas 82.00	30 APR	4.00	29/1/19	25/1/19
2 FEB	0.10	Stas 83.00	1 MAY	4.00	30/1/19	26/1/19
2 FEB	0.10	Stas 84.00	2 MAY	4.00	31/1/19	27/1/19
2 FEB	0.10	Stas 85.00	3 MAY	4.00	1/2/19	28/1/19
2 FEB	0.10	Stas 86.00	4 MAY	4.00	2/2/19	29/1/19
2 FEB	0.10	Stas 87.00	5 MAY	4.00	3/2/19	30/1/19
2 FEB	0.10	Stas 88.00	6 MAY	4.00	4/2/19	31/1/19
2 FEB	0.10	Stas 89.00	7 MAY	4.00	5/2/19	1/2/19
2 FEB	0.10	Stas 90.00	8 MAY	4.00	6/2/19	2/2/19
2 FEB	0.10	Stas 91.00	9 MAY	4.00	7/2/19	3/2/19
2 FEB	0.10	Stas 92.00	10 MAY	4.00	8/2/19	4/2/19
2 FEB	0.10	Stas 93.00	11 MAY	4.00	9/2/19	5/2/19
2 FEB	0.10	Stas 94.00	12 MAY	4.00	10/2/19	6/2/19
2 FEB	0.10	Stas 95.00	13 MAY	4.00	11/2/19	7/2/19
2 FEB	0.10	Stas 96.00	14 MAY	4.00	12/2/19	8/2/19
2 FEB	0.10	Stas 97.00	15 MAY	4.00	13/2/19	9/2/19
2 FEB	0.10	Stas 98.00	16 MAY	4.00	14/2/19	10/2/19
2 FEB	0.10	Stas 99.00	17 MAY	4.00	15/2/19	11/2/19
2 FEB	0.10	Stas 100.00	18 MAY	4.00	16/2/19	12/2/19
2 FEB	0.10	Stas 101.00	19 MAY	4.00	17/2/19	13/2/19
2 FEB	0.10	Stas 102.00	20 MAY	4.00	18/2/19	14/2/19
2 FEB	0.10	Stas 103.00	21 MAY	4.00	19/2/19	15/2/19
2 FEB	0.10	Stas 104.00	22 MAY	4.00	20/2/19	16/2/19
2 FEB	0.10	Stas 105.00	23 MAY	4.00	21/2/19	17/2/19
2 FEB	0.10	Stas 106.00	24 MAY	4.00	22/2/19	18/2/19
2 FEB	0.10	Stas 107.00	25 MAY	4.00	23/2/19	19/2/19
2 FEB	0.10	Stas 108.00	26 MAY	4.00	24/2/19	20/2/19
2 FEB	0.10	Stas 109.00	27 MAY	4.00	25/2/19	21/2/19
2 FEB	0.10	Stas 110.00	28 MAY	4.00	26/2/19	22/2/19
2 FEB	0.10	Stas 111.00	29 MAY	4.00	27/2/19	23/2/19
2 FEB	0.10	Stas 112.00	30 MAY	4.00	28/2/19	24/2/19
2 FEB	0.10	Stas 113.00	31 MAY	4.00	29/2/19	25/2/19
2 FEB	0.10	Stas 114.00	1 JUN	4.00	30/2/19	26/2/19
2 FEB	0.10	Stas 115.00	2 JUN	4.00	31/2/19	27/2/19
2 FEB	0.10	Stas 116.00	3 JUN	4.00	1/3/19	28/2/19
2 FEB	0.10	Stas 117.00	4 JUN	4.00	2/3/19	29/2/19
2 FEB	0.10	Stas 118.00	5 JUN	4.00	3/3/19	30/2/19
2 FEB	0.10	Stas 119.00	6 JUN	4.00	4/3/19	31/2/19
2 FEB	0.10	Stas 120.00	7 JUN	4.00	5/3/19	1/3/19
2 FEB	0.10	Stas 121.00	8 JUN	4.00	6/3/19	2/3/19
2 FEB	0.10	Stas 122.00	9 JUN	4.00	7/3/19	3/3/19
2 FEB	0.10	Stas 123.00	10 JUN	4.00	8/3/19	4/3/19
2 FEB	0.10	Stas 124.00	11 JUN	4.00	9/3/19	5/3/19
2 FEB	0.10	Stas 125.00	12 JUN	4.00	10/3/19	6/3/19
2 FEB	0.10	Stas 126.00	13 JUN	4.00	11/3/19	7/3/19
2 FEB	0.10	Stas 127.00	14 JUN	4.00	12/3/19	8/3/19
2 FEB	0.10	Stas 128.00	15 JUN	4.00	13/3/19	9/3/19
2 FEB	0.10	Stas 129.00	16 JUN	4.00	14/3/19	10/3/19
2 FEB	0.10	Stas 130.00	17 JUN	4.00	15/3/19	11/3/19
2 FEB	0.10	Stas 131.00	18 JUN	4.00	16/3/19	12/3/19
2 FEB	0.10	Stas 132.00	19 JUN	4.00	17/3/19	13/3/19
2 FEB	0.10	Stas 133.00	20 JUN	4.00	18/3/19	14/3/19
2 FEB	0.10	Stas 134.00	21 JUN	4.00	19/3/19	15/3/19
2 FEB	0.10	Stas 135.00	22 JUN	4.00	20/3/19	16/3/19
2 FEB	0.10	Stas 136.00	23 JUN	4.00	21/3/19	17/3/19
2 FEB	0.10	Stas 137.00	24 JUN	4.00	22/3/19	18/3/19
2 FEB	0.10	Stas 138.00	25 JUN	4.00	23/3/19	19/3/19
2 FEB	0.10	Stas 139.00	26 JUN	4.00	24/3/19	20/3/19
2 FEB	0.10	Stas 140.00	27 JUN	4.00	25/3/19	21/3/19
2 FEB	0.10	Stas 141.00	28 JUN	4.00	26/3/19	22/3/19
2 FEB	0.10	Stas 142.00	29 JUN	4.00	27/3/19	23/3/19
2 FEB	0.10	Stas 143.00	30 JUN	4.00	28/3/19	24/3/19
2 FEB	0.10	Stas 144.00	1 JUL	4.00	29/3/19	25/3/19
2 FEB	0.10	Stas 145.00	2 JUL	4.00	30/3/19	26/3/19
2 FEB	0.10	Stas 146.00	3 JUL	4.00	31/3/19	27/3/19
2 FEB	0.10	Stas 147.00	4 JUL	4.00	1/4/19	28/3/19
2 FEB	0.10	Stas 148.00	5 JUL	4.00	2/4/19	29/3/19
2 FEB	0.10	Stas 149.00	6 JUL	4.00	3/4/19	30/3/19
2 FEB	0.10	Stas 150.00	7 JUL	4.00	4/4/19	31

32 W.C.
0.10

20 W.C.
1.55

25 W.C.
2.65

NO. 01.
2.05 2.19 2.02

Sta 10+00
E. at 96.10

Sta 11+00
E. at 96.11

Sta 12+00
E. at 96.12

12+92
Sta 13+00

42 W.C.
11.19

62 W.C.
6.50

72 W.C.
5.50

32 W.C.
7.05

117 E.B.
1.20

117 E.B.
0.40

112 E.B.
1.50

24 E.B.
4.81

10157A

10157A

78.50
2.40
76.10
98.50
1.56
76.94

2.10
4.64
10157A

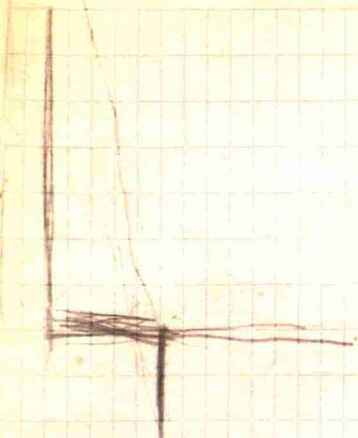

26

Sam Project

Levels N. from

Stat. 12 -

Elev. 13 -	20' W. 300 B (C.B)	96.60
B.M. 12+95 -	E. post, wire fence	94.48
B.M. 13+05	S. 0M ² E. post	94.44
Sta. 14 -	10' bed -	88.82
Sta. 5 -	E. edge water	90.10
" 15 -	Center Bed -	88.42
" 16+30	E. Edge water -	99.00
" 13+30	Center Bed -	89.50
" 15+50	⊙ (about 1/2 way up bank)	94.20
Elev. 16+20 -	E. bank in field	96.88
17+30	" " "	96.60
18+30	" " "	96.55
19+20	" " "	97.40
B.M. -	Top level of water to stream	102.80
	at 1/2 cor. bridge -	
19+50 -	level crest	104.02
15+50	East crest	101.50
15+50	West crest	100.70
14+50	" crest	96.50

27

Ditch For Ed Blair - Chas. Roark et al Wash. Tp.

Sta.	El. Stake	El. Ground	Pres. 2.8	Bot. N.D
El. Gr. 10' N. sewer		1.00		
1	1.90	1.54		0.00
1	2.23	1.87		0.17
2	2.39	2.20		0.33
3	3.15	2.82		0.50
4	3.62	3.32		0.67
		1.40		0.83
5	4.25	3.64	1.62	0.83
6	4.77	4.34	1.97	1.00
7	5.15	4.56	2.45	1.16
8	5.02	4.69	2.54	1.33
9	5.18	3.93	3.02	1.50
10	5.91	5.23	3.13	1.67
	5.23	5.50	3.55	
11	6.02	5.49	3.55	1.83
12	6.13	5.45	3.77	2.00
13	6.45	5.55	4.35	2.16
14	5.97	6.14	4.68	2.33
15	7.10	6.52	5.30	2.50
16	8.17	8.00		2.67
17	8.38	8.25		2.83
* 18	10.55	6.	6.55	3.00
19	9.10		7.42	3.16
20	9.17		7.92	

Make ele. outlet.

B.M. 2nd fence post W. tel. pole sta. 0+00
El. top 6.75

Bottom present open ditch app. sta. 4+00

© 5.45

3.47 B.M. Top white 100' 00" - bottom 990 10"
Crossed to W. of open ditch at 10+50

6" enters here

B.M. E. end S. rail bridge at sta. 18 - El. 18.59
18+43 - stake 11.29 ditch - 6.36
X 18+00 - S. side Rockville road -
16" to 18+00 - possibly 14"

30

	El. Stake	Ground	Bot. Ditch
21	9.70		8.12
22	10.10		8.24
23	10.90	10.68	
24	10.68	10.79	8.92
25	12.00		9.53
26	10.96	9.85	
27	11.35	11.05	
28	11.79	11.26	
29	11.56		10.72
30	12.79	12.40	
31	12.21		11.37
32	13.10	12.40	
33	13.35	12.92	
x 34	13.51	13.10	
35	13.82	13.42	
36	13.69	13.40	
37	13.90	13.73	
38	14.40		13.56
39	14.18		13.06
40	14.63		13.29
41	14.22		14.24
42	14.72		14.18
43	15.80		15.55
44	16.19		15.82
45	16.84		16.48

Cut of

10.20

11.70

12.40

11.50

11.30

9.53

N. + S. line fence - Rock - Bluff.

x Pond 120' SE from 34 - El. 11.80

12" to 40 + 50

↓ E. W. wood fence 40 + 50

↓ Leave wood 44 + 65

31

Station	Stake	Ground	Ditch
46	16.32		14.82
47	16.69		15.20
48	17.08		15.53
49	17.95		15.15
50	17.80		16.30
51	18.69		16.40
52	18.91		16.42
53	18.88		16.70
54	18.39		16.65
* 55	18.05		17.75
Arm. 56	18.50		15.14
57	18.27		16.38
58	18.95		16.55
59	18.35		16.94
60	19.26		17.11
61	19.05		17.20
62	18.57		17.40

B.M. 19.95 14" ash stump
opp. sta. 58-70' N.

Arm. 622.05 48+70

33

* 10" on main to sta. 55+00

*) About -60 A comes into ^{sta} 55+00

55 is last stake on main

*) 56 is sta. 1 of arm.

8" on arm- 7" enters at
head.

34 Estimate Rosok-Blair Drain

1800' - 16" @ 35¢ =	630.00
2250' - 12" @ 15¢ =	342.75
1450' - 10" @ 13¢ =	188.50
<u>700' - 8" @ 9¢ =</u>	<u>66.50</u>
620.0	1233.75
Hauling @ 2¢	75.00
Digging, laying & covering	
③ 20¢ per 100'	= 1240.00
Header	50.00
Connections -	20.00
	<u>2618.75</u>
Profit 10%	262.
	\$ 2880.00

Private Ditch for

Harry Dickerson.

Sta.	El. stake	El. grab	
0	4.38	3.50	45.91.94
1	7.77	4.67	27.00 NW. cor. pond.
2	9.81	5.83	
3	12.11	7.00	
4	16.05	9.87	E. edge of N.Y.S. road.
5	15.65	12.65	
6	17.70	14.73	
7	19.85	15.80	
8	22.30	17.37	
9	23.00	18.95	
10	23.84	19.28	
11	24.05	19.67	
12	24.35	19.95	
13	24.55	20.28	
14	24.10	20.67	
15	23.95	20.95	
16	25.10	21.46	
17	24.70	21.98	
18	26.82	22.49	
19	26.33	23.00	pond.
20	27.76	23.42	27.25 Pond.
21	28.20	23.84	
22	28.65	24.25	
23	28.90	24.67	
24	29.64	25.08	
25	29.94	25.50	
26	-	25.75	

0.00
0.00
0.00

stood on bank of branch - a' down.
 . Eed of stream is 5.00
 > 28.00 probable low pt. in pond.
 #16. dip N. pond - 105' to N.Y.S.
 Fence W. of pond.
 5 + 10 E + W fence

9-40 N.Y.S. fence between fields
 50' N of 20 + 40 26.50 deepest pt.

38

Bridge at

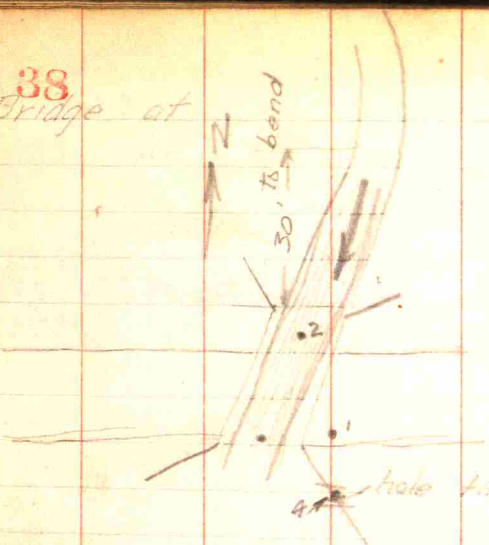

3-24-20

12' span

6' skew

hole thru wing

	B. S.	H. I.	F. S.	Elev
B.M.	2.97			
	160.00			
		102.97		
1			4.51	97.36
2			9.86	92.51
3			9.72	92.75
4			7.92	94.55

$$\begin{array}{r} 99.86 \\ 77.57 \\ \hline 43.5 \end{array}$$

$$\begin{array}{r} 6' \text{ rise} \\ 1.14 \\ 7.26 \\ \hline 42.57 \\ 99.86 \end{array}$$

39

Highest point on top large post S.W. of bridge

pt. 1 as shown - Raise floor ~~1.14~~ above this point

pt. 2 " " Bottom of stream N. side

" 3 " " " " S "

" 4 " " " tile thru wing

99.67 = elevation of top of bridge

40

Bridge just E. of ...
Measured for new floor

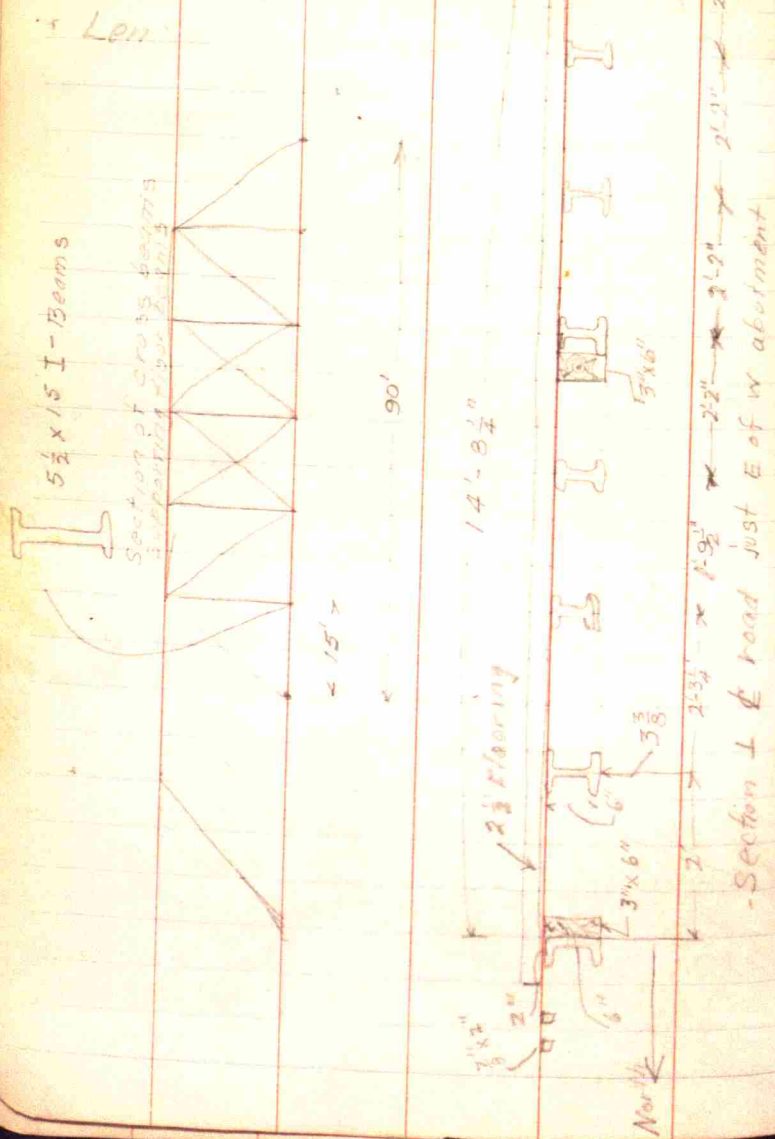

All channels & I-beams badly in need of paint.
Longitudinal stringers project back 6" beyond lower
connecting pins of end posts at each end.

3 1/2
9 1/2
3 1/2
10 1/2

41

42

Investigation of Russell Rock

Station 38493 on E bank of
river

43

Aug 5-19

Crossed River