

E. M. McCoun Ditch

J. T. Barnett Ditch

85

CROSS SECTION BOOK

375 S

E.M. McCoun et al  
Ex Parte Drain

Req. in Highway at S.  
end Sec. 32 and running  
thence N on said Highway  
to the S.E. cor. of NE 4 Sec  
31. Thence N. approx 20- or 30  
rods. Thence N.W. to a  
point where said drain  
will empty into a large open  
ditch.

Petitioners

E.M. McCoun  
E.W. Skinsley  
John E. Call  
J. F. Cline

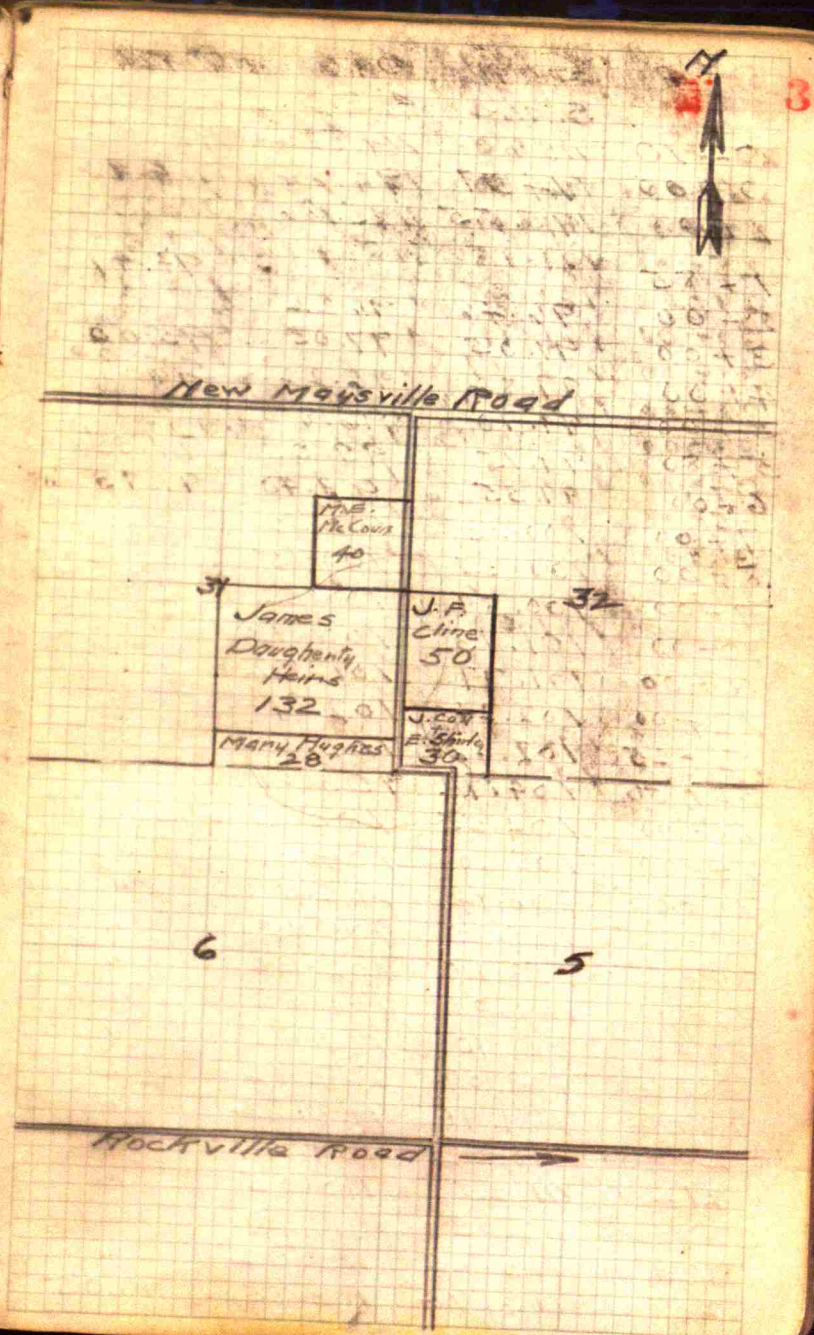

Sta	Grade	On Ground	Ditch
0-10			
0+00	94.77	94.66	92.86
1+00	95.35	95.66	
1+85			94.47
2+00	96.46	96.22	
3+00	97.05	77.05	95.00
4+00	97.82	96.22	Same
5+00	99.10	96.83	"
5+30	99.15	99.05	97.50 (9' W)
6+00	99.55	99.40	97.73 "
7+00	100.33	100.52	
8+00	100.35	100.15	
9+00	100.39	100.52	
10+00	101.13	100.93	
11+00	101.77	101.52	
12+00	102.24	102.31	
12+25	102.46	102.72	
12+50	104.72	103.61	
13+00	104.55	103.60	Same
14+00	105.60	104.37	"
15+00	106.94	105.11	"
15+50	108.25	105.95	"
15+75	108.20	106.30	"
16+00	108.07	106.68	"
17+00	108.90	107.45	"
18+00	109.07	107.92	"
19+00	109.70	108.62	"
20+00	110.82	109.47	"
21+00	111.25	110.05	"
22+00	112.05	111.20	"
23+00	113.25	112.02	"
24+00	113.76	113.85	113.05

BM ①  
 El. 100.00 Hollow Stump  
 35' NW Sta 0+00

In Stream at point where Open  
 Ditch joins from W.

3' N. St

Pt. where fire ends

Willows Sta 6+80 to be removed  
 Ditch crosses Rail Flat at 6+30

Ditch Curves to E from S30E  
 from Sta 12+00 to 13+00 and  
 crosses Daugherty S. line fence  
 Sta 12+50.

Ditch Curves to N from 15+50  
 to 16+00 and crosses Daugherty  
 E. fence Sta 15+75 - 30' N of 5' line

② BM El. 109.16

W. Marker Culvert Sta. 15+75

6

St. Grade & Est. Ditch  
Stake Bottom

25+00	115.60	114.82	→ Same
26+00	116.50	115.40	114.97
27+00	119.05	116.90	115.75
28+00	121.18	118.47	117.70
29+00	120.48	120.50	118.90
30+00	121.71	121.24	120.84
31+00	122.97	122.30	122.00
32+00	125.89	124.22	123.40
33+00	128.27	126.75	126.63
34+00	130.12	129.51	→ Same
35+00	131.65	130.17	130.74
36+00	136.05	131.76	→ Same
37+00	137.36	136.52	→ "
38+00	139.57	138.45	"
39+00	142.10	140.45	"
40+00	144.58	142.39	141.52
41+00	145.04	143.97	143.26
42+00	148.42	147.85	146.16

Bench Marks Checked as follows

0139.75	
0130.03	
0128.12	
0120.55	B.M. No 3
0113.37	
0109.16	
0105.57	B.M. No 2
0100.75	
0100.05	B.M. No 1.

7

Willows in field Sta 30+00 to  
be removed

B.M. ③ El 128.12 ✓  
N. Gate Post E side Sta. 31+10

End of Drain  
B.M. No ④  
El-150.31 1 1/4" Round Post 30' W of  
Sta 41+20

Sta	Ga St.	4' 5"	
5+80 on			
0+00	99.15	99.15	
1+00	99.93	99.91	
2+00	102.63	102.33	
3+00	103.60	103.42	
4+00	105.30	104.10	Ditch
5+00	105.95	105.25	"
6+00	106.95	106.70	"
7+00	108.30	107.76	"
8+00	110.72	109.95	"

Lateral "A"

9

Begin at Sta 5+80 on Main  
ditch run S 60° W 200'. Then  
S 45° W 300'. Thence S 30° W 100'  
Thence S 20°

B.M. El. 105.15

Fence Post 12" Round at Top and  
8" Round at Bottom - 15' SW. Sta  
8+00

This lateral drains  
approx 45 Acres

14 Levels for J. D. Brickert to  
determine Outlet for Pond

101.92

EI. Top 4" Tile

N.W. Con. J. D. Brickert  
Farm

106.96

5750 E 100'

108.85

" " E 200'

109.40 → " " " 300'

110.02 " " " 400'

108.10 " " " 500'

107.65 " " " 600'

107.85 " " " 700'

106.00 " " " 800'

105.80 " " " 865' Low pt. pond

1071.00 " " " 900'

105.80

Low pt. pond

107.25

N 60 E of Pond 100'

107.90

" " " " " 200'

109.00

" " " " " 300'

108.10

" " " " " 400'

109.30

" " " " " 500'

109.80

" " " " " 600'

109.40

" " " " " 700'

104.00

" " " " " 800'

This last elevation is flow line of 8" tile.

15

Bag at 4" tile.

This line of levels from NW. con. J. D. Brickert farm in a SW direction to pond show that pond can be drained satisfactorily in this direction.

THIS line of levels from pond to the N.E. under R.R. show that pond can not be drained satisfactorily in this direction.

C. Wisler

C. D. Warden R.N. M. L. S.

E. Big X E. B. X

J. H. N. E. S. Moon & Douglas X

G. O. S. H. von

R. L. Cost aton

J. M. X R. K. Paper

J. M. Brown Brown

Joan

Thad Teller

Need

Wm. Lacey

H. D. Crews

L. R. Crews

H. D. Crews

L. R. Crews

G. O. S. H. von

R. L. Cost aton

J. M. X R. K. Paper

J. M. Brown Brown

st

M. L. Dewesse

Hoffend Hillford

G. E. Carlsberg

L. T. ...

J. T. Ho ...

May ...

F. Sims

V. P. Reeves

V. R. Reeves

V. R. Reeves

V. R. Reeves

V. R. Reeves

V. R. Reeves

V. R. Reeves

V. R. Reeves

V. R. Reeves

V. R. Reeves

V. R. Reeves

V. R. Reeves

V. R. Reeves

V. R. Reeves

V. R. Reeves

V. R. Reeves

Rev. Williams

School

st

st

Harrison H. Hufford

21

Bench Marks

- (E) No. 1. Center E. Rail Culvt.  
over Avon St. El. 100.00
- (E) No. 2. Cen W Rail same  
45' SW of No. 1 El. 99.90
- (D) No. 3 Cen. E. Rail Culvt on  
School St. 621' (WN No. 2) 94.90
- (D) No. 4 Cen W. Rail same  
36' W. of No. 3 94.90
- (C) No. 5 Cen E. Rail Culvt on  
Vine St. 255' (WN No. 4) El. 93.25  
Span 10' Rise 2'
- (C) No. 6 Cen W. Rail same  
52' W. of (No. 5) El. 93.51
- (B) No. 7 Cen E Rail Culvt on  
Cen St. 258' (WN No. 6) 94.85
- (B) No. 8 Cen W Rail same  
52' W of (No. 7) 94.71

et al Ex Parte Drain

25

- 94.52 Bed 240' N.E. (No. 1)
- 93.11 Bed at (No. 1)
- 93.69 Geo. Longmire basement 100' N. (No. 6)
- 92.95 Bed at (No. 2) @ 98.29
- 88.75 Bed at (No. 3)
- 88.52 Bed at (No. 4)
- 87.74 Bed at (No. 5)
- 87.74 Bed at (No. 6)
- 87.01 Bed at (No. 7)
- 86.85 Bed at (No. 8)



26  
Ⓐ No 9. Cen E Rail Culvt  
on Mill St. 257' (W. No 8) 91.64

Ⓐ No 10 Cen W. Rail Same  
60' W. No. 9 91.56

785' W. of No 9 Branch  
Deflects Left 60°. El 78.10

At 900' W No 9 Branch  
deflects 20° Left

Total distance along old  
channel from No 10 to  
Mouth 1268'

Total dist from No 9  
St. line to creek 200'

27  
85.10 Bed at No 9

85.30 Bed at No 10

⊙ 88.52

83.15 Bed 300' W. No 10

⊙ 81.96

79.80 Bed 600' W No 10

77.90 Bed 900' W No 10

75.90 Bed 1000' W No 10

74.97 " 1100' W. No 10

73.56 " 1200' W No 10

82.52 High W. Mark

72.80 <sup>7L</sup> Bed White Lick Creek

73.20 7L on St. Route to Creek

Transit Notes

Sta 11+00 W. end Mill  
 From Sta. 0+00 to 11+00  
 Span 18' Pres. Rise 3'  
 Def L 56.15'

Sta 11+60 E end Same.  
 Def R 2° 51'

Sta 14+16 - W end Str B  
 10' Span 3.5' Rise

Sta 14+68 - E end Str B.  
 Def L 4° 8'

Sta 17+25 W end Str C

Sta 17+77 E end Str. C.  
 Def R 33'

Sta 20+36 W end Str D  
 Rise 2.8' Span 9.6'

Sta 20+78 E end Str D  
 Def L 15'

Sta 26+95 W end Str E

Sta 27+40 E end Str E  
 Def L 10° 0'

~~Sta 29+80 End Improvement~~

Sta 30+50 End

Hufford Drain

Street Bridge  
 Stakes are 18' S of Cen. Line  
 Sta 3+25 Def R 46° 37'

From Sta 11+60 to 29+80  
 Stakes are 12' S. Cen line  
 Sta 25+80 Def L 16° 20'

Str. E. 10' Span 3.5' Rise

## Levels Hutford

Sta	Stake				
0+00	78.16	①	77.35	⑱	77.30
1+00	80.40	②	80.23	⑲	80.30
2+00	80.80	③	80.56	⑳	79.26
3+00	81.80	④	81.08	㉑	79.15
3+50	81.90	⑤	81.89	㉒	78.46
4+00	82.04	⑥	82.73	㉓	79.45
5+00	85.10	⑦	83.72	㉔	83.78
6+00	88.41	⑧	87.93	㉕	85.17
7+00	87.53	⑨	87.32	㉖	85.90
8+00	88.50	⑩	86.73	㉗	85.63
9+00	88.60	⑪	88.62	㉘	87.10
10+00	88.06	⑫	88.25	㉙	87.60
11+00	88.87	⑬	88.65	㉚	86.40
11+60	88.80	⑭	86.90	㉛	85.60
12+00	89.35	⑮	88.90	㉜	85.56
13+00	90.16	⑯	88.73	㉝	87.45
14+00	91.37	⑰	90.90	㉞	88.80
15+00	90.79	⑱	90.43	㉟	87.46
16+00	90.00	㊱	89.70	㊲	87.54
17+00	90.40	㊳	90.18	㊴	87.85
18+00	91.02	㊵	90.76	㊶	88.75
19+00	91.80	㊷	90.90	㊸	88.85
20+00	91.38	㊹	91.30	㊹	89.00
21+00	92.27	㊺	91.76	㊺	89.24
22+00	92.79	㊻	91.42	㊻	90.04
23+00	93.52	㊼	92.30	㊼	90.80
24+00	94.22	㊽	92.72	㊽	92.25
25+00	94.66	㊾	94.10	㊾	91.06
26+00	95.07	㊿	93.45	㊿	91.21

Diam

93.60
88.55
5.05

54c. stump
80' 1150/1+00
0
83.52

⑳	77.30				
㉑	80.39				
㉒	77.88	㉓	77.45	㉔	80.76
㉕	80.20	㉖	79.20	㉗	79.80
㉘	80.44			㉙	82.00
㉚	80.25	㉛	82.90	㉜	83.00
㉝	81.09	㉞	81.10	㉟	84.10
㊱	84.52	㊲	82.04	㊳	81.90
㊴	84.45	㊵	82.80	㊶	83.72
㊷		㊸	83.15	㊹	85.15
㊺		㊻		㊼	91.68
㊽	85.65	㊾	84.20	㊿	84.15
㋀	85.70				30 85.70
㋁	87.18	㋂	86.33	㋃	84.05
㋄	86.40	㋅	84.80	㋆	84.65
㋇	85.53	㋈	85.70	㋉	89.18
㋊	85.60	㋋	86.90	㋌	89.18
㋍	85.60	㋎	89.20	㋏	89.80
㋐	85.85	㋑	85.90	㋒	87.80
㋓	87.32	㋔	87.20	㋕	89.05
㋖	86.86	㋗	88.50	㋘	88.96
㋙	87.66	㋚	89.85	㋛	90.30
㋜	88.10	㋝	89.70	㋞	90.10
㋟	88.30	㋠	90.16		
㋡	88.70	㋢	89.90	㋣	90.20
㋤	88.55	㋥	90.56	㋦	91.90
㋧	88.86	㋨	89.25	㋩	90.16
㋪	89.10	㋫	92.52	㋬	92.45
㋭	89.82	㋮	89.93	㋯	92.02
㋰	91.00	㋱	90.20	㋲	90.30
㋳	90.75	㋴	93.46	㋵	94.50
㋶	91.30	㋷	93.65	㋸	95.47
		㋹		㋺	94.35

73.36

FL. AT 0+00

No. 8 → 94.79

No. 7 → 94.90

No. 6 → 93.59

No. 5 → 93.35

No. 2 → 94.97

No. 3 → 94.97

Sta

26+95 95.50 (8) 93.20  
 27+40 96.10 (8) 93.15  
 28+00 96.71 (4) 95.00 (9) 93.52  
 29+00 94.58 (8) 94.90  
 30+00 99.21 4 99.92  
 30+50 97.27 (4) 97.58 (9) 96.80

El. Gd N. side May Stewart Res. Mill St. 89.60  
 " " S " E. Mooney Res Mill St. 90.20  
 " " N " Green Res Center St 90.15  
 " " N " Robertson " " 90.80  
 " " N " Hollingsworth " " 91.10  
 " Side Ditch front Marley Res " 91.30  
 " " " 50' N. Mo B 89.79  
 " " " " " 7 88.93  
 " " 3rd House S.W. side Vine 91.00  
 " " Ditch E. side 500' N. on Vine 91.00  
 " N side Bryant Res E. side Vine 5 90.53  
 Sta 197+20 Outlet 16" Tile from

(17) 93.48 (24) 97.05 (102) 99.94  
 (17) 93.30 (24) 94.75 (101) 100.05  
 (3) 93.72 (18) 95.02 (24) 95.70  
 (14) 98.02 (24) 96.75  
 (8) 99.20 (10) 94.86 (17) 95.15 (24) 96.50  
 (10) 95.00 (14) 94.90 (24) 96.80

→ } Tile under Lincoln to Ditch from these points

N El. Top.

Str (A)

Span 12'

Rise above Footings 38'

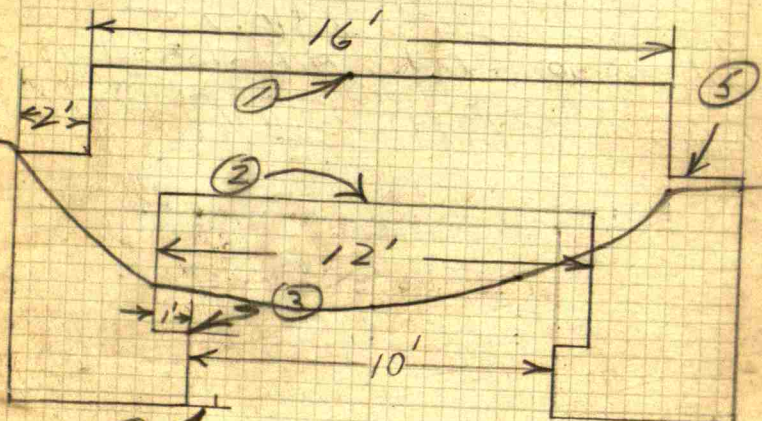

End El. Str A' West

El. ① 91.68

② 88.30

③ 84.50

④ 82.59

⑤ 89.39

Soil at bottom Footings Gravel

Str C. Span 10'

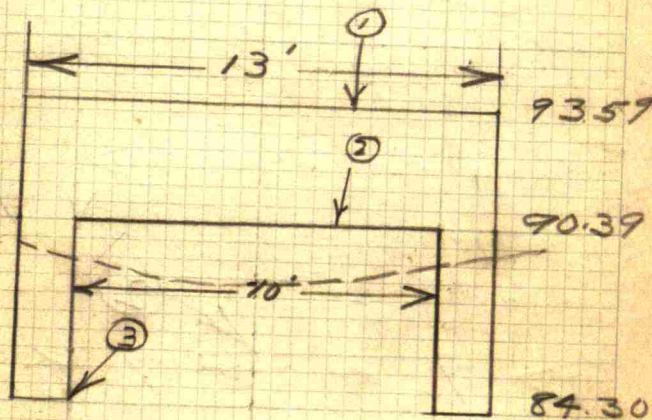

Abutments faced to bottom  
Soil at bottom Gravel  
" 86.74 to 84.50 Clay

1. 93.59

2. 90.39

3. 84.30

Sta (D)

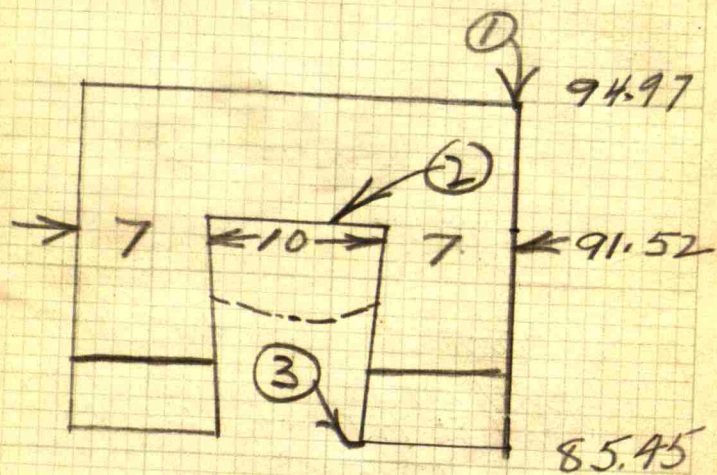

1 94.97

2 91.52

3 85.45

Soil Bot Footings 10 y

Cent S SE 17 is 130' S of Ditch  
SW con Sec. 16 is 332' S

Cent S SE 17 is 115' E of E

Chas Rutledge NE cor + is 700'  
Open Ditch empties from N.W. at.  
Chas Rutledge NE cor is 150' S of  
Open ditch empties from E. Sta  
C.L. Thompson NW con is 725' W  
Sta 64+00 crosses Road 200' E  
Sta 4 is 766' E of Cent  
Cent N NW 1/4 Sec. 15 is 230' W still  
Sta C Sta 105+00 30' Anch

Ditch turns E Sta 23+90 along N

Sta 174 is 769' S of Cent N NE

Sta 183+25 is 300' W of " " "

Barnett

Sta A 16+36  
and 15' W of Sta 0+00

Ditch Sta A 14+80

E of Sta 68+80

Sta 27+00

4 Ditch Sta 37+00

50+80

of Ditch Sta 50+80

and 200' S of Cent NE 1/4 Sec 16

NE 1/4 Sec 16

and 80' N of Ditch Sta 103+00

side RR to Sta

Sec 10

"

Ditch

## Barnett Ditch

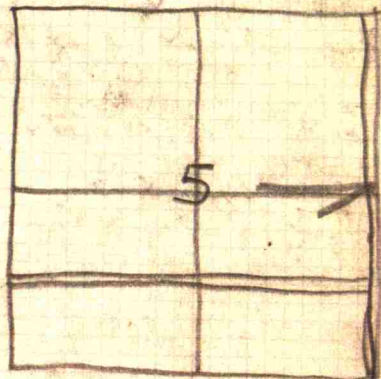

43  
 Cen Sec 4 is 155' S of  
 Q pt Sta 260+10

Cen SE<sup>A</sup> Sec 5 is 660' Nord  
 200' W of Sta 304+40

Cen W. Cen<sup>Sec 4</sup> is 20' S of Ditch

Cen SE<sup>A</sup> Sec 4 is 265' S of Ditch  
 Sta 238+00

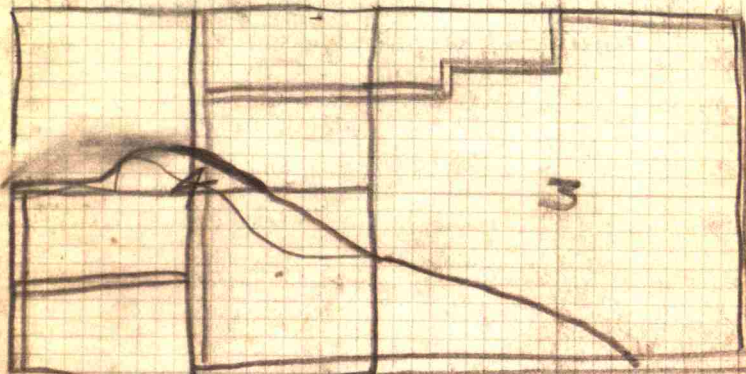

Cen Sec 4 16 270' W of Ditch



48 Sta	S 10'S St	State	S	S	Bed at S edge
0+00	25 94.75	15' 9184			10' 89.95
1+00	26 94.95	16 9527			7 90.13
2+00	23 94.70	13 9503			6 90.10
3+00	31 93.44	21.51 93.51			13 90.10
4+00	27 96.37	17 93.76			8 90.36
5+00	24 100.50	14 96.76			6 90.40
6+00	20 97.42	10 94.55			6 90.63
8+00	23 101.00	13 98.06			9 91.40
8+00	23 98.10	13 94.21			8 91.60
9+00	24 99.75	14 96.70			9 91.70
10+00	27 96.75	17 95.45			9 91.60
11+00	28 96.60	18 96.10			10 91.90
12+00	30 96.48	20 95.09			8 91.65
13+00	28 95.24	18 94.88			8 92.18
14+00	26 97.02	16 96.95			10 92.00
15+00	24 96.68	14 96.55			8 92.06
16+00	26 97.10	16 97.26			9 92.04
17+00	26 96.50	16 95.82			6 92.00
18+00	32 97.20	22 97.41			8 92.86
19+00	28 97.55	18 96.00			7 92.30
20+00	28 102.16	18 98.16			7 93.75
21+00	25 101.00	15 96.29			10 93.26

Barometer Level

Cell Line	Bed at E Hedge	N	N	B.M. No
8966	8' 90.00	16' 92.05	26' 93.80	49
89.87	8' 87.60	16' 96.00	26' 95.90	SE Wing
8863	8' 89.30	13' 94.32	23' 94.39	Arch 0700
9095	10' 91.65	21' 94.21	31' 95.60	EI. 100.00
89.81	7' 90.32	11' 94.86	21' 95.40	Sta A 30' Arch
89.85	6' 90.06	13' 93.60	23' 95.35	
89.98	6' 90.66	14' 95.50	24' 95.50	
91.30	9' 92.22	13' 94.37	25' 95.56	
90.10	8' 90.40	12' 94.80	22' 95.90	
90.60	6' 91.40	12' 94.50	22' 96.00	
91.00	7' 90.76	12' 95.36	22' 96.70	
92.07	10' 91.70	15' 94.80	25' 95.85	
91.73	8' 91.66	13' 96.50	23' 97.00	
91.55	8' 92.12	14' 97.02	24' 97.00	
91.70	10' 92.45	15' 94.15	25' 96.15	
90.40	8' 90.90	13' 95.45	23' 97.13	
90.56	7' 91.00	14' 95.76	24' 97.85	
90.62	6' 90.65	11' 97.40	21' 98.00	
91.86	8' 91.86	13' 93.16	23' 98.60	
91.35	7' 92.66	12' 93.95	22' 97.45	
92.59	7' 93.25	12' 95.60	22' 97.45	
91.65	10' 92.70	15' 95.72	25' 98.30	

Sta	10's St	10's St	10's St	CL	Bed No.
22+00	9812	98 <sup>16</sup> 12	93 <sup>12</sup> 75	9285	93830
23+00	9922	99 <sup>20</sup> 22	92 <sup>12</sup> 60	9256	9310
24+00	9923	98 <sup>8</sup> 81	93 <sup>7</sup> 50	9241	9300
25+00	9756	98 <sup>20</sup> 60	93 <sup>8</sup> 80	9276	9340
26+00	9909	98 <sup>20</sup> 70	93 <sup>9</sup> 90	9335	9395
27+00	9995	98 <sup>23</sup> 19	93 <sup>11</sup> 95	9367	9476
28+00	9940	99 <sup>20</sup> 04	94 <sup>10</sup> 00	9356	9390
29+00	9895	99 <sup>20</sup> 00	93 <sup>9</sup> 96	9290	9350
30+00	9920	97 <sup>26</sup> 80	94 <sup>8</sup> 32	9332	9480
31+00	9937	99 <sup>20</sup> 10	94 <sup>3</sup> 72	9391	9423
32+00	10315	103 <sup>22</sup> 36	94 <sup>8</sup> 19	9270	9390
33+00	9855	97 <sup>22</sup> 36	94 <sup>7</sup> 30	9340	9450
34+00	9945	99 <sup>19</sup> 18	94 <sup>11</sup> 40	9490	9376
35+00	10095	101 <sup>20</sup> 30	94 <sup>15</sup> 95	9240	9470
36+00	9976	99 <sup>25</sup> 01	94 <sup>8</sup> 00	9490	9465
37+00	10055	101 <sup>19</sup> 25	94 <sup>11</sup> 40	9440	9500
38+00	9760	97 <sup>15</sup> 90	94 <sup>8</sup> 14	9410	9480
39+00	10010	98 <sup>18</sup> 70	94 <sup>5</sup> 80	9390	9480
40+00	10152	101 <sup>16</sup> 40	94 <sup>8</sup> 10	9430	9520
41+00	10190	101 <sup>18</sup> 48	94 <sup>9</sup> 05	9490	9515
42+00	10216	102 <sup>19</sup> 27	94 <sup>8</sup> 30	9473	9505
43+00	10258	102 <sup>15</sup> 45	94 <sup>8</sup> 20	9470	9523
44+00	10296	103 <sup>15</sup> 16	94 <sup>7</sup> 16	9490	9536
45+00	10316	103 <sup>22</sup> 20	94 <sup>7</sup> 50	9501	9526

9450	9630
9700	9800
9473	9860
9900	9875
9530	9800
9780	10000
9880	9965
9982	9945
9930	9920
9700	9785
9716	9800
10010	10000
9990	9990
9615	9965
9910	10000
9640	9780
9715	9940
10100	10120
9845	9900
9890	10100
9880	10075
9740	9846
9740	9854
9903	10068

95.90 7L 10" Tile from  
S.E. 200' S of 41+00

Sta.	10'S	Stake	Bed SE	e
46+00	101.50	101.70	96.90	95.22
47+00	99.15	98.95	95.95	95.20
48+00	101.30	101.10	95.95	95.15
49+00	102.56	102.11	96.00	95.37
50+00	98.05	99.30	98.00	95.78
51+00	101.48	101.47	96.56	96.20
52+00	102.26	102.36	96.46	95.90
53+00	100.92	101.22	97.50	96.40
54+00	102.33	102.41	96.87	96.27
55+00	100.23	99.78	96.80	96.80
56+00	102.56	102.69	97.16	96.62
57+00	102.60	102.87	97.56	96.62
58+00	102.50	100.39	97.10	96.75
59+00	102.26	102.07	97.67	97.04
60+00	103.10	102.30	97.56	96.86
61+00	102.53	102.61	97.56	97.14
62+00	102.60	103.10	97.74	96.65
63+00	102.83	103.69	97.40	97.56
64+00	105.40	106.30	98.70	96.72
65+00	103.00	102.09	98.92	97.20
66+00	104.83	105.12	98.25	97.10
67+00	106.32	106.24	99.63	97.70
68+00	106.54	105.99	98.39	97.36

Bed NE		
95.94	101.15	100.93
96.60	101.20	100.50
95.25	100.35	100.50
96.90	97.56	99.30
95.90	97.00	101.16
96.23	98.76	99.75
96.60	98.90	102.70
96.60	102.77	101.76
96.80	102.40	102.20
96.87	97.85	100.20
96.85	102.15	102.15
96.76	103.20	102.90
97.10	103.10	103.10
97.33	103.00	103.05
97.93	103.43	102.66
97.83	103.70	102.90
98.73	104.00	104.10
98.75	104.20	104.34
98.62	104.65	104.65
98.20	102.25	102.40
98.70	107.35	102.90
98.58	101.93	103.36
98.62	104.30	104.90

010587  
 B.M. 10818  
 Top Ind Br.  
 Co sign Sta. B.  
 Sta 64+00

Sta	10'S	Sta 2	Beds	E
546700	103.29	102.04	98.82	13.5
			98.82	17.92
70700	103.87	101.36	99.42	20.5
			99.42	18.30
71700	104.00	104.25	98.36	16
			98.36	17.90
72700	105.25	105.20	99.60	16
			99.60	18.70
73700	103.06	102.02	98.95	16
			98.95	18.45
74700	104.70	102.66	100.13	23.5
			100.13	18.70
75700	104.03	104.13	99.70	20.5
			99.70	18.60
76700	105.74	105.68	99.56	21
			99.56	18.85
77700	106.80	105.77	100.80	22.5
			100.80	18.40
78700	107.26	105.81	99.82	17.5
			99.82	18.70
79700	104.40	103.99	99.10	15
			99.10	18.90
80700	105.39	105.18	99.35	17.5
			99.35	18.80
81700	105.63	105.90	100.60	20.5
			100.60	17.32
82700	106.20	106.24	100.52	15.5
			100.52	19.92
83700	105.58	104.65	100.87	17
			100.87	19.76
84700	106.27	105.56	100.89	22.5
			100.89	100.02
85700	106.16	106.66	100.44	17.5
			100.44	99.80
86700	105.10	105.76	100.80	17
			100.80	99.60
87700	104.93	103.56	100.93	20.5
			100.93	99.90
88700	105.70	105.78	100.40	11
			100.40	99.50
89700	105.28	103.52	100.86	15
			100.86	99.75
90700	105.00	106.06	100.70	7
			100.70	99.75
91720	106.95	107.38	100.63	9
			100.63	99.30

Sta 1	Sta 2	Beds
80071		
98.52	104.60	27
		37
98.86	104.07	27
		103.87
98.95	101.26	37
		104.12
99.30	101.20	30
		101.56
99.02	102.90	30
		101.60
99.60	105.10	38
		103.75
99.06	103.70	38
		103.75
98.90	104.80	38
		103.75
99.50	105.60	38
		103.75
100.00	103.80	38
		103.75
99.20	104.00	38
		103.75
99.72	103.65	38
		103.75
100.45	106.05	38
		103.75
100.50	104.40	38
		103.75
100.52	104.62	38
		103.75
100.30	105.40	38
		103.75
100.50	106.18	38
		103.75
100.00	106.30	38
		103.75
100.65	104.90	38
		103.75
99.80	104.85	38
		103.75
101.76	105.10	38
		103.75
101.20	105.86	38
		103.75
101.35	106.73	38
		103.75

Sta	10.5	Stake	100.5	6.5
58 72+00	105.62	10609	10098	99.70
93+00	104.40	10574	10103	99.75
94+00	10606	10591	10100	99.52
95+00	10510	10593	10160	99.50
96+00	10565	10584	10180	99.90
97+00	10565	10616	10152	99.85
98+00	10580	10638	10158	99.70
99+00	10600	10526	10156	99.90
100+00	10660	10727	10245	100.67
101+00	10660	10771	10279	100.29
102+00	10608	10736	10220	100.50
103+00	10610	10689	10235	100.30
104+00	10695	10716	10152	101.34
105+00	10660	10410	10260	102.37
106+00	10690	10760	10275	102.09
107+00	10690	10772	10270	102.20
108+00	107.56	108.40	10282	102.29
109+00	106.46	10712	10274	102.35
110+00	10641	10697	10285	102.55
111+00	10677	10742	10296	102.40
112+00	107.33	108.41	10276	102.60
113+00	107.40	10797	10316	102.24
114+00	106.30	10670	10317	102.47

BM	10.5	Stake	100.5	6.5
10025	10616	10560		
10076	10575	10552		
10085	10575	10555		
10120	10665	10605		
10128	10573	10563		
10140	10647	10583		
10170	10655	10595		
10150	10658	10600		
10150	10654	10600		
10130	10775	10670		
10220	10683	10696		
10230	10750	10700		
10210	10805	10700		
10222	10445	10670		
10255	10793	10705		
10225	10700	10650		
10265	10700	10665		
10273	10800	10745		
10260	10650	10500		
10242	10842	10770		
10276	10655	10652		
10290	10653	10693		
10310	10765	10745		

BM. 110.80  
 E. end S. Rail  
 Sta C. T. Line  
 Sta 105+00

Sta	105	Stake	Bed	24	4
58 115+00	10765	10804	10340	10229	13
116+00	10750	10796	10320	10210	6
117+00	10740	10777	10285	10223	7
118+00	10700	10723	10275	10238	6
119+00	10725	10769	10336	10250	9
120+00	10725	10802	10290	10285	8
121+00	10766	10783	10252	10252	7
122+00	10735	10776	10310	10255	7
123+00	10775	(10698)	10300	10177	5
124+00	10805	10820	10265	10153	7
125+00	10610	10629	10345	10166	5
126+00	10650	10625	10325	10150	5
127+00	10694	10732	10350	10192	6
128+00	10685	10622	10320	10216	5
129+00	107.51	10651	10320	10227	5
130+00	107.21	10721	10332	10236	5
131+00	10790	10802	10349	10254	5
132+00	10822	10931	10380	10220	8
133+00	10885	10900	10340	10240	10
134+00	10825	10911	10370	10256	9
135+00	107.96	108.12	10320	10242	9
136+00	107.90	108.13	10360	(10297)	8
137+00	10835	10894	10370	10275	6
138+00	107.85	10906	10390	10300	8

10235	10770	10720	27
10286	10700	10695	20
10265	10790	10760	20
10253	10802	10745	20
10275	10836	10770	20
10275	10745	10700	20
10310	10695	10760	21
10310	10735	10759	21
10270	(10697)	10680	15
10295	10780	10780	15
10280	10610	10650	14
10220	10690	10700	15
10310	10695	10710	17
10297	10610	10625	14
10335	10660	10660	14
10320	10740	10740	14
10349	10794	10876	16
10350	10780	10795	17
10330	10916	10870	19
10350	10825	10800	17
10340	10850	10810	18
10370	10805	10855	17
10385	10900	10930	10
10410	10930	10840	19

39

B.M. 110.97  
S.E. wing of  
Cumb. P.R. Bridge  
Sta 123+00  
Span 11'  
111.30 Hub Sta 123

Sta	10'5	Stake	Red	14
139+00	108.46	109.53	104.00	102.96
140+00	108.00	109.10	104.00	102.90
141+00	108.56	109.73	104.10	103.25
142+00	108.50	108.60	104.40	103.20
143+00	107.65	108.39	104.15	103.35
144+00	108.00	109.70	104.10	103.60
145+00	108.20	109.29	104.70	103.21
146+00	107.95	109.86	104.90	103.75
147+00	108.43	109.35	104.90	103.40
148+00	108.90	110.00	104.50	103.73
149+00	109.50	108.49	104.73	103.60
150+00	108.95	108.97	104.75	103.65
151+00	108.80	110.23	105.10	103.96
152+00	108.29	109.50	104.43	104.02
153+00	108.60	109.42	105.28	104.66
154+00	109.30	109.62	105.40	104.22
155+00	109.00	110.11	105.62	104.57
156+00	109.40	109.20	105.00	104.50
157+00	109.50	110.00	104.80	104.40
158+00	109.10	109.80	105.40	104.62
159+00	108.90	109.63	105.50	104.40
160+00	109.25	110.32	105.55	104.70
161+00	108.95	110.59	105.70	104.75

Red	24	
103.70	108.85	108.60
104.70	109.20	108.50
103.75	108.30	108.60
103.70	109.00	108.10
104.70	109.20	108.50
104.15	109.60	108.70
103.70	108.90	109.00
104.50	109.50	109.30
104.45	109.20	109.00
104.65	109.69	109.00
104.80	110.10	108.90
104.45	109.60	109.00
104.55	110.20	108.90
105.33	110.26	109.20
105.65	110.00	109.10
105.65	109.60	108.70
105.50	110.00	109.30
105.50	108.80	108.56
105.76	109.80	109.25
105.35	109.45	109.00
105.70	109.80	108.65
105.45	109.50	109.00
106.05	110.20	109.50

61

105.26 Top  
18" Tile at outlet  
McLeod Drain  
Sta 147+00

105.26  
1.72  
103.69

Sta 10's Stake by

162+00	10925	11037	10540	10450
163+00	10960	11092	10570	10490
164+00	11022	11075	10595	10460
165+00	11030	11119	10590	10530
166+00	11015	11110	10600	10515
167+00	11020	11137	10630	10560
168+00	10990	11068	10600	10525
169+00	11075	11152	10600	10540
170+00	11040	11170	10650	10570
171+00	11022	11090	10670	10560
172+00	10987	11028	10660	10625
173+00	11021	10996	10675	10620
174+00	10870	10860	10676	10615
175+00	11100	11109	10700	10600
176+00	11145	11055	10634	10630
177+00	11110	11095	10700	10650
178+00	11085	11113	10740	10640
179+00	11083	10941	10715	10675
180+00	11156	11052	10732	10710
181+00	11140	11123	10661	10650
182+00	11140	11173	10740	10679
183+00	11140	11025	10789	10680
184+00	11093	11096	10797	10680

10560	11050	11000
10610	11110	11000
10540	11085	10970
10650	11075	11020
10600	11080	11000
10610	11110	11030
10580	11135	11000
10650	11145	11060
10670	11115	11070
10736	11100	11022
10690	11080	11000
10720	10996	10980
10710	10970	10950
10676	11073	10970
10690	11080	11040
10725	11055	11030
10720	11095	11050
10730	11120	11035
10740	11132	11105
10705	11116	11116
10763	11170	11126
10740	11240	11220
10776	11100	11130

B.M. 115.13  
 End Stake  
 Cult. Sta  
 183+25



64	185+00	109.65	109.16	107.60	106.80
	186+00	111.50	111.64	107.30	106.70
	187+00	111.70	111.96	107.90	106.40
	188+00	111.90	112.08	107.20	106.75
	189+00	111.76	111.86	107.65	106.80
	190+00	111.80	112.30	108.00	107.40
	191+00	112.00	111.46	108.20	106.70
	192+00	112.10	111.31	108.35	107.76
	193+00	112.00	110.03	108.30	108.00
	194+00	112.05	112.65	108.40	107.50
	195+00	112.70	113.20	108.40	107.83
	196+00	112.55	113.18	108.67	108.20
	197+00	112.60	113.39	109.25	108.31
	198+00	113.20	114.19	108.70	107.80
	199+00	112.55	113.64	109.16	108.15
	200+00	113.06	113.64	108.80	108.80
	201+00	113.60	114.02	108.90	108.66
	202+00	113.00	112.92	109.25	108.95
	203+00	113.70	113.85	109.90	109.20
	204+00	113.20	113.30	110.05	109.25
	205+00	113.50	112.51	110.10	109.30
	206+00	113.50	114.09	109.80	108.77
	207+00	113.55	113.81	109.60	108.90

107.60	111.50	111.50
107.55	111.65	111.70
107.85	113.25	113.00
108.00	111.00	112.00
107.50	109.50	111.40
107.90	110.60	113.20
108.22	109.10	111.30
108.25	112.85	112.40
108.40	112.30	112.80
108.70	113.60	112.55
108.60	113.00	112.00
108.70	113.60	111.60
108.95	113.10	112.00
108.60	113.20	112.20
108.20	113.60	112.20
109.10	113.00	112.50
108.90	113.00	112.50
108.90	113.00	112.00
109.00	113.50	113.60
109.80	113.85	113.60
110.15	113.60	113.95
109.39	113.80	113.40
109.55	113.91	113.80

112.57  
 BRT E end  
 head of  
 ditch sta 203+70  
 Top tile  
 109.26  
 Bot. tile  
 108.57

Sta	18'	Stake	Bed	10.5
208+0	11395	11408	10990	10920
209+00	11350	11382	10960	10970
210+00	11415	11415	11030	10913
211+00	11300	11355	11010	10900
212+00	11355	11336	10970	10905
213+00	11365	11439	11010	11085
214+00	11440	11400	11035	10885
215+00	11460	11504	10992	10920
216+00	11420	11434	11060	10990
217+00	11377	11393	11045	11000
218+00	11453	11486	11110	10970
219+00	11475	11506	11080	10945
220+00	11470	11493	11105	10985
221+00	11480	11504	11110	11020
222+00	11420	11449	11080	11090
223+00	11425	11464	11110	11020
224+00	11420	11524	11100	11020
225+00	11450	11506	11134	11015
226+00	11462	11446	11100	11020
227+00	11425	11432	11100	11030
228+00	11430	11496	11110	11050
229+00	11370	11353	11070	11075
230+00	11510	11573	11178	11090

Bed	23	15
10965	11460	11395
11000	11420	11370
11060	11490	11430
11005	11510	11460
10985	11445	11350
11045	11460	11360
11005	11440	11400
11050	11475	11420
11080	11450	11420
11069	11445	11400
11060	11435	11400
11075	11450	11415
11100	11450	11425
11075	11430	11425
11160	11460	11400
11075	11445	11400
11095	11400	11435
11120	11466	11480
11100	11520	11445
11120	11560	11500
11120	11485	11525
11170	11530	11500
11130	11495	11495

W End Header  
Montgomery Dist  
Sta 222+50

Top Tulo  
111.43  
F.L.  
109.90

113.77  
B.M. on head  
tulo ditch 229+00

Top Tulo  
111.46  
Bot Tulo  
110.35

Sta	10'	Stake	Ref	Ch
231+00	115.10	115.81	111.70	110.90 <sup>9.5</sup>
232+00	115.25	115.99	111.50	111.45 <sup>8</sup>
233+00	115.10	115.06	111.50	111.05 <sup>8.5</sup>
234+00	115.28	116.16	112.60	111.85 <sup>6</sup>
235+00	115.00	115.87	112.60	111.50 <sup>8</sup>
236+00	115.90	116.41	112.50	111.27 <sup>6.5</sup>
237+00	115.66	116.13	112.55	111.70 <sup>8.5</sup>
238+00	115.20	116.07	112.70	111.60 <sup>9</sup>
239+00	115.30	116.03	112.70	111.83 <sup>9</sup>
241+00	115.50	116.29	112.70	111.80 <sup>10</sup>
241+00	115.70	116.69	112.00	112.05 <sup>11.5</sup>
242+00	115.85	116.56	112.90	112.20 <sup>11.5</sup>
243+00	115.50	115.25	113.20	112.05 <sup>11</sup>
244+00	115.91	116.72	112.90	111.90 <sup>10.5</sup>
245+00	115.75	116.71	113.50	112.45 <sup>11.5</sup>
246+00	115.95	116.82	113.40	112.52 <sup>12</sup>
247+00	116.15	116.27	113.70	112.65 <sup>9.5</sup>
248+00	116.20	116.82	114.00	112.45 <sup>9</sup>
249+00	116.15	117.25	113.80	112.55 <sup>10.5</sup>
250+00	116.40	116.46	113.15	112.60 <sup>12</sup>
251+00	116.60	116.67	114.05	113.15 <sup>11.5</sup>
252+00	116.75	116.86	114.20	113.10 <sup>12</sup>
253+00	116.20	117.35	114.05	113.00 <sup>10.5</sup>

112.70	115.70	115.70
112.00	115.60	115.50
111.60	115.20	115.60
112.45	115.60	115.40
112.30	115.90	115.60
113.10	116.45	116.10
112.40	115.90	115.80
113.10	116.20	115.80
112.75	115.50	114.80
113.10	115.55	115.25
113.20	116.50	115.40
112.95	115.20	115.35
113.20	115.85	115.30
112.70	116.75	115.85
113.20	116.20	115.60
113.70	116.30	115.80
113.45	116.55	116.05
112.76	115.75	115.65
113.60	116.40	116.33
113.70	116.50	116.00
113.60	116.75	114.90
114.20	116.25	116.50
114.05	117.20	117.10

Sta	1015	1016	1017	1018
254+00	11690	11716	11440	11295
255+10	11690	11729	11460	11340
256+00	11755	11761	11470	11312
257+20	11725	11696	11450	11370
258+10	11793	11832	11410	11390
259+00	11798	11853	11460	11390
260+00	11840	11841	11370	11340
261+00	11750	11867	11510	11405
262+00	11765	11806	11520	11430
263+00	11740	11838	11470	11460
264+00	11905	11914	11515	11407
265+00	11975	11886	11560	11433
266+00	11910	11892	11516	11453
267+00	11860	11910	11475	11475
268+10	11920	11905	11500	11468
269+00	11920	11920	11540	11451
270+00	11970	11987	11520	11495
271+00	12016	12082	11545	11511
272+00	11995	11996	11570	11550
273+00	11875	11900	11620	11532
274+00	11925	11927	11605	11545
275+00	11870	11946	11610	11555
276+00	11910	11990	11640	11588

1019	1020	1021
11280	11710	11700
11385	11741	11740
11400	11702	11760
11390	11690	11720
11465	11738	11650
11425	11650	11773
11355	11705	11720
11465	11786	11910
11465	11870	11855
11495	11930	11920
11550	11921	11905
11517	12057	11975
11530	11980	11910
11492	11866	11910
11550	11960	11920
11540	11965	11935
11575	12050	12015
11575	12050	11970
11560	12040	12000
11600	11970	11930
11635	11990	11925
11620	11945	11940
11595	12021	12011

71

11652  
 Top 48" B.P.  
 Culvert  
 Sta 260+00  
 Bot = 112.52

115.23 Top  
 10" Tile outlet  
 50' N Sta 263+40

Sta 10' Stake Bed CL

277+00	119.10	119.80	116.70	116.35
278+00	120.00	120.25	116.80	116.40
279+00	119.65	120.37	116.80	116.62
280+00	120.00	120.66	117.10	116.62
281+00	120.20	120.47	117.10	116.75
282+00	120.40	120.58	117.20	117.00
283+00	120.15	120.02	117.40	117.05
284+00	119.77	120.15	117.50	117.05
285+00	120.10	119.58	117.50	117.50
286+00	120.25	121.14	117.95	117.50
287+00	120.35	121.47	117.85	117.00
288+00	120.35	121.13	118.10	117.55
289+00	120.65	121.39	117.90	117.52
290+00	121.25	121.67	118.42	118.05
291+00	121.30	121.98	118.40	117.85
292+00	121.80	121.78	118.55	118.25
293+00				
294+00	123.30	123.76	118.95	118.70
295+00	124.74	125.22	119.13	118.66
296+00	124.80	125.32	119.74	118.53
297+00	124.05	124.82	119.45	119.16
298+00	123.45	124.05	119.70	118.95
299+00	122.46	123.13	120.05	119.50

Bed

116.60	119.50	119.22
116.80	120.10	119.70
116.65	120.45	120.50
116.95	120.70	120.50
117.05	120.30	120.45
117.20	120.80	120.60
117.10	120.30	121.10
117.70	120.45	120.65
117.75	120.90	120.25
118.10	121.30	120.50
117.60	120.90	120.70
118.10	121.25	120.85
118.15	121.30	120.90
118.15	121.90	121.73
118.80	121.94	121.80
118.45	122.10	121.70
119.10	122.10	122.55
119.16	124.05	124.25
119.30	124.10	123.70
119.62	123.70	123.14
120.00	123.20	122.90
120.10	122.60	122.10

73

120.48  
Top W end 48"  
B.P. Culvert  
Sta 284+50

116.48 7.L.

124.41  
13 M  
W end E. Rail  
Culvert Sta 9.  
292+80

Sta 293 1314 Coy  
Road  
Elt ditch 292+90  
118.65  
" " " 293+10  
118.50

Sta. 10' State Bed

300+00	122.50	12368	11975	11975
301+00	12260	12353	11960	11930
302+00	12235	12395	12010	11962
303+00	12245	12366	12022	11980
304+00	12235	12360	12040	12010
304+40	12220	12332	12070	12015

Check Bench Marks

12441 BM Sta 292+80

128.05

128.15

126.43

125.18

123.65

117.47

117.83

111.75

119.05

113.76

109.36

108.65

107.57

111.52

104.42

100.34 B.M. No 1 Sta 0+00

S. end W. Rail Culvert over  
Kennedy Ditch English Road  
Bed Kennedy Ditch W side Road

Bed

11990	12310	12270	
121.05	12280	12270	120.51
11995	12305	12280	Top 8" Tile
12019	12332	12316	304+40
12040	12375	12330	
12066	12370	12270	304+40 End open Drain

Station	Gr. Stk	Beam	Side	Bottom	Can	Line	Beam	10 fms	Beam			
OE		10		12								
OE 62+0	92.44	2.8	3.40	6.0	10	89.05	29	90.02	31	95.33	41	96.30
OE 61+0	94.20	4	92.96	12	89.56	18	89.21	43	93.70	53	93.80	
OE 60+0	93.96	1	93.93	11	89.78	15	88.65	32	92.51	42	93.90	
OE 59+0	94.14	1	94.10	8.5	89.23	14.5	89.37	35	93.96	45	93.58	
OE 58+0	93.71	2	93.42	11	89.26	13.5	89.13	31.5	93.59	41.5	93.10	
OE 57+0	93.82	1.5	93.30	13	89.45	14.5	89.73	27	91.45	42	93.53	
OE 56+0	93.62	2	93.24	10.5	89.14	13.5	88.19	32.5	92.65	42.5	92.09	
OE 55+0	91.94	3	91.79	15	89.16	15	88.05	31.5	93.11	41.5	92.69	
OE 54+0	92.59	1.5	92.15	6	89.04	11.5	88.24	32	91.02	45	92.80	
OE 53+0	91.94	3	91.23	12.5	89.15	13.5	88.68	26.5	93.25	44	93.65	
OE 52+0	92.82	1	92.39	11	88.96	12.5	88.73	32.5	92.31	48	92.8	
OE 51+0	92.95	1	92.51	8	88.25	11	87.91	25	92.41	44	92.56	
OE 50+0	91.85	5	91.31	20	87.23	13.5	86.11	34.5	92.34	49	91.98	
OE 49+0	92.34	5	91.82	14	88.36	13.5	88.10	31	91.24	45	93.14	
OE 48+0	91.83	3.5	91.95	5.5	87.38	18	88.33	25	92.05	48	92.37	
OE 47+0	92.22	11.5	92.00	5.5	87.35	13	87.53	27	90.90	43	91.51	
OE 46+0	91.05	6.5	89.56	7.5	86.16	13.5	86.41	33.5	91.00	43	91.87	
OE 45+0	91.75	6	90.81	15	86.30	17	87.57	37	91.81	48	91.85	

77

53-54  
depl. dately  
150 S  
from W

52-51  
56° from SW  
to W.

48-47  
depl 1/10 S  
W

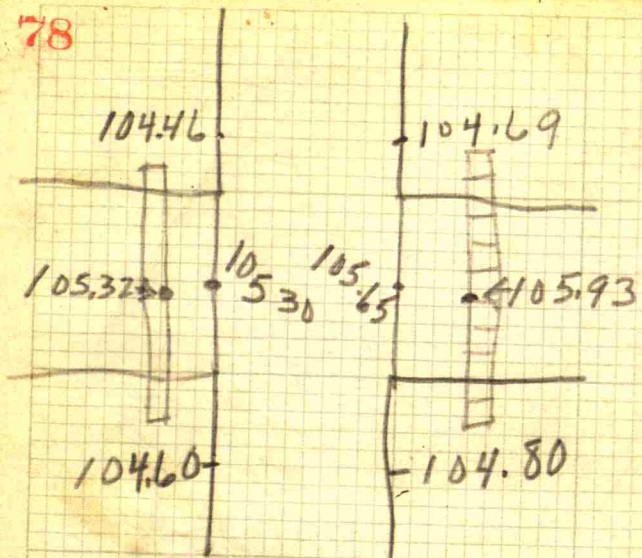

N. Salem St. Intersections

37.5  
 4000  
 150,000.0



Stake E'N

0	100.00		Good
+50	102.62	102.50	
1	103.25	103.25	
+50	104.67	104.40	
2	106.27	105.83	Good
	Good		
+50	106.60	106.34	
	Good		
3	107.00	106.82	
	Good		
+50	107.75	107.65	
4	108.55	108.30	
+50	109.18	109.15	Good

Stake's of Sedse  
Walk.

Stake  
Beg Pt H'N of NE cor  
Kt - end 100m

Chas Smith  
 Mrs Hardesty  
 John Watts  
 Paul Clark  
 Troy Lamb  
 Dave Thompson

Kurt's call

old lane

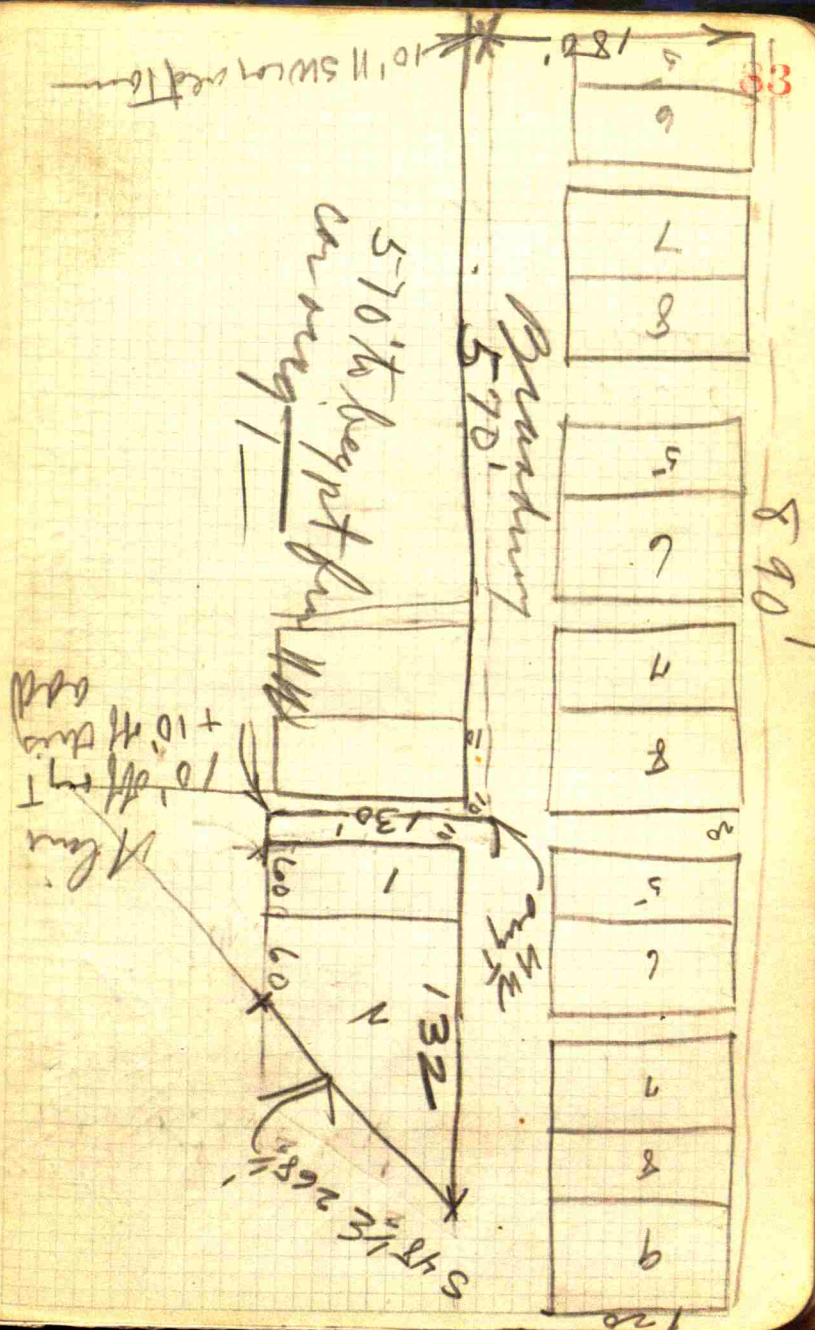

120	120	120	120	120
95	60	60	60	60
4	4	4	4	4

120	120	120	120	120
100	110	140	140	120
9	8	7	2	6
60	60	60	60	60

120	120	120	120	120
120	120	120	120	120
5	5	5	5	5
60	60	60	60	60

120	120	120	120	120
120	120	120	120	120
4	4	4	4	4
60	60	60	60	60

Wagon W/tyres  
and  
Wagon W/tyres  
and  
Wagon W/tyres  
and

McKibbin et

Wagon W/tyres and odd

XI

Wagon W/tyres  
and odd

B.M. 100 00  
 Edge N+S  
 Wk 4' from  
 N. end .0 to 1  
 3'S 4 RA 15N

0+05	99.65	99.76	99.70
0+20	99.42	99.42	99.55
0+50	99.20	99.05	99.31
1+00	99.27	98.87	98.56
1+50	99.20	98.80	99.46
2+00	99.36	98.96	99.82
2+50	99.83	99.73	100.60
3+00	101.73	101.35	101.25
3+50	102.59	102.65	102.33
4+00	103.62	103.76	103.50
4+33	106.43	E end 4'	
4+50	107.00	106.95	104.60
5+00	108.32	108.35	105.83
5+43	108.50	108.82	106.43
10666 4 RA W of Wnd Wk			

1+81 - 2+05 Hdwp  
 5' S 5th line  
 Inlet at mid pt.

9783 Top of Hdwp 5' W 5th line

Walk edge 1.85 of 5th line

5+43 Wnd Wk - S of 5th

89

57100		126.00	
57150	126.95	126.25	
57175	127.16	126.37	
57190	127.15	126.48	
57191	127.36	126.48	
58	127.43	126.50	126.81
725	127.48	126.67	
750			
775	127.36	126.87	
59150	127.66	127.00	
59175	127.61		
60100	127.65	127.17	
60125	127.69		
150	127.82		
775	127.95		
61	127.98	127.33	127.46 +.13
725	127.80		
750	127.90		
775	127.93		
62	127.99	127.50	127.47 - .03
725	128.07		

Flinn Road Ditches

Kennedy Ditch  
Beam Sta 75+80

0+00 75+80 Bed'ole's turn  $\frac{1}{2}$   
99.55

0+20 99.93

1+00 100.09

2+00 100.57

3+00 100.81

4+00 100.54

5+00 101.34

101.03

6+00 101.10

7+00 101.10

8+00 101.58

9+00 101.39

10+00 101.47

John T. Barnett

From <sup>opp</sup> sta 63+00 - run N -  $8^{\circ} 31' 00''$   
with old channel to sta 55+18  
then deflct  $\angle 44^{\circ} 0'$  and  
run S - to sta 46+54

Def L  $25^{\circ} 20'$  and follow  
old channel approx to sta 41+22

Then def L  $30^{\circ} 52'$  and follow  
approx old channel to sta 38+20

Def-R  $38^{\circ} 30'$  and follow  
new location to sta 32+00 -

Def L  $6^{\circ} 36'$  and follow new  
location to sta 25+00 except ~~bed~~

Def R  $3^{\circ} 46'$  run and follow  
approx old channel to sta 22+18

Def. R.  $36^{\circ} 50'$  run to sta 6+75  
all new location.

Sta 6+75 Def L.  $33^{\circ} 57'$   
and run to sta 0+00

Sta	Elev	Notes
63+00	94.62	Sta
61+00	94.81	
60+00	93.83	
59+00	93.32	
58+00	93.76	
57+00	93.33	
56+00	91.25	
55+18	93.96	
55+00	93.47	
54+00	93.00	
53+00	92.60	
52+00	92.62	
51+00	92.30	Red
50+00	87.15	Bed
49+00	94.15	
48+00	92.51	Bed
47+00	88.70	85.70
46+54	90.25	87.90
46+00	91.86	87.30
45+00	92.40	87.10
44+00	92.54	87.35
43+00	92.11	87.22
42+00	90.95	86.85
41+22	91.45	86.80
41+00	91.81	86.10
40+00	91.75	85.90

PI at 55+18  
15 20.5' NW of  
30" Syc -  
PI to Can old  
bed is 30'

Sta 58-65 @  
8' old channel

Sta 54-25' to  
Can old channel

53-40' to Can  
old channel

52-50' to Can  
old channel

51-60' to Can OC

50+00 in Can OC

49 is 30' S of Can OC

48 is 40' S of Can OC

Can old channel Sta

47+00

Cross <sup>Chap</sup> Rutledge S line sta  
46+65

ATI - 46+56 <sup>25'</sup> E to Cen OC

Bowen ditch from W W at yr

Cross Ousley H line sta 37+16

Cross rd C - sta 29+00

Sta 28 is 60' W of cutoff

Cross rd C at 27+80

Put channel at 27+00 and  
follow approx -

Cross Brumbull H line 26+50

Sta 22+0 Stream - 30' SE.

Sta 21+0 O.C. - 50' SE.

Sta 20+0 - O.C. - 15' - SE.

Sta 19+70 - Hits O.C. and  
continues in O.C. to Sta

Sta 19+00 - in O.C.

	Stk	Bedoc.	E New L
39+0	91.69	86.43	
38+20	91.43	86.51	
38+00	90.67		
	Ground	25'E	
37	89.38	88.85	
36	87.36	87.30	
35	87.54	90.00	
34	89.32	87.10	
33	88.15	86.60	
32+0	89.39	86.40	
31	86.36	89.05	
30	89.00	88.80	29 in dC
28+80	89.85	84.75	
28+0	88.78	88.78	
27+0	89.13	25' Empires Ditch	
26+0	85.30	End stream 83.62	
25+00	88.15	83.76	
24+00	83.77	82.45	- Stk in stream
23+00	87.65	83.33	- Stream 25'E
22+18	86.33	82.85	- Stream 25' SE
22+0	88.41	85.20	- Top of bank
21+0	89.85	82.76	- 86.90
20+0	87.30	82.90	
19+0	82.85	81.80	- 86.82
19+00			in O.C.



Survey O.C.

Sta 18+0 - O.C. is 60' N of  
3th. line.

17+35 - 7th C crosses O.C.

Sta 17+00 - O.C. 100' SE.

Sta. 17+70 - 36" eye, 5' N. of  
3th line.

18+45 24" dead tree 20' SE.

O.C. is 35' SE of 16+0

Sta 16+0. O.C. - 30' SE.

Sta 15+0 O.C. - 50' S.

Sta 14+00 - O.C. - 70' S

Sta 14+40 - Two trees 24"  
20' S of 3th line.

11+00 - O.C. is 60' SE.

10+60 - Cross O.C.

9+30 - Bensonfield's S line  
Williams N. line

open ditch from NW at  
7+20

Sta 7+00 crosses O.C. 79.55  
O.C. 40' SE. of 6+00

Sta	Stk.	Bed. O.C.	E. HWC
18+00	87.36	82.40	86.36 0.7
17+35 -		82.05	
17+0 -	87.70		87.23
16+0 -	87.05	81.43	86.02
15+0 -	86.69	82.15	86.70
14+0 -	87.06	81.50	86.34
13+00 -	86.70		86.33
12+00 -	85.80		85.21
11+00 -	85.53		84.45
10+00 -	85.58	80.68	85.45
9+00	85.16		83.84
8+00	85.21		85.06
7+00		79.55	
6+75	85.33	40	84.57
6+00	85.83	79.10	83.99 15'
5+00	83.80	78.80 <sup>35</sup>	84.57
4+00	85.17	79.60 <sup>50</sup>	83.27 15'
3+20	83.95	79.30	84.03 15'

Bed of stream

79.40

Sta 5+0 - 35' W of O.C.

Sta 4+0 - 50' W of O.C.

3+20 - 75' W of O.C.

2+0 - 25'

98 sta 6+75

$\angle 88^{\circ}54'$

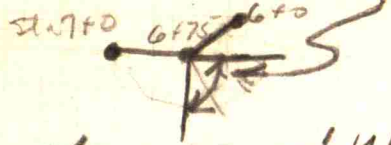

stone is 150' NW of stake at  
sta 6+75

99

ST Gd

3+00	84.40	79.31	5.09
4+00	85.06	79.46	5.60
5+00	84.06	79.61	-4.44
6+00	85.67	79.76	-5.94
6+175	85.20	79.88	-5.32
8+00	85.45	80.06	✓
9+00	84.95	80.21	✓
10+00	85.58	80.36	✓
11+00	85.53	80.51	✓
12+00	85.90	80.66	✓
13+00	86.70	80.81	
14+00	87.06	80.96	
15+00	86.69	81.11	
16+00	87.05	81.26	
17+00	87.70	81.41	
18+00	87.36	81.56	
19+00		81.71	
20+00	87.30	81.86	

21-	87.85	82.01	
22-	88.41	82.16	
23	87.65	82.31	
24		82.46	
25	88.15	82.61	
26	85.30	82.76	
27	88.13	82.91	
28	88.78	83.06	
29	88	83.21	
30	89.00	83.36	
31	86.36	83.51	
32	89.39	83.66	
33-	88.15	83.81	
34	89.32	83.96	
35	87.53	84.11	
36	87.36	84.26	
37	89.38	84.41	
38	90.67	84.56	

35'  
 125' 6 1/2"  
 125' 6 1/2"  
 10

---

296 1/2  
 827

---

1123 1/2

8  
 Kurepa 2nd add

Rank from Cite			1	2
1	6	5	4	3
8	9	10	11	12
22	4			

Douglas

Murray

Survey for  
Florence Dungan  
in Sec 3-15-1W

For Dec. see  
Typewritten Copy

Files

Cent W. Corn Dec 3 Nyp 16-532' W 25'  
W about 24 N 27 E 86  
By 14.37 ch A of Cent W. Corn where Beecher  
18 - N 32 1/2 W 13 and 20 1/2 W 31  
then S 43 1/2 W 5.12 ch then S 45° 20' W 3.75  
ch then S 82 1/2 E 1.50 ch. then S 76 L. then  
N 87 1/4 E 4.80 ch.

pt 10<sup>2</sup> 110<sup>4</sup> Sec 3

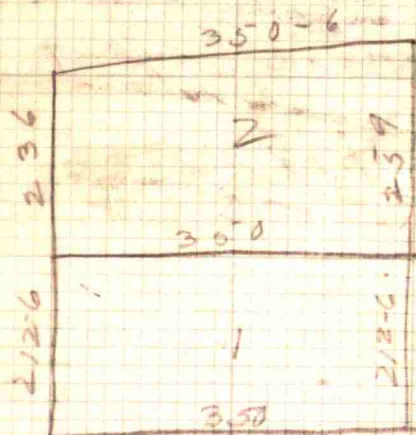

NE cor Crawford add to Danville.  
11/21/21 → Shown 96'

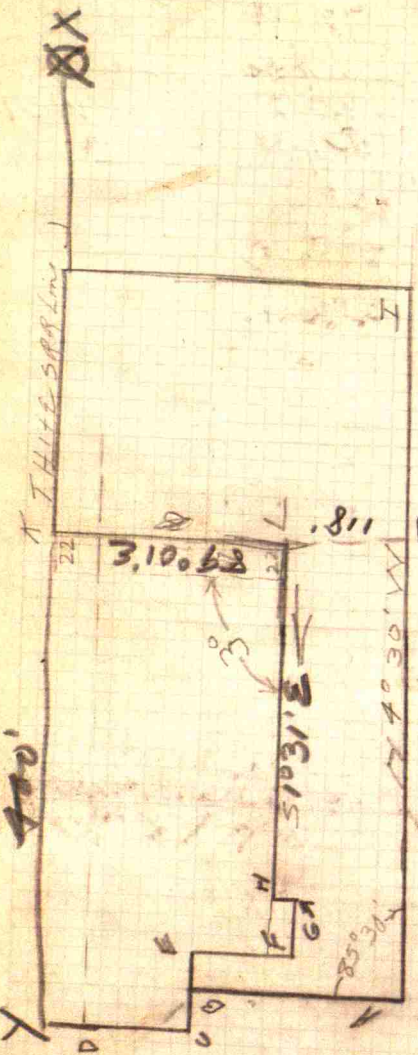

Line	Direction	
AB	East	225.0'
BC		34.0
CD		125.0'
DE		44.0
EF	West	109.0'
FG		53.0'
GH		22.0'
HI	N4°30'W	694' to N.R. of W. T.H.H. + E Drive To part is 50' wide
IJ	S87°20'W	297'
JK	South	301' $\odot$ is 22'H of NW cor. Naveset add to Corn
KL	S89°01'E	204'
LH	S1°31'E	288'
JX		104' X is stone N. right of corner old met set 1891
YK		422'
LZ		118'

A part of the SE<sup>4</sup> of the SW<sup>4</sup> of Sec 3, township 15, North of Range one west describe & as follows.

From the S<sup>2</sup> mile stone of said Sec 3, run South along the N<sup>+</sup>S center line of sec. 10 T<sup>+</sup> Range of said a distance of 112.5 feet to the center of the Indianapolis and Rockville Road. thence deflect right 99° 15' and run N. 80° 45' W along the E of said highway a distance of 823.5. thence deflect left 1° 13' and run N 81° 58' W a dist. along the E of said highway a distance of 389. ~~to~~ thence deflecting left 3° and 16' and run N 85° 14' W along the E of said highway to a point of intersection of said E with the W line of the SE<sup>4</sup> of said the SE<sup>4</sup> of the SW<sup>4</sup> of said Sec 3. said point of intersection being located 27 feet of the SW cor of said Quarter Quarter. From this last named point which is ~~the~~ the beginning point of this description, running thence North along the E line of the original town of Danville a distance of ~~—~~ feet to the SW corner of Naves 2nd addition

to the East Cemetery in 123 the town of Danville. thence running E along the S line of said 2nd add. to said Cem. to the ~~SE~~ corner a distance of 125' and to the SE corner thereof thence running North along the E line thereof a distance of 44' and to a point which is 34.5 of the S line of Naves 1st add. to said Cemetery. thence running E parallel to and equally distant from the South line of said 1st add. a distance of 225.8'. <sup>to the stone</sup> thence running S 40° 30' E a distance of ~~—~~ to the center to a stone. thence running S ~~—~~ W a distance of 108' to the cor of the above described highway. thence running N 81° 58' W along the E of said ~~highway~~ a dist. of 193.5'. thence runny N 85° 14' W along the E of said highway a dist. of 126' to the place of beginning

	Grstave	Berm	side station	Can land
DE 44+0	91.67	490.91	10 8707	14 8622
DE 43+0	91.94	1391.93	11.5 8715	22 8698
DE 42+0	91.15	3 9036	13 8699	21 8675
DE 41+0	90.77	3 89.27	14 8659	15 8596
DE 40+0	90.82	1 90.31	14 8676	15 8609
DE 39+0	90.92	2 90.41	14 8677	12.6 8535
DE 38+0	90.91	1.5 90.81	14 8674	15 8578
DE 37+0	90.37	90.37	12 8669	21 8642
DE 36+0	89.91	5 89.91	14 8643	23 8535
DE 35+0	91.22	7 89.41	14 8676	17 8435
DE 34+0	89.30	89.30	15 8678	23 8486
DE 33+0	90.49	3 89.90	14 8674	11 8501
DE 32+0	90.14	2.5 89.54	14 8694	18 8436
DE 31+0	89.91	1 89.41	8 8554	16 8379
DE 30+0	90.16	90.16	6 8460	11 8422
DE 29+0	90.31	4 88.41	7 8459	14 8922
DE 28+0	88.85			65 ft from stake
DE 27+0	87.97			same cut as
DE 26+0	88.93	2 88.63	10 8358	16 8333
DE 25+0	88.85	3 86.44	2 83.93	12 8330
DE 24+0	88.76	2 88.11	2 84.02	10 83.30
DE 23+0	87.87	2 87.16	9 8376	13 83.21
DE 22+0	86.48	86.48	15 84.02	15 83.44
DE 21+0	87.24	3 86.62	14 8385	17 8276

	side station	Berm	10' berm
38 87.40	36 90.92	45 90.67	
39 89	35 91.22	46 91.83	
40 86.69	32 90.85	43 90.48	
41 86.09	27 90.69	37 91.29	
42 86.19	33 90.86	43 91.15	
43 86.37	27 90.27	37 90.85	
44 86.59	30 90.57	40 90.79	
45 86.70	23 90.73	43 90.68	
46 86.30	35 89.85	45 90.60	
47 85.23	49 90.34	39 90.81	
48 85.80	23 90.00	43 89.85	
49 84.74	32 89.58	42 89.77	
50 84.69	22 89.50	32 89.68	
51 84.34	18 87.63	31 89.83	
52 84.16	18 88.61	26 89.12	
53 84.16	22 87.53	33 89.11	
54 83.83	24 7.49	37 88.54	
55 84.04	32 86.55	42 88.76	
56 83.76	26 86.52	36 88.01	
57 83.60	35 85.15	43 88.00	
58 83.48	27 86.01	37 87.35	
59 83.26	22 87.68	35 87.65	

527-40 road side  
30° to south

Bm 91.51  
water gap between  
w end of station 37

short cut  
elevation 84.70  
stake line  
35 87.10

definition 3 lines  
south 115° SW

short cut  
stake 22

88.79  
37 ft from  
stake

88.56  
37 ft from  
stake

75 ft from  
stake to ditch

stake 26 definition  
ditch 2700 ft to south



	Corner Pole	add Berm	side bottom	4
DE 20+0	8748	3 8678	6 8350	14 8248
DE 19+0	8646	4 8578	8 8263	14 8206
DE 18+0	8745	7 8545	15 8376	28 8227
DE 17+0	8687		over	30 8185
DE 16+0	8675	12 8554	15 8207	30 8222
DE 15+0	8715	9 8604	20 8239	22 8192
DE 14+0	8706		short cut	
DE 13+0	8715	4 8704	dry cut 15 8230	18 8183
DE 12+0	8630		side on cut	
DE 11+0	8619	2 8589	15 8179	17 8107
DE 10+0	8606	6 8516	9 8145	12 8100
DE 9+0	8595	4 8570	7 8179	18 8035
DE 8+0	8495	7 8440	12 8099	16 8030
DE 7+0	8572	30 ft 8509		
DE 6+0	8525	6 8421	12 8056	16 8059
DE 5+0	8456	4 8367	12 8038	15 7970
DE 4+0	8390	6 8268	9 8054	12 8151
DE 3+0	8556	cut 4-3	6 ft south of stake	
DE 2+0	8523	3 8500	8 7970	18 799
DE 1+0	8496	10 8268	15 7948	18 7963

	side bottom	Berm	10' from berm	notes
<del>8564</del>	19 8564	23 8647	33 8725	
<del>8344</del>	20 8341	26 8799	36 8776	
	21 8335	28 8752	48 8786	cut at sta 15-17
		old ditch 55 ft		deflection ditch
	25 8261	31 8694	41 8736	at 17-17
	25 8231	33 8693	43 8656	from S 2300'
				14+50
	28 8660	32 8209	38 8674	stake crossed ditch with 6' high of stake berm 12 ft
	86.18	original 30 ft SE of stake		
	20 8172	27 8527	38 8567	14-13 stake cross
	17 8160	26 8503	26 8577	both ditches to merge at stake
	22 8440	7	32 8510	
	20 8105	26 8410	26 8521	cut ditch deflects 2700' north to south at 14-13
	short cut	cut		new adds deflects 90.0° from W
	19 8077	25 8475	35 8518	
	22 7989	26 8534	36 8580	
	17 8008	19 8060	19 8376	at sta 17 deflection from S to W
	85.50			
	16 7992	22 8205	24 8239	190' to W
	21 7983	18 8272	36 8450	

stakes	Perm	S. No	CL
050+0	85.30	<sup>6</sup> 84.58	<sup>15</sup> 79.70
			79.20

S both Perm 10' Perm  
 458298 8305

17  
7968

Stake 6-5 deflection

from W to NW  
7800

St 5+35 ditch  
crosses Brimfield  
South line

<sup>7495</sup>  
Sta 5 cross Brimfield  
a line

Sta 10-9 deflection

ditch from W to 2700  
2W

St 5. deflection <sup>2500</sup>  
from 10W to W

shortcut 7-6

deflect from W to

SW

Sta 7-1

deflection <sup>at st.</sup>  
from NW  
to W

short cut at 3 to 2

Sta W 201