

H. C. K. S.

147

7

7

1005 W. Jeff. St  
St. Charles, Mo.  
Tel 105.

Lang Bridge

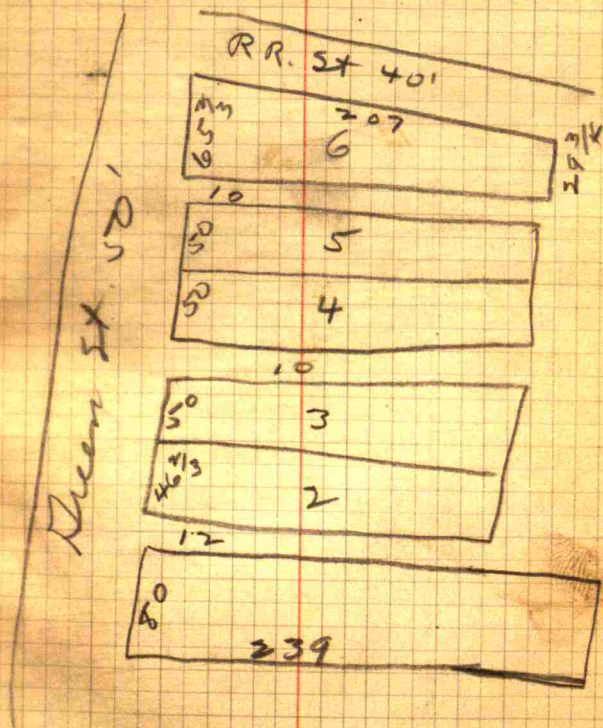

C. L. Hunt -  
 N. Green St, Brburg.

0+00 - Curl - 25.7' to  $\Phi$   
 2+28.4<sup>#</sup> - Manhole Def L - 4°-54'  
 4+24.5<sup>#</sup> - Manhole Def R 1°-5'  
 8+25.6<sup>#</sup> - Manhole Def R 0°-45'  
 9+10.3 South Rail of Switch on  $\Phi$   
 9+15.5 North " " "  $\Phi$   
 9+23.5 South Rail Main track on  $\Phi$   
 9+28.6 North " " "  $\Phi$   
 10+26 South Rail traction line "  $\Phi$   
 10+31.2 North " " " "  $\Phi$   
 11+29.1 Manhole 0°-2'  
 13+85.7 Manhole  
 9+23.5 = 75-20'  
 10+26 = 71°-12'  
 13+94 End of improvement.

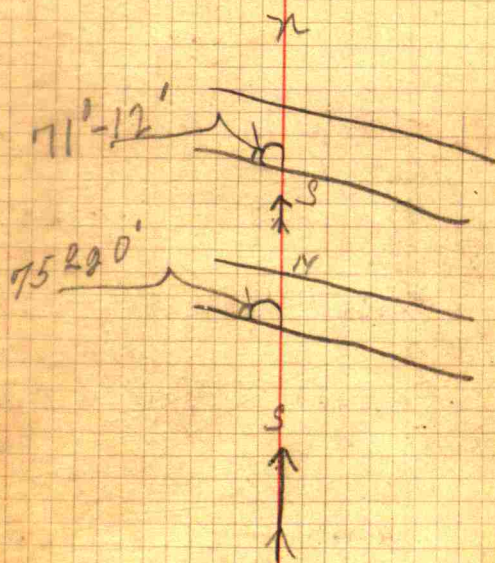

1111

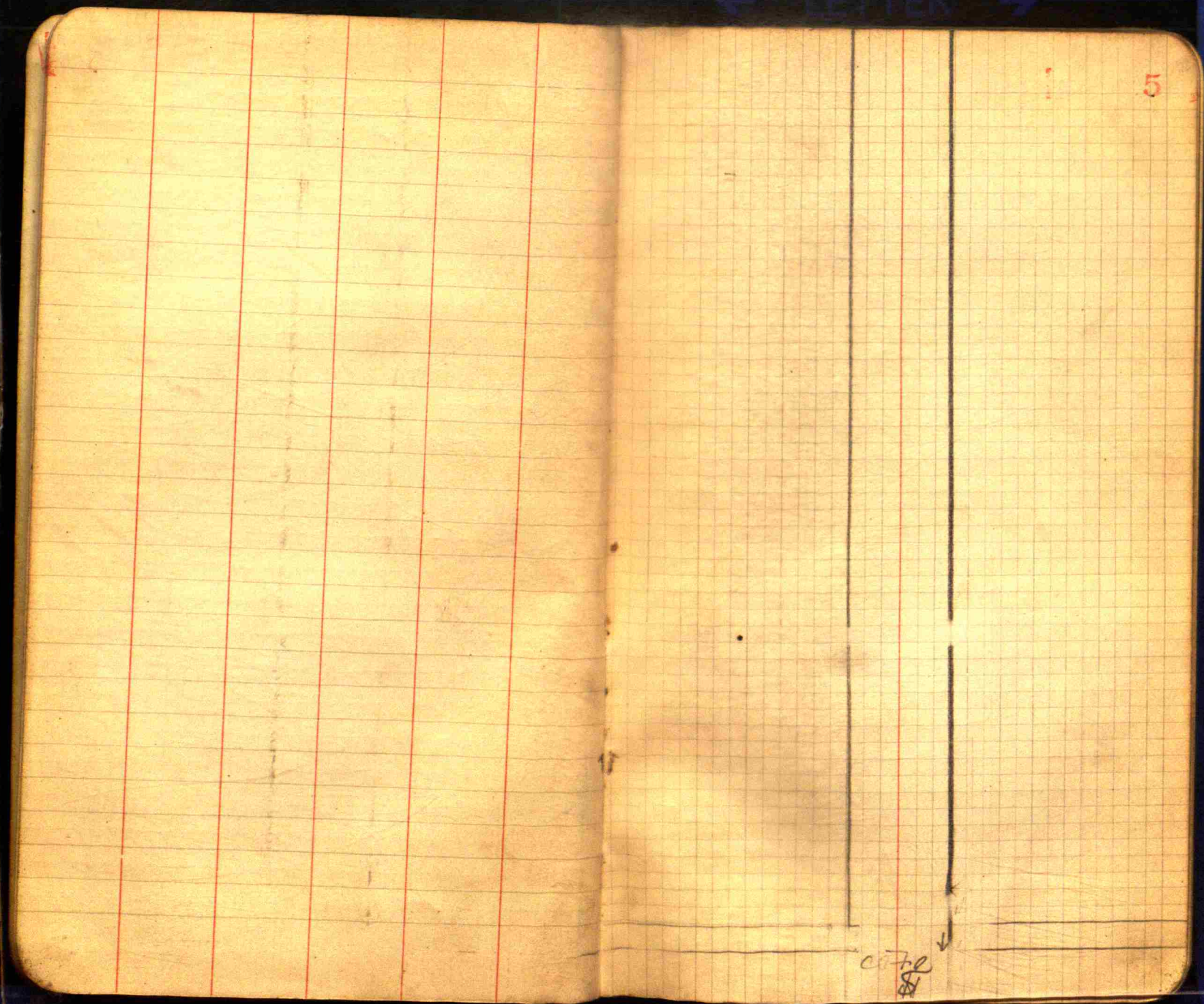

5

0720  
88

0+0 to 1+18 No curb on East  
 0+52 Pump East Side  
 1+00 Side walk 26' from Q  
 Walk 26' on East Side  
 54.9 between walks at 1+00  
 1+05.2 South edge of alley int  
 East  
 1+17.2 North Edge of alley int. East  
 1+18 South Edge of building East  
 1+07 North Edge of building West  
 and south edge of int. on West  
 1+18 North Edge of alley int. on West  
 1+52 Fire Plug on West 21.8 from h  
 1+50 width of street 46.7  
 1+50 West curb from center line 20.9  
 from Q  
 Curb 6'  
 East sidewalk 26.5 from Q  
 1+71 North Edge of building on East  
 1+89 Gas station on East 23.5 from  
 from Q  
 1+79 South Edge of Garage on East  
 2+15 South Edge of alley East & West  
 2+34 Telephone Pole on East 25' from Q  
 2+17 " " " West 22' " Q  
 47 feet between curbs  
 No curb on East from 0+0 to  
 2+42.4

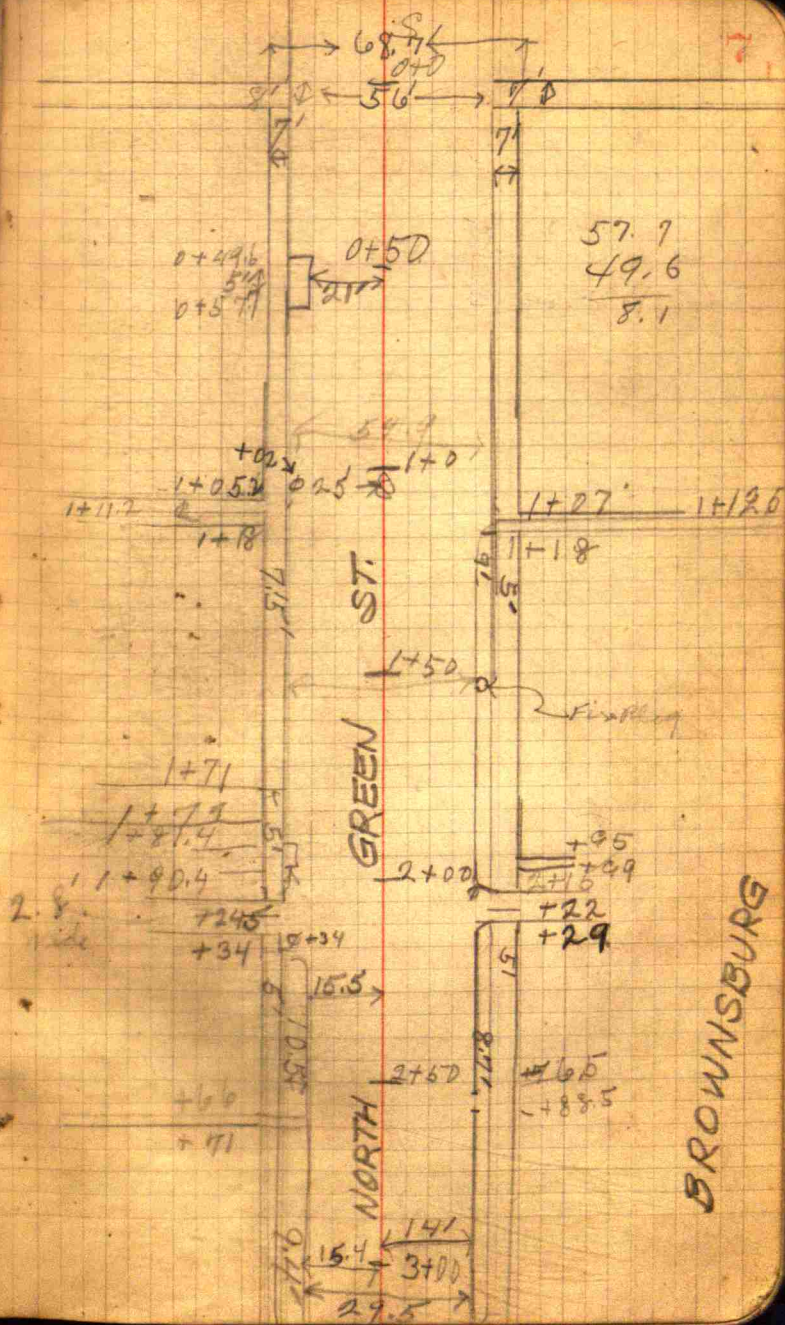

- 3+30 Telephone Pole
- 3+36 Catch basin on west face 12.8 from Q
- 4+24 " " on east
- 4+13 Curt ends on west side
- 4+06 North edge of side walk running west on south of Vermont St.
- 4+01 South edge of walk running west on Vermont St.
- 4+27 Curt ends on east. also that is south edge of intc.
- 4+39 North edge of intc. on east
- 4+24 face of basin at station is 14 feet 3 inches from Q
- 4+36 south edge of walk on north side of Vermont St.
- 4+41 north edge of walk on north side of Vermont St.
- 4+45.2 fire plug 17 feet from Q
- 4+40 break in curb on west
- 4+52 N " " " " "
- 5+46 break in curb on west
- 5+59 " " " " "
- 6+7.4 Telephone pole 15' from Q

E

W 9

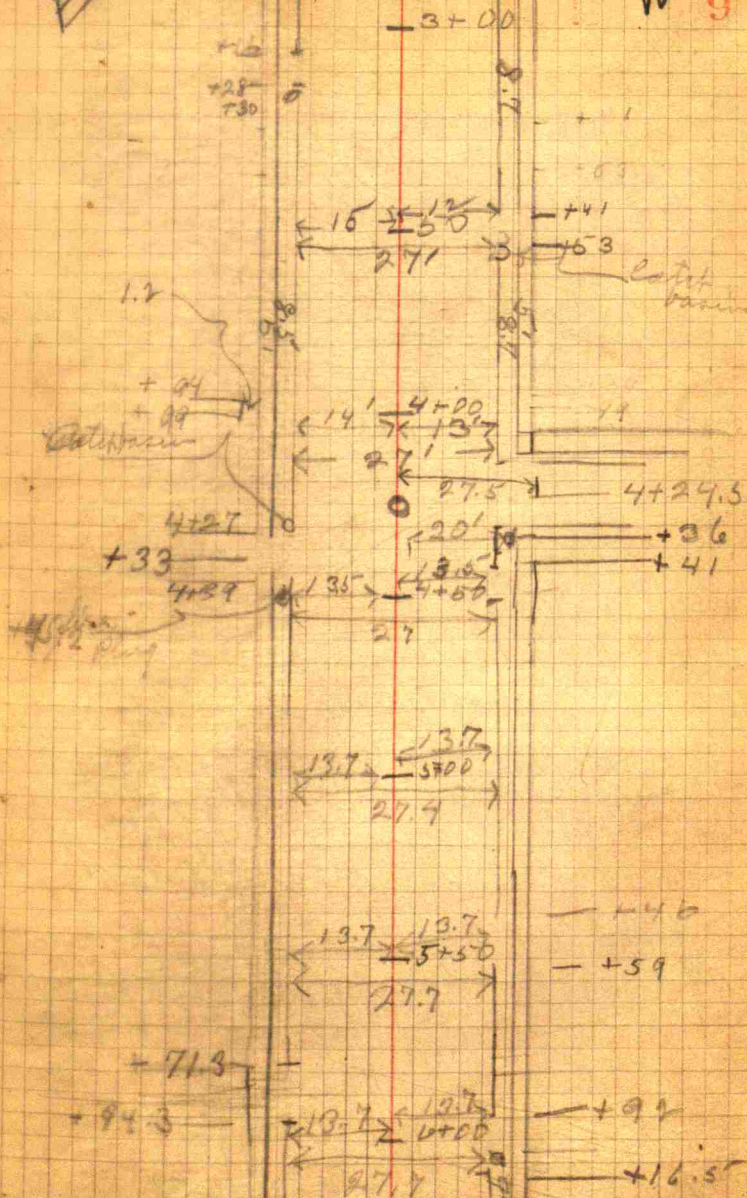

6+28 face of catch basin on East 14.6  
from  $\Phi$

6+28 face of catch basin on West 14.5  
from  $\Phi$

6+52 telephone pole on West 21' from  $\Phi$

6+52.5 South edge of break in curb on West

6+29 South edge of break in curb on West

6+89 South edge alley cut on East

7+02 north " " " "

7+36 telephone pole on West 20.8' from  $\Phi$

7+48 south break in curb on West

7+60.5 North " " " "

8+00.5 catch basin on East 14.5 feet from  $\Phi$

8+03.5 Fire Plug

8+04.5 Walk (North side) running East

8+08.5 " (North side) " "

8+06 telephone pole 20.5' from  $\Phi$

7+97.5 break in curb on West

8+09 " " " "

8+18 catch basin on West side 15.2' from  $\Phi$

8+38 street inter East ends

8+50 telephone pole on West 22.5' from  $\Phi$

8+57 South Edge of gutter on West

8+57.5 South Edge of gutter on East

8+65.5 North " " " "

9+78.5 telephone pole 35' from  $\Phi$

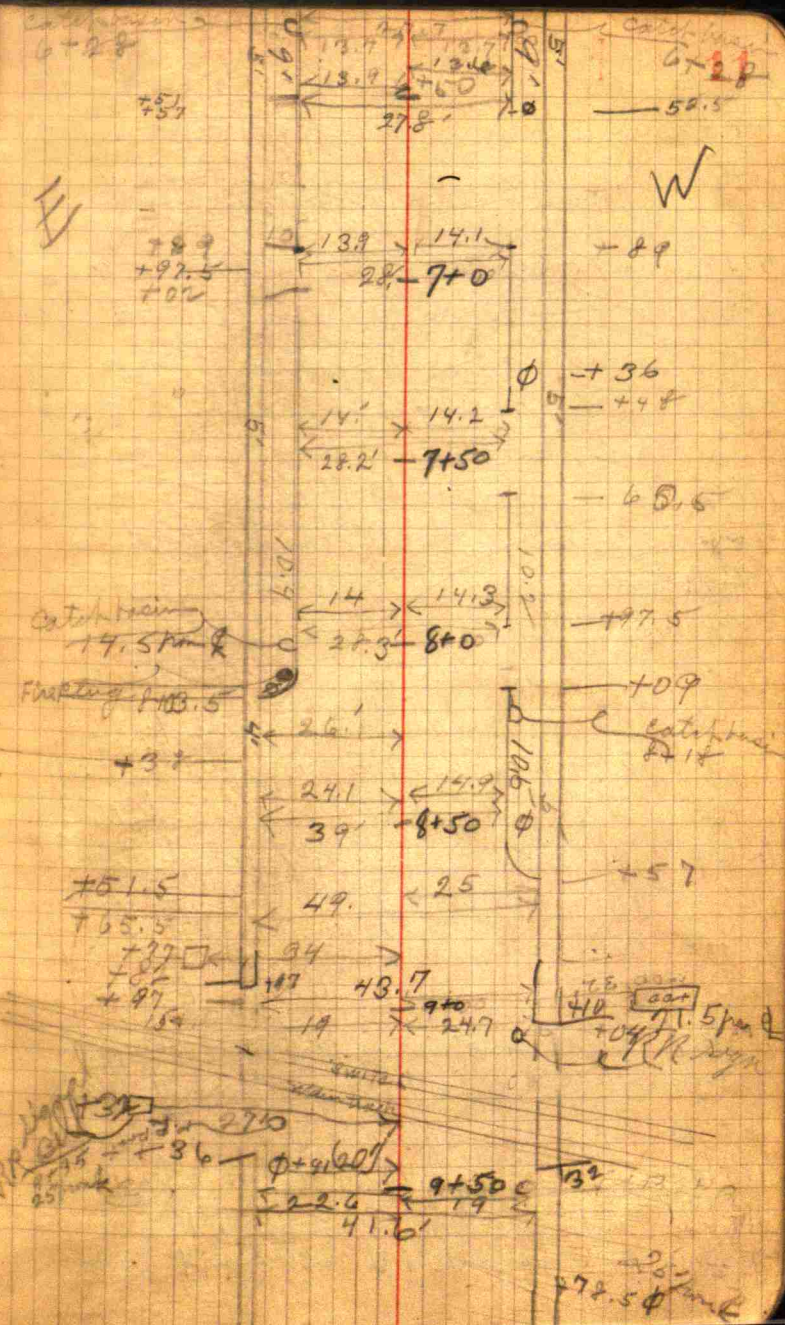

- 8+82 North edge of Inters on West  
 8+82 South edge of Inters on East  
 8+94 North edge of Inters on  
 9+04 R.R. Sign 21.5 feet from L  
 9+10 to 9+32 No side walk on West  
 8+97 to 9+36 No side walk on East  
 9+88 South edge of traction bldg.  
 between 9+50 + 10+00 make right an  
 intere for tract. a d Railroad.  
 10+18 Prop. line on West  
 10+12.8 side walk on East ends  
 10+21 side walk ends on West.  
 10+26.8 side walk on East begins  
 10+34 " " " West. "  
 10+46 telephone pole 14.7' from L  
 10+65 18" maple 17.5 feet from E.S.  
 10+65 12" " 14. " " E.W.S.  
 10+87 18" " 16.5 " " E.S.  
 10+87 12" " 15. " " E.V.S.  
 11+12 24" " 16 " " E.S.  
 11+25 18" " 16 " " E " "  
 11+31 8 feet int on East driveway  
 11+33 12" maple 14.5 feet from E.W.S.  
 11+36 18" " 16.5 " " E.S.  
 11+63 20" maple 16.5 " " E " "  
 11+68 telephone pole West side 14' from L  
 11+90 18" maple 16 feet from E.S.

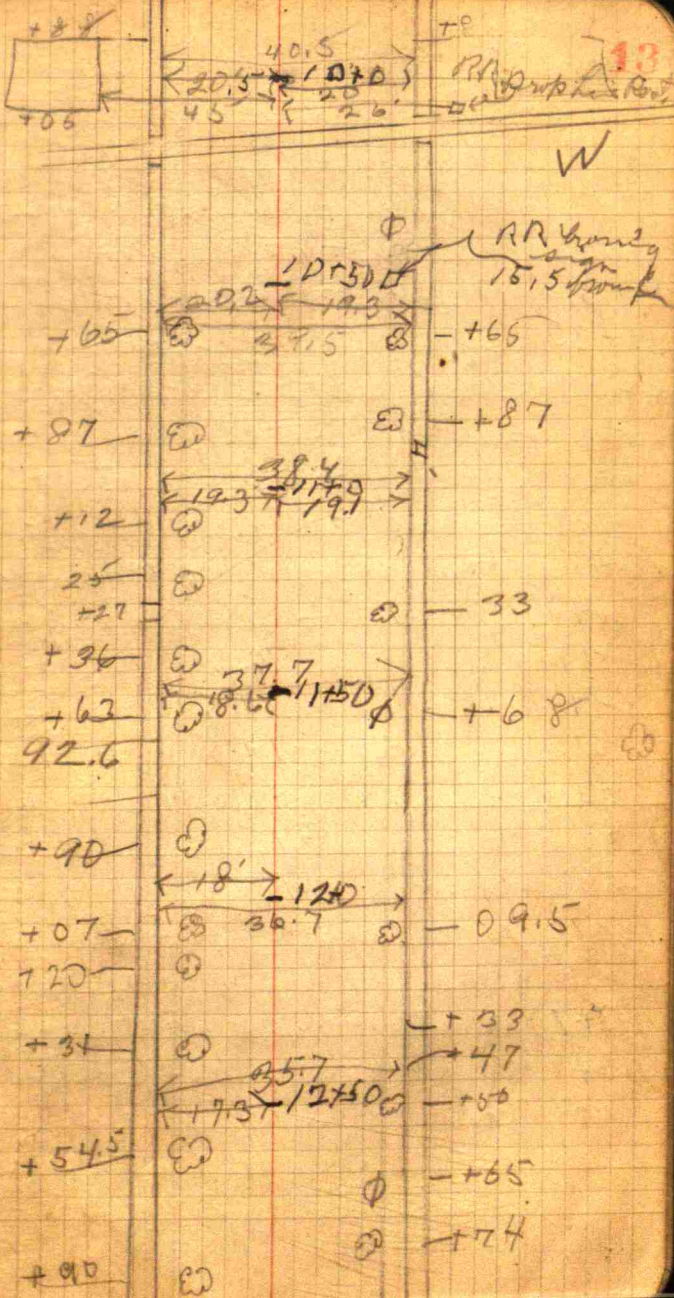



from 11+92.6 to 12+05 alley  
on East side

- 12+07 Maple 24" - 14.5 feet from E.S.  
12+09 " 10" - 13.5 " " W.S.  
12+20 " 20" - 15 " " E.S.  
12+31 " 24" - 15 " " E.S.  
12+33 South edge of front on West  
12+47 North " " " "  
12+50 Maple 10" - 14.9 feet from W.S.  
12+54 Maple 26" - 15.5 " " 2 m.E.S.  
12+74 " 8" - 14.4 " " E. side  
12+65 telephone pole 14.9 feet from E.  
12+90 Maple 24" - 15 feet from E.S.  
13+12.5 " 18" 12.6 " " W.S.  
13+14.5 " 24" - 14.5 " " E.S.  
13+25.5 " 20" - 14.5 " " E.S.  
13+30 " 24" 12.6 " " W.S.  
13+60 " 6" - 15 " " W.S.  
13+62 " 30" 13 " " E.S.  
13+71 fire plug on East side 13 feet from E.  
13+74 to 13+86 inters on West  
13+77 south side of street on East  
13+78 curb on south of street East  
13+91.5 telephone pole 15 feet from E. on West

E

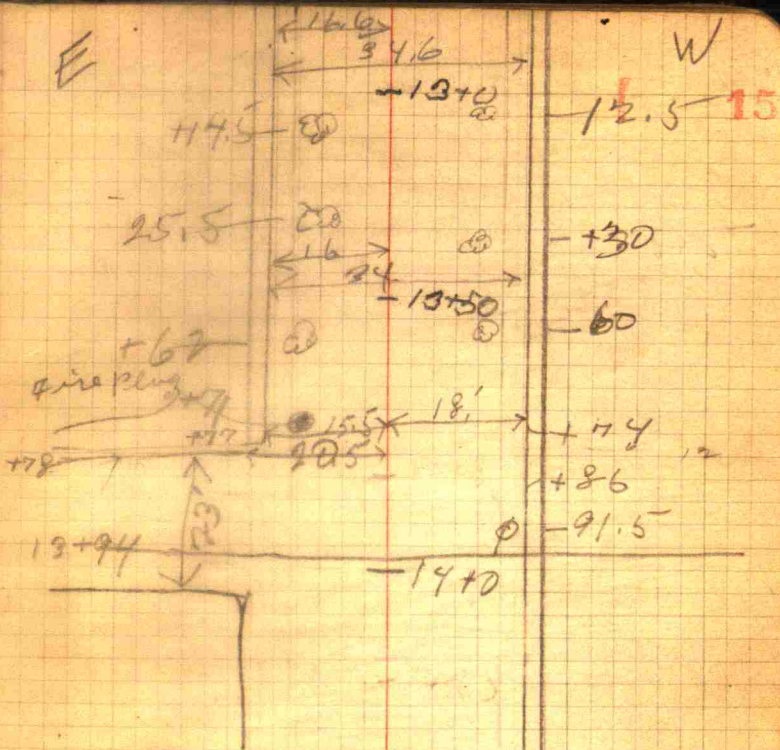

East Levels N. Green St Brownsburg West.

Sta.	Edge of Side Walk	Ground	Top Curb	Gutter	Top Gutter	Curb	Ground	Edge of Side Walk
0-28		232.61	26'	233.00	232.75		233.25	26'
0+00		232.17	2.5'	232.77			232.75	
0+50	232.25	232.17	2.1'	231.99	232.61		232.64	29'
1+00	232.84	232.59	2.0'	232.46	232.72		233.00	28.5'
	Gutter -	232.46		232.46	232.72		233.00	28.5'
	Alley -	232.90		232.80			233.66	
1+50	233.11	232.72	14.5'	232.73	232.69	232.52	233.20	
2+0	233.23	233.14	1.5'	233.10	233.23	232.56	233.21	
	Gutter -	233.30	17'					
	Side Walk -	233.55	29'	233.20				
	Street -	233.85	35'					
2+50		233.48		233.46	233.06	233.40	232.84	233.22
	Top Manhole -	233.48						234.10
	Gutter -	232.70	15.5'					
	Ground -	233.79	20'					
	Side Walk -	234.40	25'					
3+00	233.65	233.31	15.5'	232.74	233.06	232.71	233.19	
	Gutter -	232.74	15'					
	Ground -	233.18	19'	233.08				
	Side Walk -	233.58	24'					
	Alley -	233.38	36'					
3+50	233.72	233.33	15.5'	232.75	232.85	232.76	233.60	
	Gutter -	232.74	15'					
	Ground -	233.18	19'					
	Side Walk -	233.58	24'					
	Alley -	233.38	36'					
4+00	233.72	233.24	14.5'	232.76	233.12	232.84	233.37	
	Top Catch Basin - W -	233.07						
	Top Manhole -	232.82						
	Top Catch Basin - E -	232.79						
	Gutter -	232.69	12.5'					
	Ground -	233.26	16.5'	233.10				
	Side Walk -	233.64	22'					
	Alley -	233.39	32'					
W. Vermont St.	Gutter -	233.39	13'	233.14				
	Int. -	234.31	24.5'					
	St. -	234.37	27.5'					

BM. A8  
 Sta. 0+00  
 El. 232.20  
 in front of  
 Harmon's Hallett  
 Drug Store at  
 intersection of  
 Main & Green St.  
 Cor. of sidewalk  
 (23)  
 (23)  
 (36)  
 (23)  
 (36)  
 (23)  
 (36)  
 (36)  
 (36)  
 (36)  
 (36)  
 (36)  
 (36)  
 (36)

E Curb at  
 Sta. 4+30  
 233.17

Std	Edge	East			♀	West		
	Sidewalk	Ground	Top of Curb	Gutter		Gutter	Top of Curb	Ground Sidewalk
	Break in W. Curb			Gutter - 232.81 - 13				232.88
				Ground - 233.93 - 11				
				Sidewalk - 234.50 - 22				
4+50	233.70	13.5	13	232.66	233.05	232.87	233.30	
5+00	233.55	14.5	14	232.56	232.94	232.54	233.10	234.20
5+50	233.53	14.5	14	232.42	232.77	232.50	233.06	234.09
		Drive W side						
		Gutter - 232.50 - 13.5						
		Ground - 233.63 - 15.5						
		Walk - 234.09 - 23						
		Alley - E side						
		Gutter - 232.51 - 14						
		Ground - 232.74 - 18						
		Walk - 233.24 - 24						
		Alley - 232.96 - 35						
6+0	233.76	13.5	13	232.63	232.91	232.72	232.95	233.94
		Two Drives W side - Together						
		Gutter - 232.32 - 14						
		Ground - 233.30 - 15.5						
		Walk - 233.94 - 23						
		Top Catch Basin - W side - 232.55						
		Top Catch Basin - E side - 232.63						
6+50	233.35	14.5	14	232.51	232.80	232.73	232.91	234.01
		Drive - W side						
		Gutter - 232.32 - 14						
		Ground - 233.39 - 15						
		Walk - 234.01 - 24.5						
7+00	233.30	14.5	14	232.41	232.86	232.77	232.86	234.14
		Drive E						
		Gutter - 232.40 - 14						
		Ground - 232.82 - 19						
		Walk - 233.30 - 22						
7+50	233.22	14	13.5	232.20	232.60	232.70	232.77	233.94
		Drive W						
		Gutter - 232.10 - 13.5						
		Ground - 233.10 - 18						
		Walk - 233.94 - 25						

Sta.	East				West			
	Sidewalk	Ground	Top of Curb	Gutter	Gutter	Top of Curb	Ground	Sidewalk
8+00	233.16 <sup>20</sup>		232.97 <sup>14.5</sup>	232.09 <sup>14</sup>	232.51 <sup>13</sup>	232.30 <sup>13.5</sup>	233.00	233.78 <sup>24.5</sup>
	Top Catch Basin, E. - 232.72 <sup>(6)</sup>							
	Drive W. side							
	Gutter - 232.30 - 13							
	Ground - 233.28 - 18.5							
	Walk - 233.78 - 24.5							
	Catch Basin, W side - 232.66							
8+25	Top of Manhole - 232.89							
	Street E.							
	Gutter line - 232.80 - 14							
	Walk line - 233.14 - 28							
	Street East - 233.52 - 42							
8+50	233.43 <sup>24</sup>	233.35 <sup>24</sup>	233.09 <sup>13</sup>	232.71 <sup>13</sup>	232.50 <sup>15</sup>	233.00 <sup>15.5</sup>		234.00 <sup>20</sup>
	Alley, W-side							
	Gutter - 233.05 - 15'							
	Walk - 233.57 - 25'							
	Alley - 233.80 - 35'							
	Ground - 233.11 - 19'							
	Drive - E -							
	Gutter - 234.14 - 19'							
	Walk - 234.14 - 22'							
	Drive - 234.34 - 34'							
9+00	234.52 <sup>25</sup>		234.53 <sup>15</sup>	234.31 <sup>15</sup>	234.20 <sup>13</sup>		233.94 <sup>25</sup>	
	Railroad Crossing							
10	S. Rail of Switch - 234.80							
15	N. Rail of Switch - 234.76							
23	S. Rail of Main Track - 235.22							
28	N. Rail of Main Track - 235.17							
9+50	234.22 <sup>18.5</sup>		234.11 <sup>35</sup>	234.15 <sup>12</sup>	234.11 <sup>15</sup>		234.18 <sup>23</sup>	
	Drive to RR Sta. W. 233.65							
	Drive to T.H.I. + E. Sta. 233.70 31'							

B.M. 1192

Step of  
Bldg. S. of R.R.  
234.58

Start

Sta.	East				West		25
	Sidewalk	Ground	Top of Curb	Gutter	Gutter	Ground	
10+0	233.74 <sup>20.5</sup>			233.65 <sup>13.5</sup>	233.02 <sup>16.5</sup>		233.01 <sup>22</sup>
	S. Rail of Trac. - 233.52						
	N. Rail of Trac. - 233.79						
10+50	233.00 <sup>20</sup>	233.08 <sup>18.5</sup>		232.85 <sup>14</sup>	233.35 <sup>11.5</sup>	233.00 <sup>19</sup>	233.10 <sup>20</sup>
11+0	233.80 <sup>19</sup>	233.59 <sup>20</sup>		233.11 <sup>11</sup>	233.10 <sup>11.5</sup>	232.58 <sup>18.5</sup>	232.70 <sup>18.5</sup>
	Drive E						233.71
	Gutter - 233.50 - 13'						
	Walk - 234.40 - 19'						
	Top Manhole - 234.21						
11+50	234.67 <sup>20</sup>	234.65 <sup>19</sup>		233.61 <sup>12.5</sup>	233.89 <sup>10</sup>	233.72 <sup>18</sup>	233.68 <sup>19</sup>
12+0	235.26 <sup>19.5</sup>	234.99 <sup>16.5</sup>		234.36 <sup>12.5</sup>	235.32 <sup>11</sup>	234.25 <sup>8</sup>	234.43 <sup>18.5</sup>
	Drive E						B.M. #3
	Gutter - 234.36 - 12.5'						on.
	Walk - 235.26 - 18.5'						Arrow
	Drive W.						on top of
	Gutter - 234.93 - 12'						Fire plug
	Walk - 234.83 - 15'						Sta 13+71
	Ground - 234.71 - 17.5'						
12+50	235.55 <sup>17.5</sup>	235.50 <sup>17</sup>		234.89 <sup>13.5</sup>	235.61 <sup>11.5</sup>	234.86 <sup>17</sup>	235.00 <sup>17.5</sup>
13+0	235.32 <sup>17</sup>	235.30 <sup>16.5</sup>		235.16 <sup>12</sup>	235.72 <sup>12</sup>	235.09 <sup>17.5</sup>	235.19 <sup>16</sup>
13+50	235.37 <sup>16</sup>	235.33 <sup>15.5</sup>		235.26 <sup>11.5</sup>	235.94 <sup>11</sup>	235.35 <sup>17</sup>	235.34 <sup>17.5</sup>
	Top Manhole - 236.22						
	Drive W.						
	Gutter - 235.68 - 13.5'						
	Walk - 235.45 - 18'						
13+94	235.98 <sup>34</sup>	236.14 <sup>16</sup>		236.26 <sup>10.5</sup>	236.20 <sup>12.5</sup>	235.82 <sup>17</sup>	235.61 <sup>17</sup>
	Sta. 5 East						
	25' N. on $\phi$ - 235.84						

B.M. #3  
on.  
Arrow  
on top of  
Fire plug  
Sta 13+71

El. 237.83

B.M. on  
Top step  
S.E. cor.  
Catholic Ch  
El. 238.32

# H. Green St. Cut Sheet

Fin. Pavt. sub. cd stk-w. cut.

13+94	235.50	234.83	236.33	1'-6"
13+50	235.28	234.61	235.86	1'-3"
13+0	235.03	234.36	235.36	1'-0"
12+50	234.78	234.11	235.61	1'-6"
12+0	234.28	233.61	234.61	1'-0"
11+50	233.78	233.11	234.11	1'-0"
11+0	233.16	232.49	232.99	0'-6"
10+50	234.15	233.48	233.48	Gd.
10+0	233.06	232.39	233.70	1'-4"
9+50	234.56	233.89	234.89	1'-0"
9+0	234.96	234.29	234.54	0'-3"
8+50	233.46	232.79	233.79	1'-0"
8+0	233.30	232.62	233.85	1'-3"
7+0	232.96	232.28	233.70	1'-5"
6+0	232.79	232.11	233.61	1'-6"
5+0	233.12	232.44	233.94	1'-6"
4+0	233.30	232.62	234.40	1'-9"
3+0	232.96	232.28	234.30	2'-0 1/2"
2+0	232.63	231.95	234.00	2'-1"
1+0	232.30	231.62	233.65	2'-0 1/2"
0+0	232.63	231.95	233.60	1'-8"

M.H. -13+85 - Fin. Pavt. 235.45  
M.H - 11+29 - Fin. Pavt - 233.45  
M.H - 8+25.6 - Fin. Pavt. 233.38

C.B. -10+75

C.B. -10+11

23429  
23  
23361  
23211  
23454

23400  
23195  
205  
23271

23394  
23244  
23249  
23461  
125  
23586  
23483  
150  
23633

23370  
23239  
131  
23360  
23195  
165  
23411  
150  
23385  
23262  
123

23440  
23262  
178  
23561  
23338  
23275  
63

23365  
23162  
203  
23410  
58  
16  
23430  
23228  
202  
23622

23370  
23228  
142

74. Plainfield - Mooresville Road

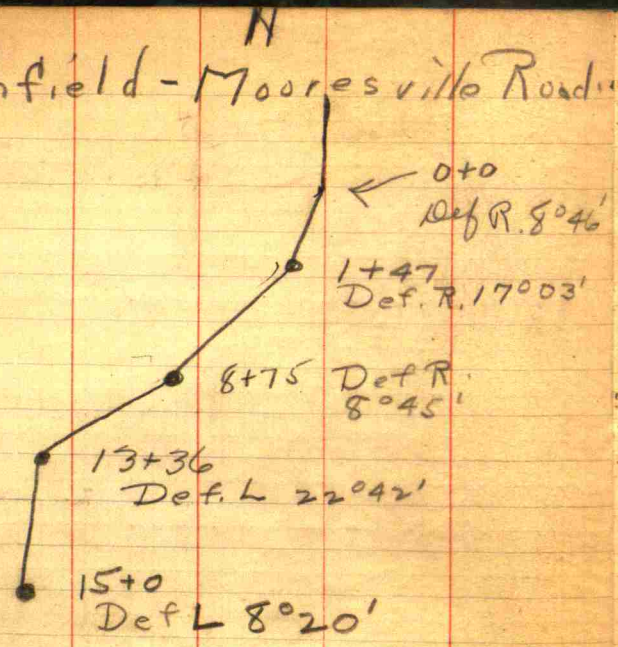

W/P  
P/V

W

E

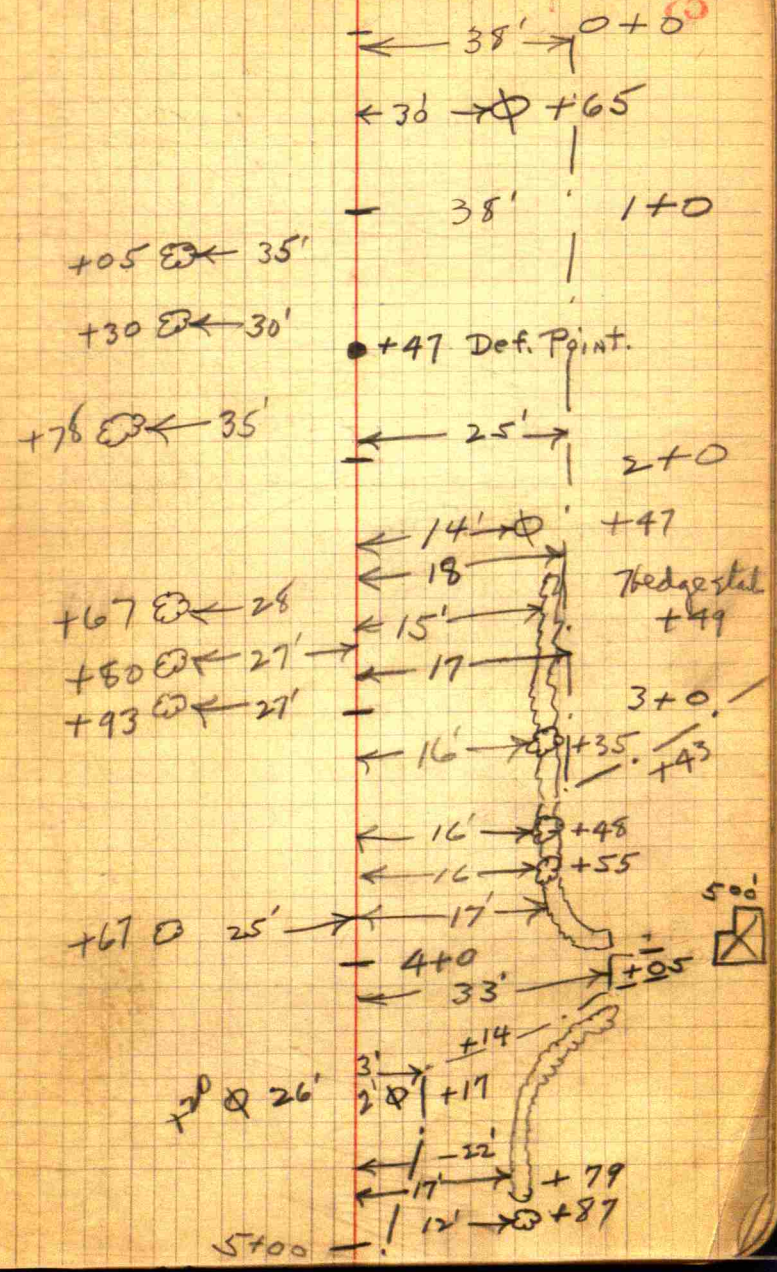

76

Culvert. 6+03

E. end is 4' W of E  
Iron pipe 29' long.

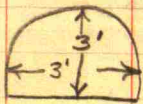

End Sec.

new E  
5' W Culvert. 7+97

Same as other only  
24' long.

2' W new  
Culvert. Vit. Tile 24"  
9+27.5 - 24' long

2' E new  
11+12 12' of 24" Vit. tile

W

E

5+00

6+00

+16 E ← 35'

4+41

7+0

25' E +74

26' E +78

+93

22' E +93

25' E +94

8+0

12' E +28

6' E +32

E +39

← 40' E +70

E +95

Dep. Point 8+75

9+0

+16 E ← 28'

5' E +17

+11

E +42

10+0



L 78

W

E

10+0 79

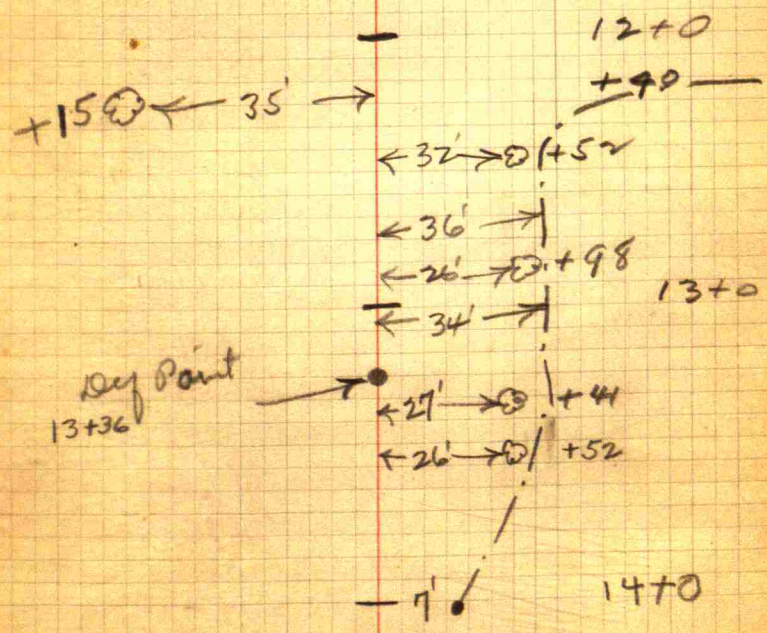
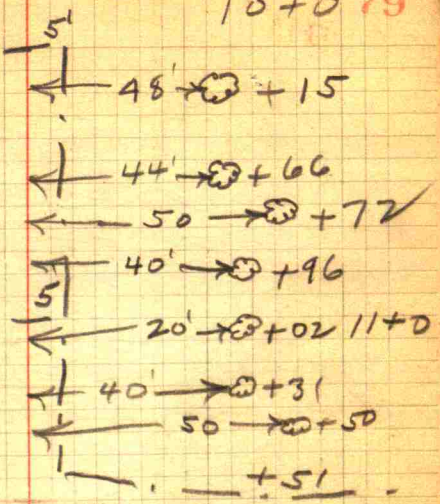

80

Distance of E. of old road  
from E. of new road.  
Edd.

Sta.	Edd.
0+0	Same
1+0	4' W
1+47	5' W
2+0	4' W
3+0	5.5' W
4+0	10' W
5+0	15' W
6+0	18' W
7+0	18' W
8+0	18' W
8+75	18' W
9+0	16' W
10+0	
11+0	11' W
12+0	11' W
13+0	Same
13+36	6' E
14+0	5' W
15+0	

W.

E.

81

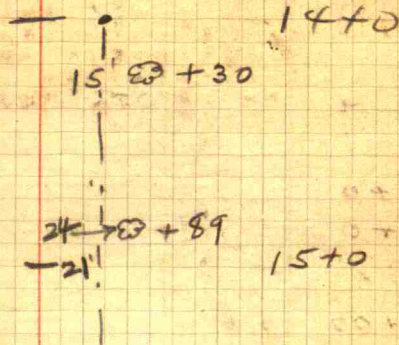

Sta.	STK.	18	9	Level	5.	10	21	STK	E
0-1		102.50	104.11	104.33	10386	101.50			
0+0	107.37 <sup>28</sup>	105.74	107.56 <sup>9</sup>	108.12	10780 <sup>10</sup>	106.43 <sup>17</sup>	107.22	113.25 <sup>29</sup>	
1+0 down	114.50 <sup>34</sup>	109.64	109.27 <sup>18</sup>	110.57 <sup>9</sup>	11120 <sup>11</sup>		109.99	109.56 <sup>27</sup>	115.50 <sup>30</sup>
1+47	112.17 <sup>114.53</sup>	112.29 <sup>23</sup>	112.53 <sup>15</sup>	112.87 <sup>5</sup>	11260 <sup>7</sup>	111.42 <sup>16</sup>	113.22 <sup>15</sup>	116.04 <sup>25</sup>	104.31
2+00	113.31 <sup>22</sup>	113.83	114.46 <sup>12</sup>	114.75 <sup>4</sup>	11469 <sup>6</sup>	113.68 <sup>15</sup>	115.93		113.00
3+00	113.44 <sup>24</sup>	113.99	114.61 <sup>14</sup>	115.12 <sup>5</sup>	11552 <sup>4</sup>	11425 <sup>5</sup>	115.26	115.35 <sup>25</sup>	107.54
4+00	111.20 <sup>27</sup>	110.24		110.33 <sup>10</sup>	110.93 <sup>5</sup>		112.00	112.17 <sup>23</sup>	99.10
5+00	101.40 <sup>31</sup>	102.82	102.91 <sup>15</sup>	102.75 <sup>7</sup>	102.24		105.93	106.11 <sup>30</sup>	99.87
5+30	98.42 <sup>30</sup>	101.16 <sup>25</sup>	101.43 <sup>17</sup>	101.34 <sup>10</sup>	97.52	97.25 <sup>10</sup>	96.94 <sup>20</sup>	96.90 <sup>30</sup>	105.39
6+00	96.50 <sup>30</sup>	99.13	99.17 <sup>18</sup>	98.66 <sup>10</sup>	92.40	95.19	95.84	95.79 <sup>30</sup>	97.90
6+03	86.50 <sup>20</sup>	90.00 <sup>10</sup>		91.20 <sup>9</sup>	91.69				97.55
6+50	95.80 <sup>30</sup>	99.02 <sup>24</sup>	98.65 <sup>19</sup>	97.00 <sup>12</sup>	100.25	102.81 <sup>5</sup>	102.75 <sup>10</sup>	102.50	103.00 <sup>30</sup>
7+00	97.63 <sup>32</sup>	99.06 <sup>20</sup>	99.34 <sup>13</sup>	99.30 <sup>7</sup>	104.22	107.01 <sup>9</sup>		116.01	113.09 <sup>25</sup>
7+50	95.83 <sup>32</sup>	98.00 <sup>20</sup>	97.80 <sup>13</sup>	97.55 <sup>7</sup>	99.12	103.57 <sup>20</sup>	106.86 <sup>33</sup>		109.83 <sup>45</sup>
7+97	94.90 <sup>21</sup>	97.31 <sup>18</sup>	97.52 <sup>12</sup>	90.08 <sup>6</sup>					
8+0	FI.W 82.00	97.31	97.52	90.08					
8+75	97.90 <sup>27</sup>	97.77 <sup>20</sup>	97.63 <sup>10</sup>	95.90 <sup>6</sup>	93.84	94.74 <sup>10</sup>		94.87	95.05 <sup>30</sup>
9+0	95.20 <sup>27</sup>	97.59 <sup>6</sup>	97.41 <sup>3</sup>	96.10 <sup>3</sup>	96.15	98.86 <sup>10</sup>		100.70	104.70 <sup>30</sup>
9+27.5	97.48 <sup>14</sup>	97.61 <sup>6</sup>	96.74 <sup>18</sup>	95.00 <sup>2</sup>	96.91	98.06 <sup>10</sup>		98.66	99.70 <sup>30</sup>
10+00	95.26 <sup>27</sup>	96.49 <sup>20</sup>	97.08 <sup>3</sup>	97.07 <sup>3</sup>	96.61	97.54 <sup>10</sup>		98.79	101.57 <sup>30</sup>
11+08	95.76 <sup>18</sup>	102.53 <sup>30</sup>	99.56 <sup>20</sup>	94.16 <sup>2</sup>	94.96	94.59 <sup>11</sup>	95.57	94.50	95.25 <sup>18</sup>
11+12	95.63 <sup>11</sup>	95.70 <sup>3</sup>	94.31 <sup>TOP</sup>	93.39 <sup>FI.E</sup>					91.79 <sup>40</sup>
24' long	93.32 <sup>FI.W</sup>	92.64 <sup>24</sup>	95.21 <sup>30</sup>						

B.M. 83  
 on So.  
 End of  
 W. rail  
 of bridge  
 Clarks Creek  
 El. 100.00

104.31  
 113.00  
 107.54  
 99.10  
 99.87  
 105.39  
 97.90  
 97.55  
 95.62  
 94.87  
 95.05  
 100.70  
 104.70  
 98.66  
 99.70  
 98.79  
 101.57  
 103.53  
 95.25  
 91.79  
 Sta  
 reversed

down	<sup>30°</sup>	STK	<sup>11</sup>	<sup>4</sup>	<sup>4</sup>	<sup>10</sup>
12+0	94.59 <sup>25</sup>	94.75	94.93 <sup>11</sup>	94.87 <sup>4</sup>	95.59	97.86 <sup>10</sup>
13+0		89.90 <sup>17</sup>	91.50 <sup>13</sup>	92.33 <sup>10</sup>	92.45	92.77 <sup>11</sup>
13+36				90.68 <sup>6</sup>	91.07	91.24 <sup>7</sup>
14+0	87.02 <sup>7 7</sup>	87.64 <sup>6</sup>	89.85 <sup>11</sup>	90.03 <sup>5</sup>	89.96	90.12 <sup>3</sup>
15+0	86.79 <sup>18</sup>	87.02 <sup>13</sup>	87.73 <sup>10</sup>	88.80 <sup>7</sup>	89.12	89.11 <sup>9</sup>
16+0					88.79	
17+0					88.62	

	<sup>20</sup>	40	49	
	99.16	101.28	102.00	
	92.21 <sup>6</sup>	95.86 <sup>20</sup>		up 20°
	91.28 <sup>12</sup>	91.22 <sup>17</sup>	93.77 <sup>20</sup>	95.77 <sup>33</sup>
	89.24 <sup>6</sup>	91.03 <sup>11</sup>	94.50 <sup>20</sup>	up 30°
	88.26 <sup>15</sup>	89.82 <sup>20</sup>		up 10°

1400

Gutter  
Line

13+94	235.28		
13+90	235.26		
13+70	235.16	✓	✓
13+50	235.06	✓	✓
13+30	234.96	✓	✓
13+10	234.86	✓	✓
12+90	234.76	✓	✓
12+70	234.66	✓	✓
12+50	234.56	✓	✓
12+30	234.36	✓	✓
12+10	234.16	✓	✓
11+90	233.96	✓	✓
11+70	233.76	✓	✓
11+50	233.56	✓	✓
11+30 <sup>MA</sup>	233.36	✓	✓
11+10	233.16	✓	✓
10+90	232.96	✓	✓
10+75 <sup>KL</sup>	232.81	✓	✓
10+70	232.96	✓	✓
10+50	233.56	✓	✓
10+45	233.91		
10+40	233.86	✓	
10+35	233.76		

1401

1400  
 13+94  
 13+90  
 13+70  
 13+50  
 13+30  
 13+10  
 12+90  
 12+70  
 12+50  
 12+30  
 12+10  
 11+90  
 11+70  
 11+50  
 11+30  
 11+10  
 10+90  
 10+75  
 10+70  
 10+50  
 10+45  
 10+40  
 10+35

13+94  
 13+90  
 13+70  
 13+50  
 13+30  
 13+10  
 12+90  
 12+70  
 12+50  
 12+30  
 12+10  
 11+90  
 11+70  
 11+50  
 11+30  
 11+10  
 10+90  
 10+75  
 10+70  
 10+50  
 10+45  
 10+40  
 10+35

232  
5  
232  
450

32

15

17

05

8+50	233.35	2		
8+40	233.30	233.05	✓ 4+50	232.90
8+20	233.20	232.95	✓ 4+30	233.00
8+00	233.10	232.85	✓ 4+25	233.01
7+80	233.00	232.75	✓ 4+05	232.82
7+60	232.90	232.65	✓ 3+85	233.82
7+40	232.80	232.55	✓ 3+65	233.92
7+20	232.70	232.45	✓ 3+45	233.85
7+00	232.60	232.35	✓ 3+25	233.85
6+80	232.50	232.25	✓ 3+05	233.84
6+60	232.40	232.15	✓ 2+85	233.94
6+40	232.30	232.05	✓ 2+65	232.94
> 6+20	232.22	232.00	✓ 2+45	232.90
6+10	232.30	232.10	2+35	232.82
5+90	232.40	232.20	2+25	232.80
5+70	232.50	232.30	2+15	232.76
5+50	232.60	232.40	1+95	232.69
5+30	232.70	232.50	1+75	232.62
5+10	232.80	232.60	1+55	232.55
4+90	232.90	232.70	1+35	232.48
4+70	233.00	232.80	1+15	

1+12 - 233.00

0+00 - 232.20

1+20	232.43	✓	
1+14	232.40		
1+00	232.48		232.44 L
0+80	232.55		232.50 L
0+60	232.62		232.56 L
0+40	232.69		232.62 L
0+20	232.76		232.68 L
			232.74 L

E. side

wh

0+04	231.89	-10035	900.95	✓
0+20			101.04	✓
0+40			101.09	✓
0+60			101.17	✓
0+80			101.25	
1+00	232.86	101.80	101.33	
1+20				
1+40				
1+60				
1+80				
2+00				
2+07				
2+20				
2+35				

Cl

101.45	✓
101.03	✓
101.13	✓
101.23	✓
101.33	✓
101.43	✓
101.50	✓
101.57	✓
101.64	✓
101.71	✓
101.75	✓
101.80	✓
101.85	✓
101.91	✓

.10  
26  
35.10  
100  
5  
4.20  
231.89  
14.1  
232.30

1.35  
1.35  
35  
6.40  
40.5  
47.20  
232.73  
33  
232.40

232.83  
47  
36

50  
43  
3  
1.35  
1.07  
945

101.91  
101.43

135	480	0036
	405	
	750	
	810	

	Qutter	Wutter	±	Crone	
Sta 0+00	7.74	8.80	8.27	8.62	✓
0+20				8.61	✓
0+40				8.60	✓
0+60				8.59	✓
0+80				8.58	✓
1+00				8.57	✓
1+20	8.26	8.20	8.23	8.56	✓
1+40				8.63	✓
1+60				8.70	✓
1+80				8.77	✓
2+00				8.84	✓
2+20	8.53	8.53	8.53	8.91	✓
2+40				8.95	✓
2+60				8.99	✓
2+80				9.03	✓
3+00		8.74		9.07	✓
3+20				9.17	✓
3+40				9.27	✓
3+50	(8.99)	(8.99)	(8.99)	9.32	✓
3+60				9.28	✓
3+80				9.20	✓
4+00				9.12	✓
4+20	8.70	8.72	8.71	9.04	✓

$$\begin{array}{r}
 7.74 \\
 8.80 \\
 \hline
 16.54 \\
 2 \overline{) 16.54} \\
 \underline{8.27} \\
 35 \\
 \underline{8.6} \\
 8.98 \\
 8.56 \\
 \hline
 135
 \end{array}$$

$$\begin{array}{r}
 8.74 \\
 33 \\
 \hline
 9.07
 \end{array}$$

$$\begin{array}{r}
 8.99 \\
 .28 \\
 \hline
 9.27 \\
 .33 \\
 \hline
 9.60
 \end{array}$$

$$\begin{array}{r}
 74 \\
 \hline
 74 \\
 .04
 \end{array}$$

$$\begin{array}{r}
 9.32 \\
 9.07 \\
 \hline
 18.39 \\
 .25 \\
 \hline
 18.64
 \end{array}$$



W. side - S. line of Park 4A to 5 rail RR

← Center W ✓

0+00	10.00	10.00 ✓
0+20	10.16	10.10 ✓
0+41	10.22	10.22 ✓
0+51	10.39	10.37 ✓
0+60	10.73	10.73 ✓
0+70	11.13	11.13 ✓
0+96	11.93	
1+01	12.37	12.37 ✓
1+07	12.42	12.42 ✓

5/90  
18

From N Rail The  
W side E side

	N. Rail	W side	E side
0+00	10.20		10.10
0+00	9.75		9.87
0+15	9.79 ✓		9.81 ✓
0+20	9.82 ✓		9.80 ✓
0+30	10.04 ✓		10.04 ✓
0+40	10.26 ✓		10.26 ✓
0+50	10.48 ✓		10.48 ✓
0+60	10.70		10.70 ✓
0+70	10.92 ✓		10.92 ✓
0+80	11.14 ✓		11.14 ✓
0+90	11.36 ✓		11.36 ✓
0+96	N. Rail 11.42		
1+00			9. Rail 11.45

to N Rail RR

363 Bars  $\frac{3}{8}$ " Round  $20\frac{1}{2}$  feet long  
243 Bars  $\frac{1}{2}$ " Round 14 feet long

Sta 10+61 - Sta 13+94

$$P = \frac{2WH}{S-1} =$$

Cement 45  
20

Lime

108

0  
2.0  
1.00 2.00 .02

63

$$\begin{array}{r}
 14 \overline{) 363} \\
 \underline{28} \\
 83
 \end{array}
 \quad \bigg| \quad 2.6$$

40

4

$$\begin{array}{r}
 104 \\
 \underline{136}
 \end{array}$$

$$\begin{array}{r}
 50 \overline{) 2.00} \\
 \underline{1.00} \\
 1.00
 \end{array}
 \quad \bigg| \quad .04$$

Cement 20  
 Sacks 30 } 74  
 20

Lim  
 III Sept. 22

(~~||||~~ ~~||||~~ ~~||||~~ ~~||||~~ ~~||||~~ ~~||||~~ ~~||||~~ ~~||||~~) = 48

III sack in catch B. 7 lbs

~~||||~~ ~~||||~~ ~~||||~~ ~~||||~~ ~~||||~~ ~~||||~~ ~~||||~~ ~~||||~~ ~~||||~~ ~~||||~~ = 20 (X) = 25

$$\begin{array}{r}
 22.3 \\
 \underline{3} \\
 66.9
 \end{array}$$

$$\begin{array}{r}
 16 \\
 \underline{5} \\
 11
 \end{array}$$

$$\begin{array}{r}
 12 \\
 \underline{30} \\
 18
 \end{array}$$

$$\begin{array}{r}
 15 \\
 \underline{25} \\
 10
 \end{array}$$

$$\begin{array}{r}
 60 \overline{) 180} \\
 \underline{120} \\
 60
 \end{array}$$

$$\begin{array}{r}
 25 \\
 \underline{48} \\
 23
 \end{array}$$

$$\begin{array}{r}
 73 \\
 \underline{73} \\
 0
 \end{array}$$

73

$$\begin{array}{r}
 67 \\
 \underline{67} \\
 0
 \end{array}$$

$$\begin{array}{r}
 64 \overline{) 680} \\
 \underline{20} \\
 480 \\
 \underline{480} \\
 0
 \end{array}$$

{ Weldon Wood.  
Clifford Fleece  
Bassil Kersey  
Joseph Johnson }

180  
 $\frac{1}{2} \frac{1}{2} \frac{1}{2} \frac{1}{2} \frac{1}{2} \frac{1}{2} \frac{1}{2} \frac{1}{2}$   
 $\frac{1}{2} \frac{1}{2} \frac{1}{2} \frac{1}{2} \frac{1}{2} \frac{1}{2} \frac{1}{2} \frac{1}{2}$   
 $\frac{1}{2} \frac{1}{2} \frac{1}{2} \frac{1}{2} \frac{1}{2} \frac{1}{2} \frac{1}{2} \frac{1}{2}$   
 $\frac{1}{2} \frac{1}{2} \frac{1}{2} \frac{1}{2} \frac{1}{2} \frac{1}{2} \frac{1}{2} \frac{1}{2}$   
 $\frac{1}{2} \frac{1}{2} \frac{1}{2} \frac{1}{2} \frac{1}{2} \frac{1}{2} \frac{1}{2} \frac{1}{2}$

$$\begin{array}{r} 121 \\ 363 \times 21 \times \frac{2}{3} = \\ \hline 27 \\ 9 \end{array}$$

$$\begin{array}{r} 121 \\ 14 \\ \hline 484 \end{array}$$

$$\begin{array}{r} 121 \\ 1694 \\ 9 \overline{) 1694} \\ \underline{9} \\ 79 \\ \underline{72} \\ 74 \end{array}$$

$$\begin{array}{r} 1139 \\ 150 \\ \hline 989 \end{array}$$

$$\begin{array}{r} 12 \\ 75 \\ \hline 15 \end{array}$$

188

$$\begin{array}{r} 852 \\ \hline 17 \end{array}$$



Brownburg Street  
 Mon. Sept 18 Cement 18 1/2  
 Lime 1 1/2

33

44.83

3.65  
 1.12

250

2 33.32  
 3.83  
 232.45

33.20  
 7660

2 x 2500 x 20  
 100,000

Natural Trigonometrical Ratios.

an.	Sec.	Cosec.	Cotg.	Cosin.	Angle.	Sina.	Tan.	Sec.	Cosec.	Cotg.	Cosin.
90				1.	0						1.
89	1.0001	85.94	85.94	.99993	1	.1392	.1405	1.0098	7.185	7.115	.99027
88	1.0002	67.30	67.29	.99985	2	.1421	.1435	1.0102	7.040	6.968	.98988
87	1.0003	57.29	57.29	.99985	3	.1449	.1465	1.0107	6.900	6.827	.98944
86	1.0004	49.11	49.10	.99979	4	.1478	.1495	1.0111	6.766	6.691	.98902
85	1.0005	42.98	42.96	.99973	5	.1507	.1524	1.0115	6.636	6.561	.98858
84	1.0006	38.20	38.19	.99966	6	.1536	.1554	1.0120	6.512	6.435	.98814
83	1.0007	34.38	34.37	.99958	7	.1564	.1584	1.0125	6.394	6.314	.98769
82	1.0008	31.26	31.24	.99949	8	.1593	.1614	1.0129	6.277	6.197	.98723
81	1.0009	28.65	28.64	.99939	9	.1622	.1644	1.0134	6.166	6.084	.98676
80	1.0010	26.45	26.43	.99929	10	.1650	.1673	1.0139	6.059	5.976	.98629
79	1.0011	24.56	24.54	.99917	11	.1679	.1703	1.0144	5.955	5.871	.98580
78	1.0012	22.93	22.90	.99905	12	.1708	.1733	1.0149	5.855	5.769	.98531
77	1.0013	21.49	21.47	.99892	13	.1736	.1763	1.0154	5.759	5.671	.98481
76	1.0014	20.23	20.21	.99878	14	.1765	.1793	1.0160	5.665	5.576	.98430
75	1.0015	19.11	19.08	.99863	15	.1794	.1823	1.0165	5.575	5.485	.98378
74	1.0016	18.10	18.07	.99847	16	.1822	.1853	1.0170	5.488	5.396	.98325
73	1.0017	17.20	17.17	.99831	17	.1851	.1883	1.0176	5.403	5.309	.98272
72	1.0018	16.38	16.35	.99813	18	.1880	.1914	1.0181	5.320	5.226	.98218
71	1.0019	15.64	15.60	.99795	19	.1908	.1944	1.0187	5.241	5.145	.98163
70	1.0020	14.96	14.92	.99776	20	.1937	.1974	1.0193	5.164	5.066	.98107
69	1.0021	14.34	14.30	.99756	21	.1965	.2004	1.0199	5.089	4.989	.98050
68	1.0022	13.76	13.73	.99736	22	.1994	.2035	1.0205	5.016	4.915	.97992
67	1.0023	13.23	13.20	.99714	23	.2022	.2065	1.0211	4.945	4.843	.97934
66	1.0024	12.75	12.71	.99692	24	.2051	.2095	1.0217	4.877	4.773	.97875
65	1.0025	12.29	12.25	.99668	25	.2079	.2126	1.0223	4.810	4.705	.97815
64	1.0026	11.87	11.83	.99644	26	.2108	.2156	1.0230	4.745	4.638	.97754
63	1.0027	11.47	11.43	.99619	27	.2136	.2186	1.0236	4.682	4.574	.97692
62	1.0028	11.10	11.06	.99594	28	.2164	.2217	1.0243	4.620	4.511	.97630
61	1.0029	10.76	10.71	.99567	29	.2193	.2247	1.0249	4.560	4.449	.97566
60	1.0030	10.43	10.39	.99540	30	.2221	.2278	1.0256	4.502	4.390	.97502
59	1.0031	10.13	10.08	.99511	31	.2250	.2309	1.0263	4.445	4.331	.97437
58	1.0032	9.839	9.788	.99482	32	.2278	.2339	1.0270	4.390	4.275	.97371
57	1.0033	9.577	9.514	.99452	33	.2306	.2370	1.0277	4.336	4.219	.97304
56	1.0034	9.309	9.255	.99421	34	.2334	.2401	1.0284	4.284	4.165	.97237
55	1.0035	9.065	9.010	.99390	35	.2363	.2432	1.0291	4.232	4.113	.97169
54	1.0036	8.834	8.777	.99357	36	.2391	.2462	1.0299	4.182	4.061	.97100
53	1.0037	8.614	8.556	.99324	37	.2419	.2493	1.0306	4.133	4.011	.97030
52	1.0038	8.405	8.345	.99290	38	.2447	.2524	1.0314	4.086	3.962	.96959
51	1.0039	8.206	8.144	.99255	39	.2476	.2555	1.0321	4.039	3.914	.96887
50	1.0040	8.016	7.953	.99219	40	.2504	.2586	1.0329	3.994	3.867	.96815
49	1.0041	7.834	7.770	.99182	41	.2532	.2617	1.0337	3.949	3.821	.96742
48	1.0042	7.661	7.596	.99144	42	.2560	.2648	1.0345	3.906	3.776	.96667
47	1.0043	7.496	7.429	.99106	43	.2588	.2679	1.0353	3.864	3.732	.96593
46	1.0044	7.337	7.269	.99067	44	.2616	.2711	1.0361	3.822	3.689	.96517
45					45	.2644	.2742	1.0369	3.782	3.647	.96440
44					46	.2672	.2773	1.0377	3.742	3.606	.96363
43					47	.2700	.2805	1.0386	3.703	3.566	.96285
42					48	.2728	.2836	1.0394	3.665	3.526	.96206
41					49						
40					50						

Cotg. Cosec. Sec. Tan. Sina. Angla.

Cosin. Cotg. Cosec. Sec. Tan. Sina. Angla.