

THE  
LIBRARY  
366 A

161

Beginning at Reno; thence  
W, S, and SW to the Co.  
line.

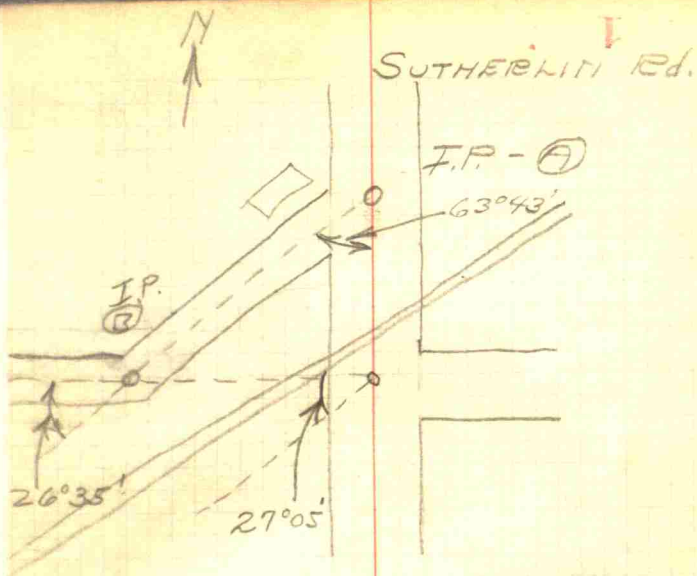

B-Wit  
dash N-37.6  
SE cor stone  
N 45° W - 41.1'  
Switch sign  
S 50° W 76.6'

A-Wit  
SE cor stone  
17 45° W - 33.3'  
Concrete Post  
17 25° E - 46.4'  
Switch sign S 20° W  
69.8'

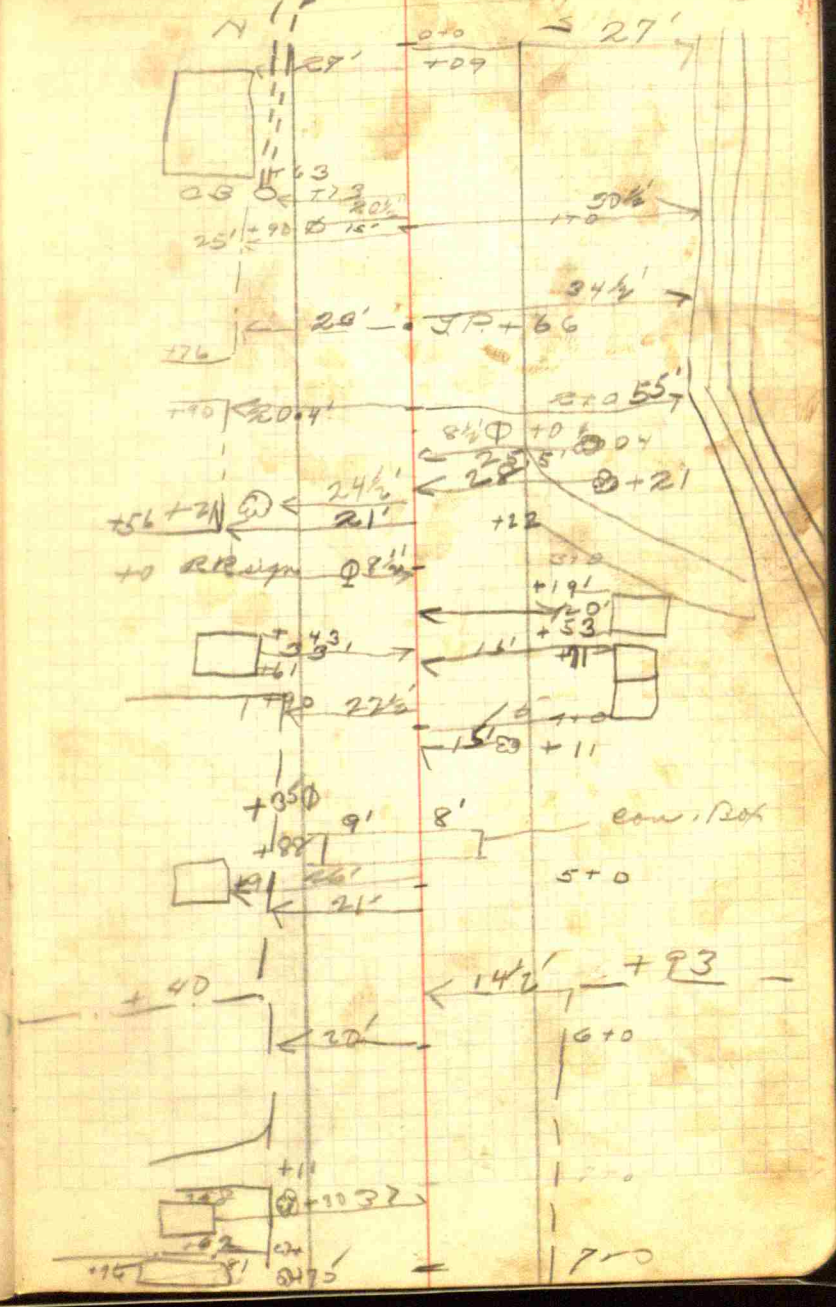
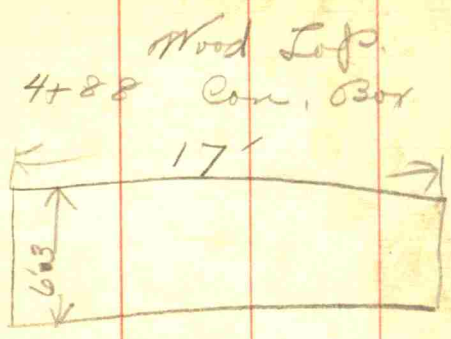

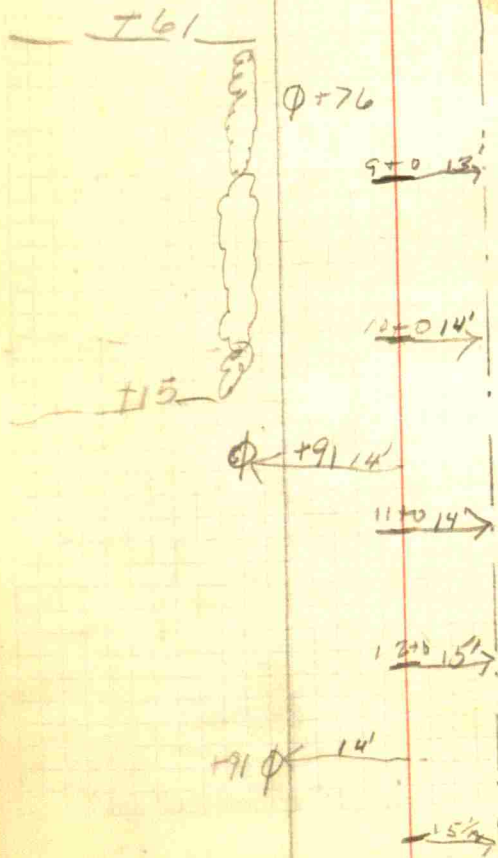
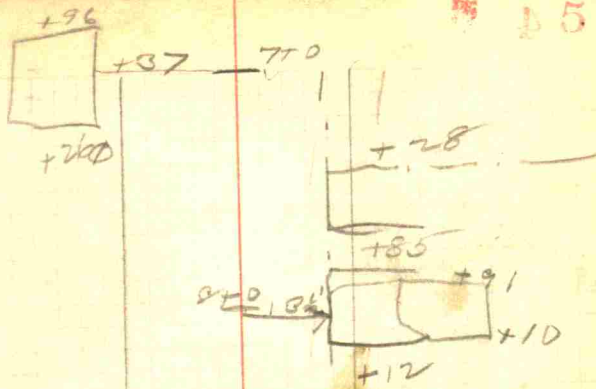

T15

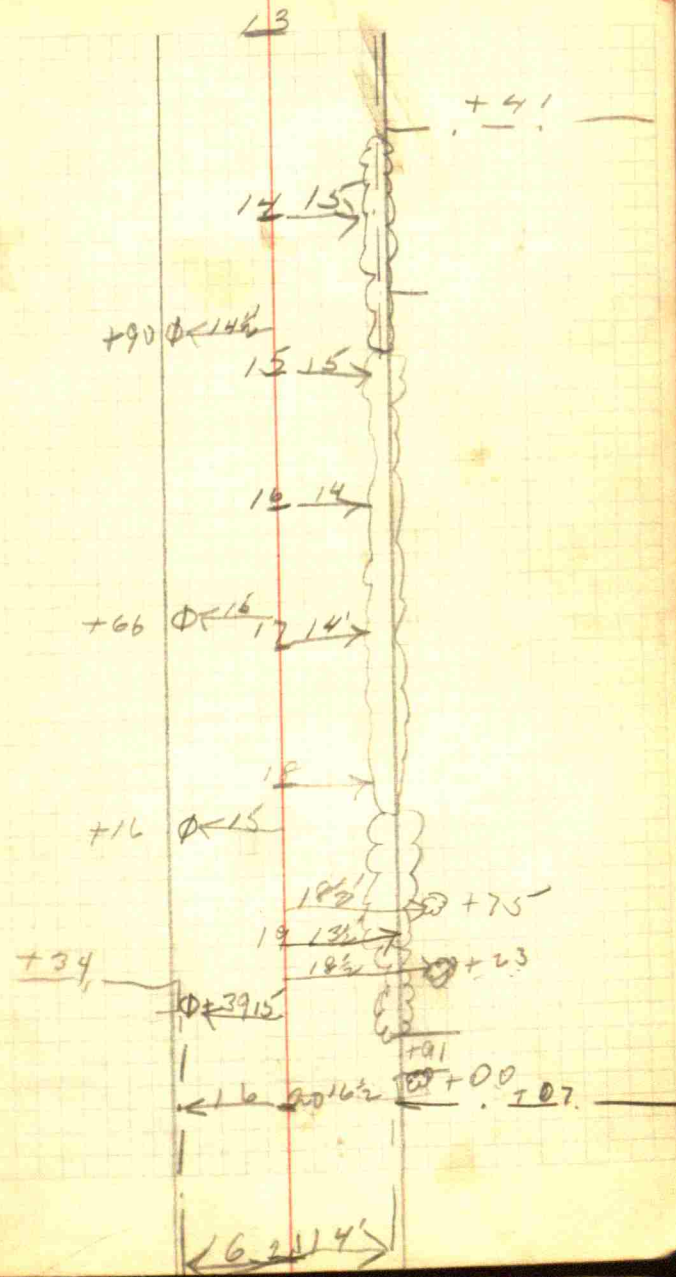

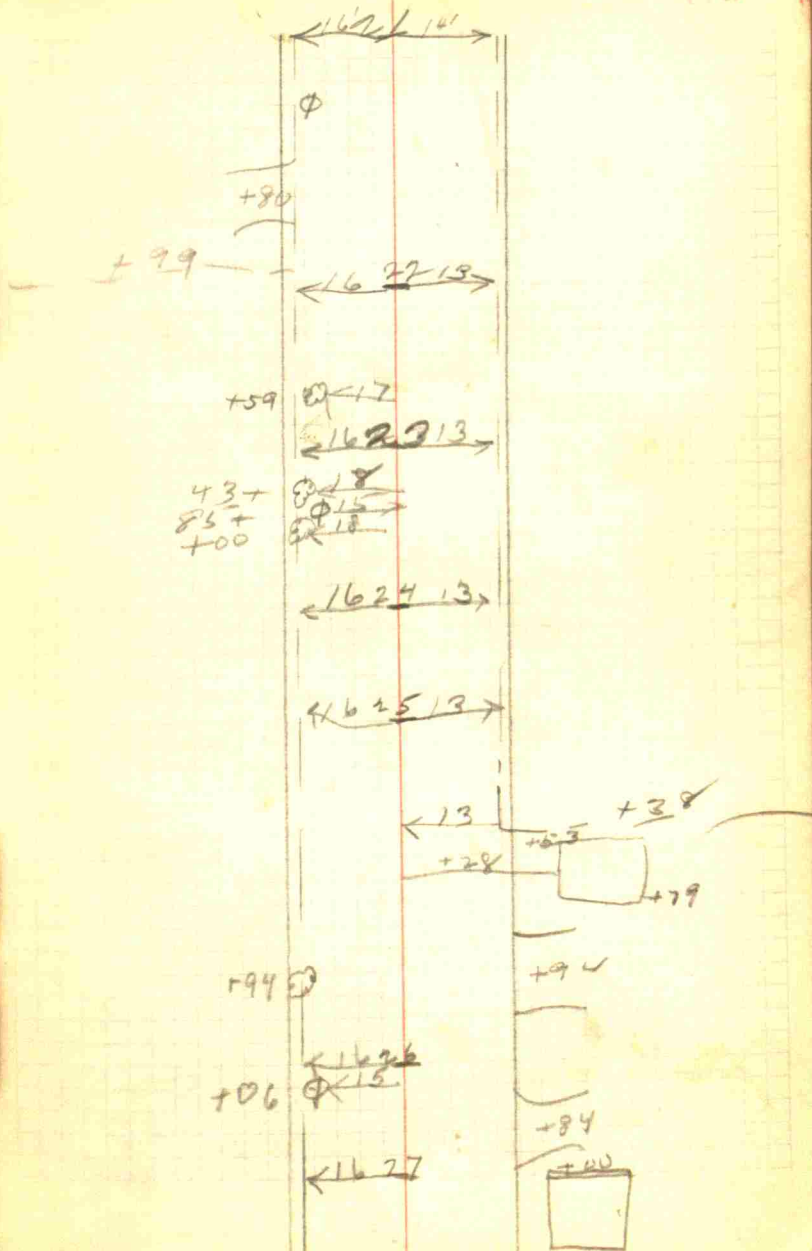

29+92

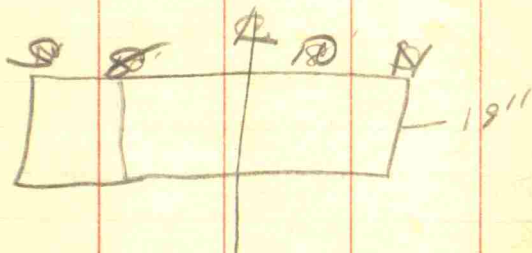

31+0

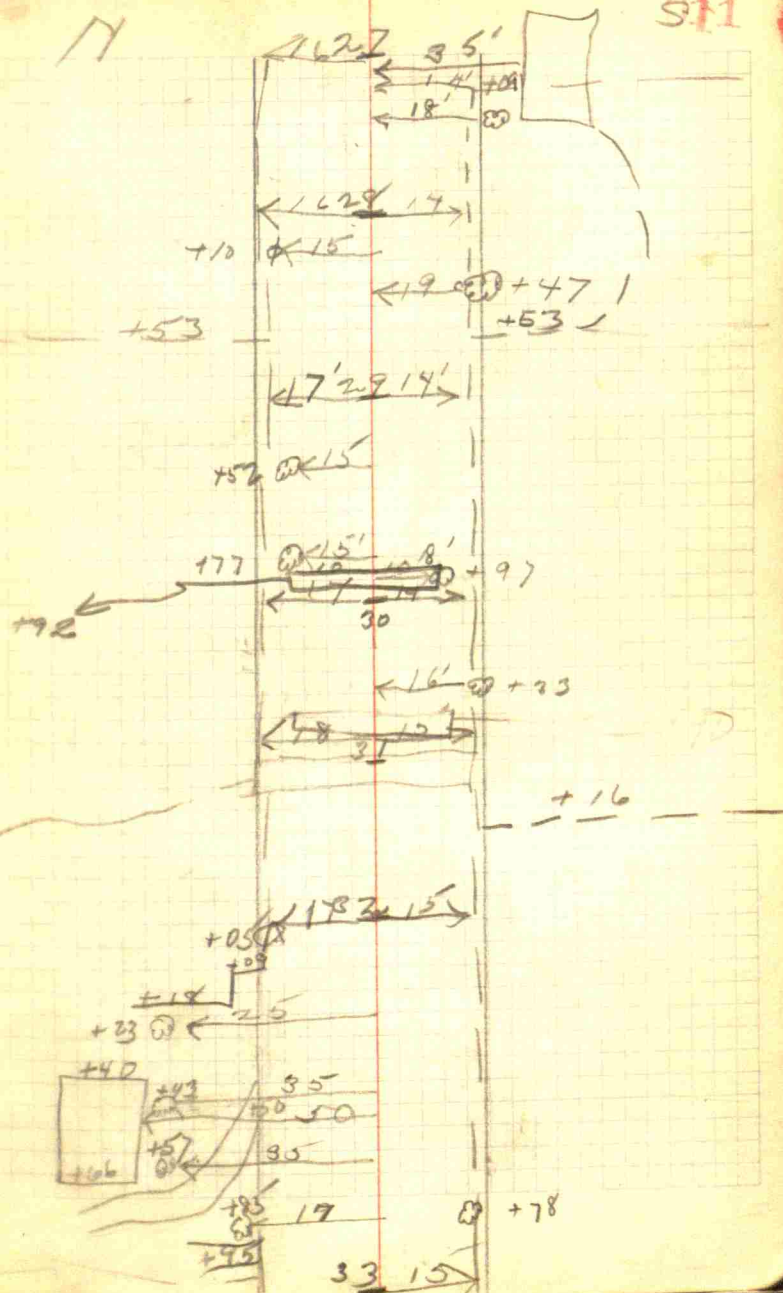
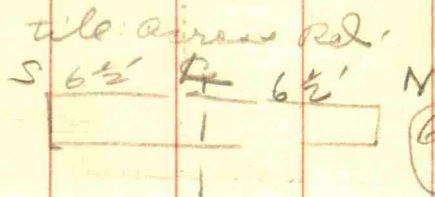

39+88 Con. Met. Pipe

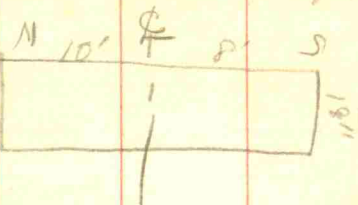

Witness of Iron Pin

Sta. 37+61

Con. cor. Post W = 14'

Con. Cor. Post. N. 40°W = 18.9'

Con. cor. post N 45°W = 18.3'

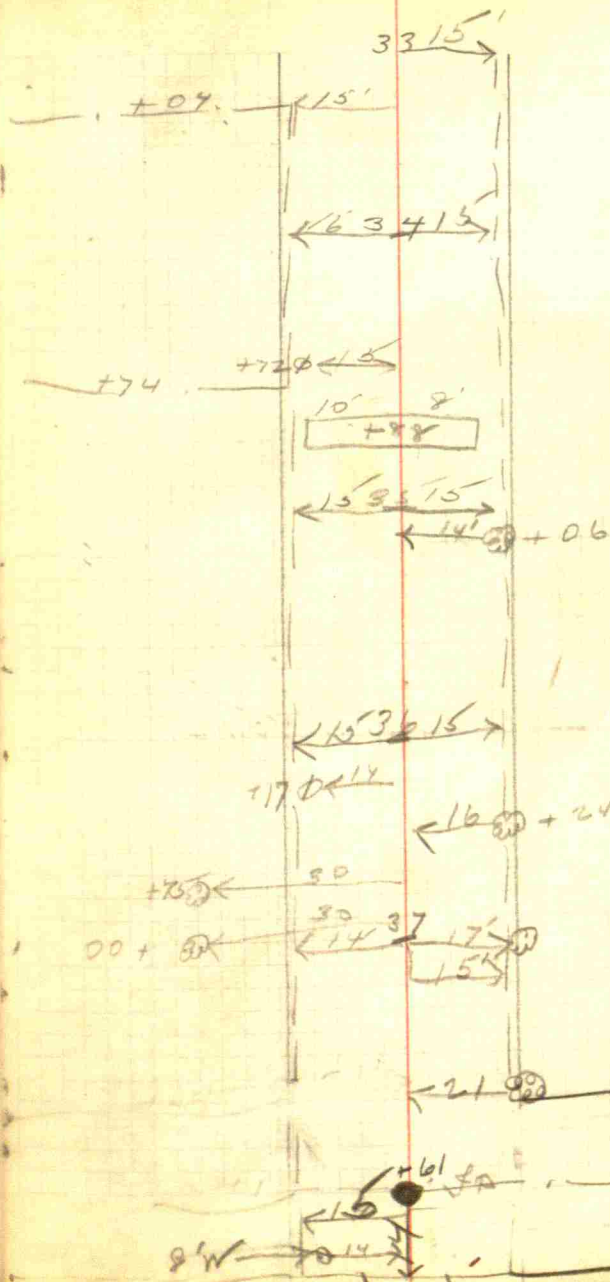



I

S

W

W

37.61

W

W

90°15' ←

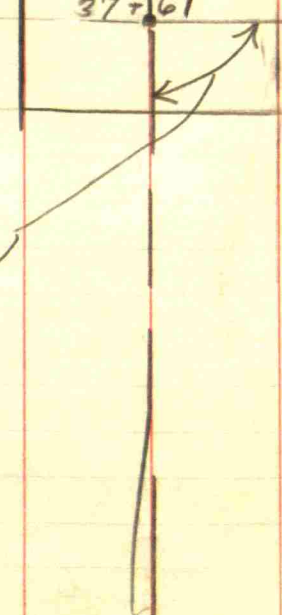

W E

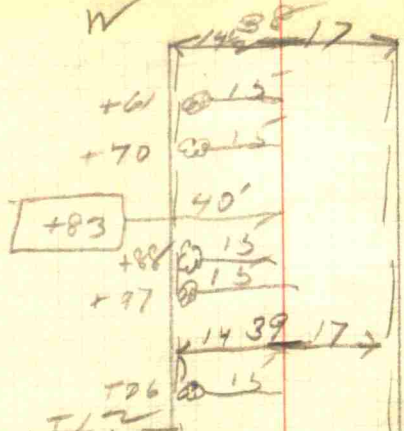

+83 17 0 +85

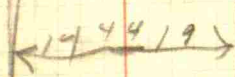
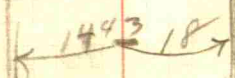
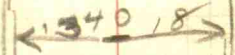

+87

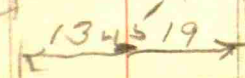

13 45 19

13 46 19

+20

13 42 19

12 48 20

49 20

+20

1250 16

1151 16

1152 16

Witnesses on Iron Pier  
Sta 57+54

Telephone Pole  $S 53^{\circ} E = 33'$   
North Rail of Rail Rd.  $S = 77'$   
Telephone Pole  $S 55^{\circ} W = 86.3'$

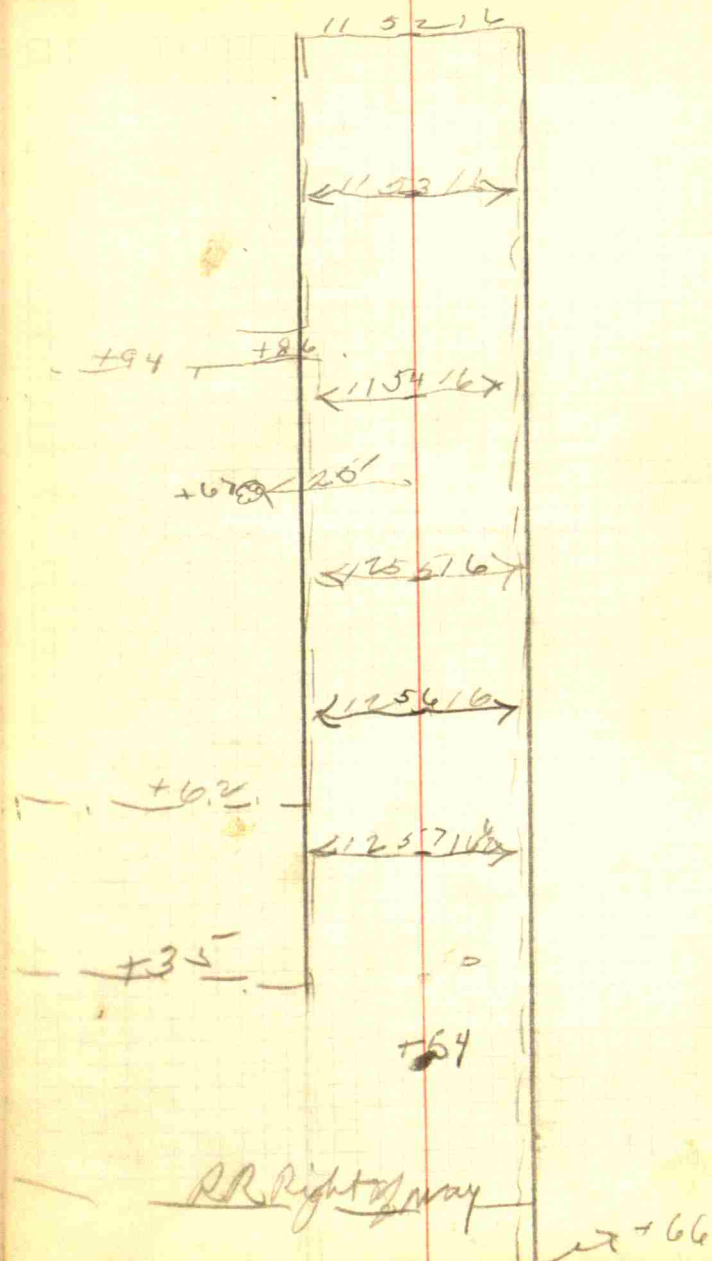

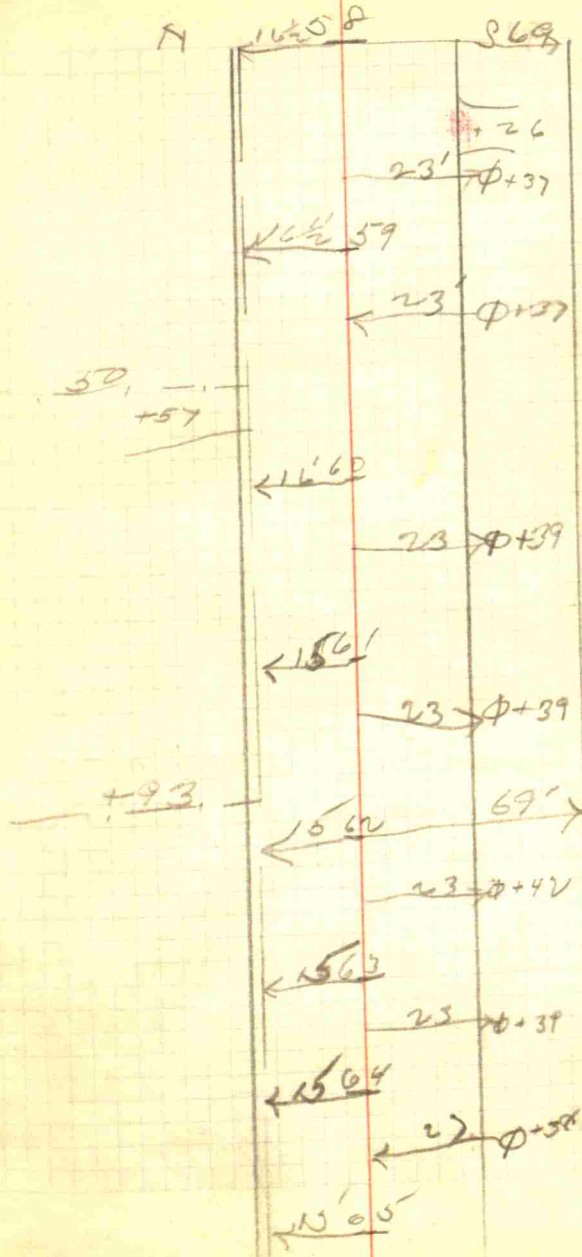
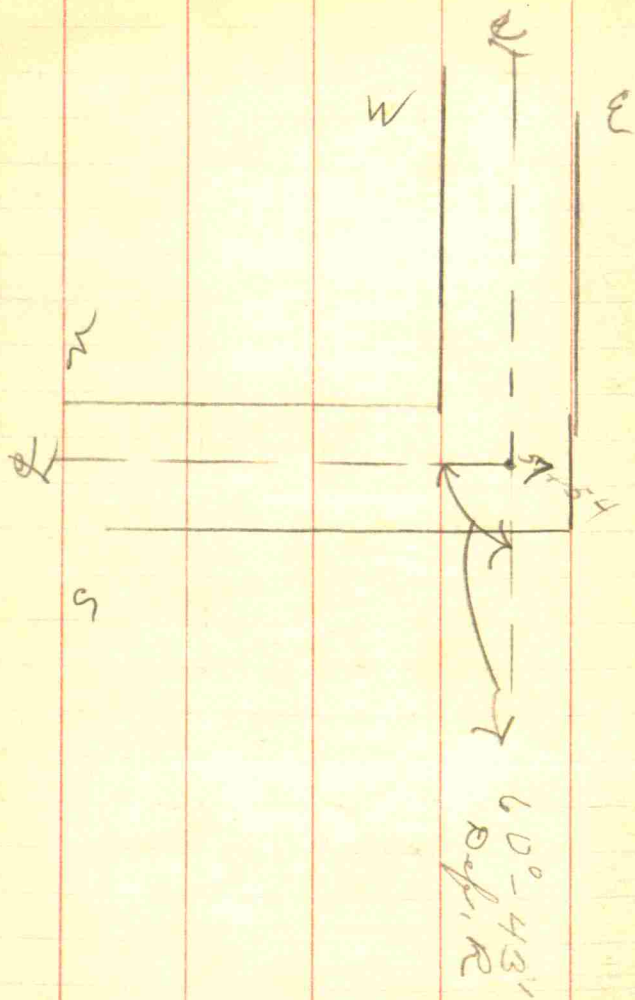

R.R.  
R.R.

Road crosses  
R.R. at  $50^\circ$  angle

Wht. of I.P.  
Sta 70+15

Telephone Pole S  $45^\circ$  W = 46.8'  
Line 67' due marker on R.R. S  $10^\circ$  E = 62.7'  
con. con. post. S  $45^\circ$  W = 17'

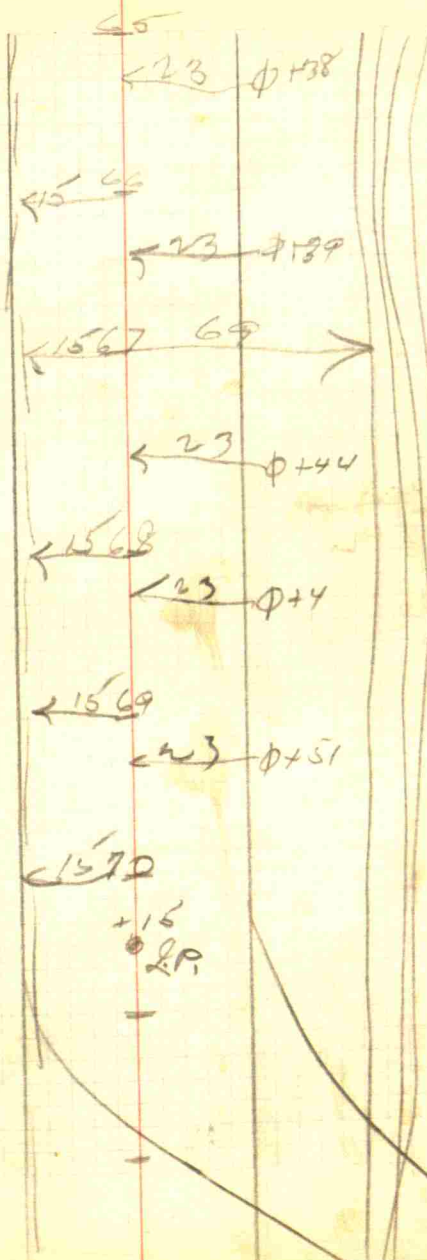

26

~~0+00~~ CHECK B.M. From  
 STA. 37+61 back To Reno

⊖

86.33 B.M. check

○ 83.47

○ 92.34

○ 98.26

○ 99.87

○ 96.47

98.41 B.M. check

99.94 B.M. check

85'n.

~~97.00~~

27

Sta	3' out	Stk	Ditch	Run	to	Run	Stk	3' out	B.M. on Top
0+00		102.20	101.72	100.53	99.31	98.60	97.70	97.00	Concrete Corner
0+25		102.20		99.50	98.84	97.85	97.32	97.19	Post N.E. of
0+50		102.12	100.40	98.10	97.35	97.00	96.55	97.32	Sta 0+00
0+73	EL.	Top C.B.	-96.16-	FL. 8		8 in. tile in C.B.	94.44		FL. 100.00
1+00	99.64	98.37	96.90	96.63	96.40	96.52	96.40	96.35	○ 98.91
1+66	99.24	98.96	97.14	96.90	96.97	96.64	96.74	96.74	
2+0	98.42	98.12	97.27		97.6		96.96	97.83	
3+0	99.12	99.17	99.10		98.81	98.12	98.61	98.70	
4+0	97.72	97.72	97.80	97.75	98.02	97.90	97.88	97.88	97.61
4+88		96.90	95.26	98.02	98.14	98.07	95.26	96.45	8 in. tile from N.
5+0	96.80	96.95	96.48	98.35	98.44	98.40	97.70	97.11	at L. 4+88
6+0	97.78	97.90	97.61	98.64	98.10	97.98	97.81	97.81	F.L. 95.24
7+0	99.00	99.30	98.70	99.17	99.10	98.80	99.11	99.05	95.04
8+0	99.80	99.80		99.91	100.00	99.72	99.38	99.72	B.M. 50' N. of
9+0	99.08	99.26	98.72	99.34	99.84	99.56	98.73	99.10	L. 6+15 on S.E.
10+0	99.17	99.34	98.90	99.42	99.87	99.67	98.51	99.30	Corner of concrete
11+0	99.50	99.66	98.82	99.35	99.99	99.67	99.18	99.68	walk
12+0	98.80	99.10	98.61	99.20	99.75	99.35	98.78	99.21	EL. 98.47
13+0	99.00	99.40	98.65	99.02	99.57	99.33	98.90	98.86	○ 99.16
14+0	98.87	98.86	98.60	98.62	99.20	98.78	97.70	98.27	○ 99.86
15+0	97.96	98.56	97.74	98.02	98.40	98.30	97.39	98.05	○ 98.30
16+0	97.30	97.57	97.65	98.27	98.15	97.01	97.36	97.85	○ 97.73
17+0	97.25	97.25	97.50	98.12	98.21	97.08	97.02	97.37	97.67
18+0	98.13	98.76	97.25	98.16	98.23	97.86	97.43	97.60	97.17
19+0	98.77	98.92	97.90	98.37	98.84	98.50	97.67	98.83	97.67

8 in. tile from N.  
 at L. 4+88  
 F.L. 95.24  
 95.04

---

B.M. 50' N. of  
 L. 6+15 on S.E.  
 Corner of concrete  
 walk  
 EL. 98.47

○ 99.16  
 ○ 99.86  
 ○ 98.30  
 ○ 98.04



Sta	S'out	Stk	Ditch	Berm	F	Berm	Ditch	Stk	S'out
20+0	97.63	97.63	96.81	96.92	97.15	96.92	96.45	97.64	97.63
21+0	95.46	95.82	95.02	95.62	95.90	95.60	94.87	95.67	95.67
22+0	95.08	95.16	94.15	94.47	94.76	94.62	93.73	94.42	94.27
23+0	93.75	94.10	93.00	93.44	93.73	93.30	92.63	93.77	93.70
24+0	92.55	93.10	91.92	92.40	92.55	92.43	91.41	92.25	92.34
25+0	91.37	91.60	90.40	91.26	91.27	90.86	90.15	91.08	91.06
26+0	90.41	90.36	88.55	89.41	89.51	89.31	88.43	89.90	89.51
27+0	88.07	87.94	87.70	87.40	87.40	87.25	86.71	88.11	88.25
28+0	86.24	86.24	84.14	85.09	85.20	85.22	84.22	86.20	86.12
29+0	81.50	81.50	81.68	82.95	82.87	82.82	81.18	83.00	82.70
29+92	81.40	4L. 79.81	81.40	82.44	81.41	81.35	79.75	7L. 79.56	80.86
30+0	82.43	82.43	81.17	81.50	81.39	81.35	79.75	80.68	80.44
31+0		80.03	80.82	81.37	81.50	81.15	79.17	7L. 78.32	78.35
31+0	81.75	81.60	80.75		81.50	81.15	78.35	78.20	78.05
32+0	86.34	86.75	85.12	85.20	85.25		85.02	86.39	86.60
33+0	83.70	84.12	81.82	82.43	82.26	82.44	82.38	83.79	84.70
34+0	80.65	81.05	79.41	80.20	80.14	80.16	79.02	80.50	80.32
34+88	79.23	7L. 80	78.40	79.28	79.77	78.13	78.35	78.49	75.00
35+0	80.57	80.42	77.32	79.82	79.93	79.70	78.75	77.77	77.70
36+0	81.75	81.70	79.17	80.51	80.60	80.33	79.66	80.11	80.11
37+0	81.61	81.43	80.54	81.53	81.70	81.40	80.50	80.62	80.35
37+61		81.51			81.39			80.73	

⊙ 81.34

⊙ 92.56

⊙ 82.98

⊙ 83.22

B. Mon. S. E  
 corner of lower  
 concrete steps to  
 porch of house  
 at sta. 32+75  
 EL. 86.30

⊙ 79.77

B. M on TOP  
 01 = Concrete  
 Corner Post  
 1/4 W of sta  
 37+61  
 EL. 85.96

Sta	3' out	Stk	Ditch	Barms	K	Barms	Ditch	Stk	3' out
38+0	81.70	81.55	80.7 <sup>6</sup>	81.4 <sup>9</sup>	81.5 <sup>2</sup>	81.50 <sup>22</sup>	81.1 <sup>4</sup>	81.24	81.40
39+0	82.30	82.06	81.2 <sup>8</sup>	82.2 <sup>8</sup>	82.4 <sup>1</sup>	82.16 <sup>24</sup>	—	82.52	82.45
40+0	82.50	82.50	81.8 <sup>5</sup>	83.2 <sup>11</sup>	83.0 <sup>4</sup>	83.26 <sup>20</sup>	81.6 <sup>5</sup>	81.80	81.74
41+0	83.54	83.52	82.6 <sup>9</sup>	83.9 <sup>6</sup>	83.7 <sup>2</sup>	84.0 <sup>7</sup>	83.0 <sup>2</sup>	83.21	83.14
42+0	85.08	84.94	83.3 <sup>7</sup>	84.6 <sup>2</sup>	84.5 <sup>1</sup>	84.6 <sup>2</sup>	83.4 <sup>3</sup>	85.70	85.86
43+0	86.02	86.05	84.2 <sup>7</sup>	85.2 <sup>12</sup>	85.7 <sup>1</sup>	85.3 <sup>3</sup>	84.2 <sup>6</sup>	86.14	86.15
44+0	87.29	87.14	85.0 <sup>7</sup>	86.2 <sup>3</sup>	86.4 <sup>6</sup>	86.20 <sup>21</sup>	86.7 <sup>9</sup>	87.14	87.20
45+0	88.40	88.11	86.4 <sup>7</sup>	87.4 <sup>2</sup>	87.9 <sup>1</sup>	87.40 <sup>21</sup>	86.5 <sup>5</sup>	87.67	87.75
46+0	89.80	88.62	87.3 <sup>8</sup>	88.4 <sup>2</sup>	88.3 <sup>6</sup>	88.4 <sup>2</sup>	87.5 <sup>2</sup>	88.24	88.08
47+0	89.35	89.28	88.2 <sup>7</sup>	89.2 <sup>9</sup>	89.2 <sup>1</sup>	89.3 <sup>2</sup>	88.3 <sup>9</sup>	88.80	88.74
48+0	90.31	90.31	89.0 <sup>8</sup>	89.9 <sup>1</sup>	89.9 <sup>8</sup>	90.0 <sup>4</sup>	89.0 <sup>5</sup>	89.75	89.65
49+0	91.56	91.56	89.9 <sup>8</sup>	90.7 <sup>2</sup>	90.7 <sup>2</sup>	90.8 <sup>7</sup>	89.9 <sup>1</sup>	91.32	91.20
50+0	92.00	92.72	90.7 <sup>7</sup>	91.8 <sup>0</sup>	91.7 <sup>5</sup>	91.8 <sup>6</sup>	91.0 <sup>9</sup>	92.55	92.53
51+0	93.70	94.06	92.3 <sup>8</sup>	93.1 <sup>2</sup>	92.9 <sup>7</sup>	92.9 <sup>5</sup>	92.3 <sup>6</sup>	92.9 <sup>7</sup>	93.84
52+0	95.27	95.32	93.5 <sup>7</sup>	94.0 <sup>2</sup>	93.9 <sup>1</sup>	94.0 <sup>6</sup>	93.2 <sup>0</sup>	94.43	94.40
53+0	94.75	94.96	94.1 <sup>1</sup>	95.1 <sup>4</sup>	94.9 <sup>5</sup>	95.1 <sup>4</sup>	93.8 <sup>5</sup>	94.60	94.45
54+0	95.60	95.58	94.6 <sup>6</sup>	95.5 <sup>9</sup>	95.6 <sup>6</sup>	95.7 <sup>4</sup>	94.4 <sup>0</sup>	95.40	95.38
55+0	95.70	95.75	95.3 <sup>6</sup>	96.2 <sup>10</sup>	96.4 <sup>2</sup>	96.3 <sup>6</sup>	95.0 <sup>2</sup>	95.57	95.74
56+0	95.65	95.77	95.4 <sup>7</sup>	96.5 <sup>10</sup>	96.5 <sup>0</sup>	—	95.6 <sup>2</sup>	96.05	96.02
57+0	95.25	95.68	95.3 <sup>7</sup>	96.5 <sup>10</sup>	96.2 <sup>7</sup>	96.4 <sup>4</sup>	95.5 <sup>5</sup>	96.10	96.15
57+54	95.65	95.70		95.5 <sup>7</sup>	95.7 <sup>6</sup>	95.2 <sup>5</sup>	95.9 <sup>5</sup>		

6" Tile in  
E. side ditch  
FL. 80.20  
Sta 39+88

---

0 84.94

46+23  
72.97.36 16" tile  
from east

---

0 89.68

0 93.90

---

B.M. on top  
of concrete  
corner post  
20' SE of Sta  
57+54  
EL. 100.04

---

0 96.29

Sta	3' out	2' to	1' to	Corr	±
58+0	9630	9640	9612 <sup>8</sup>	9647 <sup>10</sup>	9639
59+0	9733	9730	9664 <sup>7</sup>	9755 <sup>10</sup>	9710
60+0	9773	9760	9671 <sup>7</sup>	9754 <sup>10</sup>	9720
61+0	9838	9759	9629 <sup>7</sup>	9752 <sup>13</sup>	9766
62+0	9748	9714	9589 <sup>8</sup>	9701 <sup>12</sup>	9690
63+0	9657	9650	9560 <sup>8</sup>	9670 <sup>12</sup>	9640
64+0	9666	9655	9557 <sup>7</sup>	9638 <sup>10</sup>	9657
65+0	9633	9644	9552 <sup>7</sup>	9641 <sup>10</sup>	9660
66+0	9675	9663	9559 <sup>8</sup>	9652 <sup>13</sup>	9645
67+0	9612	9606	9523 <sup>7</sup>	9655 <sup>12</sup>	9665
68+0	9560	9562	9470 <sup>7</sup>	9594 <sup>12</sup>	9600
69+0	9492	9504	9423 <sup>7</sup>	9519 <sup>12</sup>	9525
70+0	9450	9411	9352 <sup>7</sup>	9437 <sup>12</sup>	9435
70+15		9412			9433
					9620

Beam	Ditch	2' to	3' out	13.7M. or less
9665 <sup>20</sup>	9570 <sup>20</sup>	9639	9690	of concrete
9725 <sup>19</sup>	9633 <sup>24</sup>	9738	9733	concrete part 17'
9743 <sup>31</sup>	9659 <sup>25</sup>	9760	9769	N.W. of 41/2 sta
9758 <sup>22</sup>	9696 <sup>29</sup>	9748	9780	70+15
9672 <sup>21</sup>	9582 <sup>26</sup>	9653	9660	el. 98.68
9670 <sup>20</sup>	9568 <sup>26</sup>	9614	9605	
9656 <sup>20</sup>	9567 <sup>27</sup>	9610	9596	
9634 <sup>21</sup>	9524 <sup>27</sup>	9620	9605	
9640 <sup>21</sup>	9583 <sup>23</sup>	9660	9600	
9604 <sup>23</sup>	9609 <sup>27</sup>	9620	9584	
9585 <sup>20</sup>	9503 <sup>22</sup>	9607	9577	
9492 <sup>21</sup>	9496 <sup>27</sup>	9540	9510	
9415 <sup>20</sup>	9382 <sup>27</sup>	9425	9400	
<del>9392</del>				
			9420	

ESTIMATE - SUTHERLIN Rd.

EXC. 3268 Cu. Yds. - 35¢  
 STONE - 4½" x 2¾" - 1298 TONS - 2.25¢  
 " ¾" TO. DUST - 316 TONS - 2.25¢  
 GRAVEL - 1964 TONS - 2.00  
 80' x 10" COR. METAL PIPE ~ 1.25  
 52' x 24" R.C. PIPE - 3.50  
 26' x 18" R.C. PIPE ~ 2.50  
 45.9 Cu. Yds. CONCRETE ~ 14.00  
 1742 LBS. LOOSE STEEL = .05  
 1 STD. C. B. WITH GRATING - 50.00

1143.80  
 2920.50  
 711.00  
 3928.00  
 100.00  
 182.00  
 65.00  
 642.60  
 37.10 → 87.10  
 50.00

9780.00 + 9830.00  
 \$ 1420.00  
 11200.00

## Sutherland Road Sewers

Sta	Size	Kind	Length	Head	Conc	
70+25	18"	RC	26'	B7	5.0	OK ✓
N59+57	10"	C.M.	18'	L'	1.76	OK ✓
558+26	10"	"	16'	L'	12" x 3/4"	OK ✓
W53+86	10"	"	16'	L'	1.76	OK ✓
W37+50	8"	"	18' 8' x 10" Conc	L'	1.76	OK ✓
34+82	24"	RC	26'	B10' 4'-5" H		OK ✓
N32+95	10"	Conc	16'	L'	1.76	add 80' x 8" Dr Tile and 1-st. Hdump (OK) ✓
29+92	24"	RC	26'	B10' Hdump 4'-4.9" H		OK ✓
S26+84	12"	RC	16'	L'	1.76	add 136' x 12" Dr Tile and 16' x 12" CM + 1 L Hdump (OK) ✓
N21+80	10"	RC	16'	L'	1.76	OK ✓
S19+91	10"	RC	16'	L'	1.76	OK ✓
S7+85	10"	RC	16'	L'	1.76	add 1-hd Hdump OK ✓
N10+15	10"	CM	28'	L'	1.76	OK ✓
N7+46	10"	CM Dr T.	32' 11.4'	L'	1.76	OK ✓
5+0 NV	12"	Dr T.	6'	None	—	OK
2+90 NV	10"	CM	16'	L'	1.76	OK
4+80	Cross	BH	OK	\$18 <sup>00</sup>	Extra	

## West Culvt

18' x 42" C. M. Pipe in place

6.5' Bed to Crown Rd N. side

4.5' Bed to " " S. side

~~52.25~~
~~$$\begin{array}{r} 209 \\ - 98 \\ \hline 111 \end{array}$$~~
