

Thompson-Shultz
Damage

LEVEL BOOK
THOMPSON-SHULTZ #2

57

8

0
1
2
3
4
5
6
7
8
9
10
11
12
13
14
15
16
17
18
19
20
21
22
23
24
25
26
27
28
29
30
31
32
33
34
35
36
37
38
39
40

KEU

Index Book II

Transit Line

Back

106+00

107+00

108+00

109+00

110+00

111+00

111+73

111+73

5942

L4

Fence

111+00

112+00

113+00

114+00

115+00

115+15

116+00

117+00

118+00

40-15

115+15

~~JK~~ 79° 16'

119+00

120+00

120+15

121+00

122+00

123+00

124+00

5" Field Pipe
118+20 →

65 22

120+10 5" IRON PIPE

JR $\nabla 6^{\circ} 22'$
+35+35

125700

126700

127700

128700

129700

130700

~~126700~~
8" C.M.P.

131+00

132+00

133+00

134+00

135+00

135+35

136+00

85 50

~~ZR 86° 50'~~

~~5
137+27~~

once 136+14

137+00

137+27

138+00

139+00

140+00

141+00

142+00

143+00

94-50

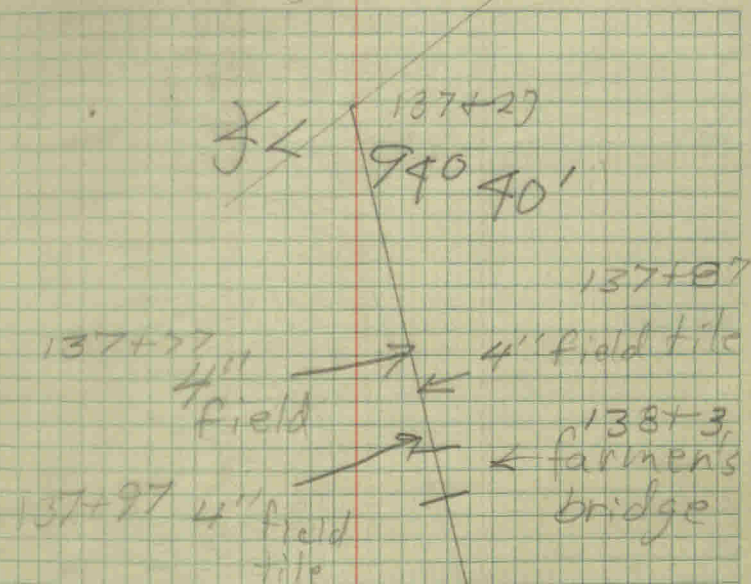

127+00

145+00

146+00

147+00

148+00

149+00

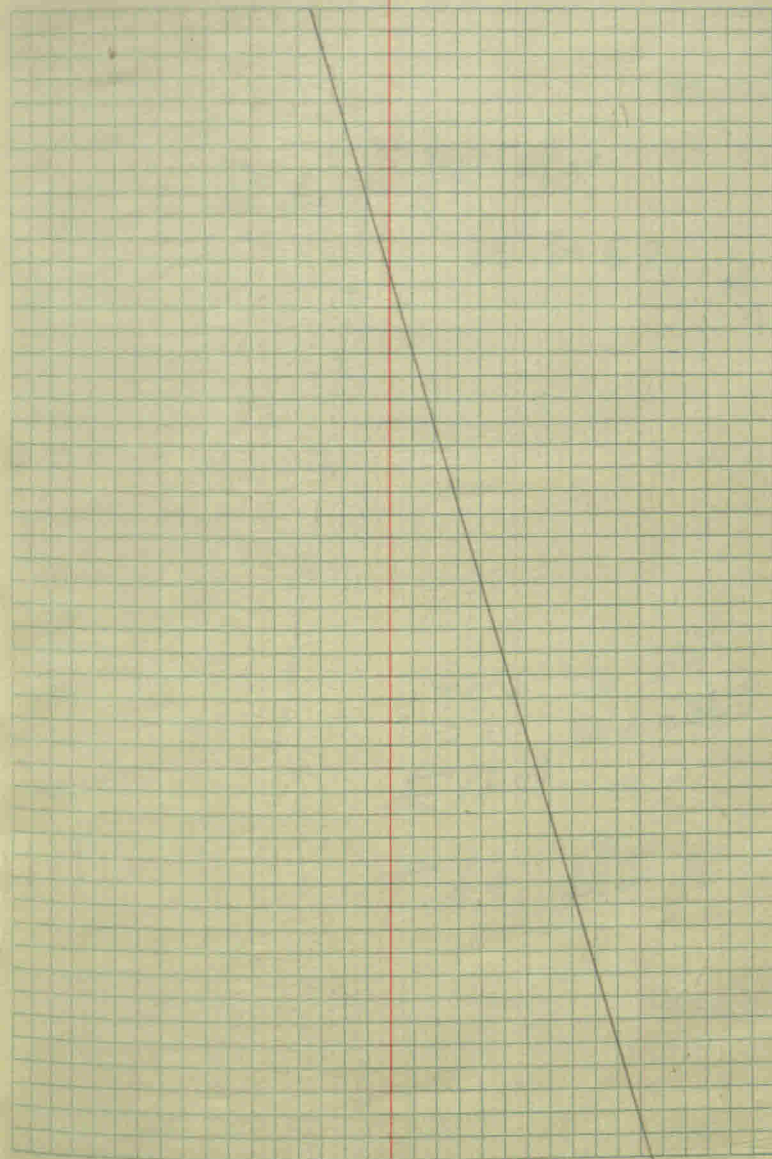

150+00

150+02

151+00

15

152+00

153+00

153+52

154+00

155+00

86 40

JK

86° 40'

153+52

153+52

152

153+52

758 to rd

220 to bridge

END OF

The ditch

0+00

1+00

2+00

3+00

4+00

5+00

ARM "A" OF T.S. Ditch

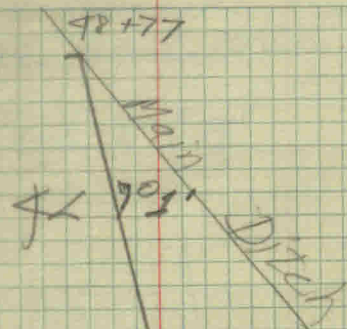

7'0" ~~1'~~

5+00

End

0+00

1+00

2+00

3+00

4+00

5+00

ARM "B" of T.S. Ditch

79180 Main ditch

$\angle 89^{\circ} 8'$

6+00

7+00

8+00

9+00

10+00

11+00

12+00

1182 77 17

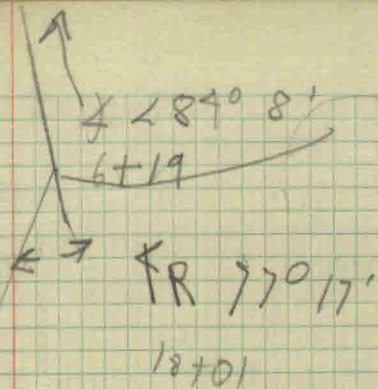

13+00

14+00

15+00

16+00

17+00

18+00

700's
to Bm ~~4~~ 18+01

±R 77° 17'

END 'B'.

XII

Natural Trigonometrical Functions

| Angle. Sin. Tan. Sec. Cosec. Cotg. Cosin. | | | | | | | Angle. Sin. Tan. Sec. Cosec. Cotg. Cosin. | | | | | | | | |
|---|------|-------|--------|-------|-------|--------|---|----|-------|-------|--------|-------|-------|-------|----|
| o | ' | | | | | o | o | ' | | | | | o | | |
| 32 | 5299 | .6249 | 1.1792 | 1.887 | 1.600 | .84805 | 58 | 39 | .6293 | .8008 | 1.2868 | 1.589 | 1.235 | .7715 | 51 |
| 10 | 5324 | .6289 | 1.1813 | 1.878 | 1.590 | .84650 | 50 | 10 | .6316 | .8146 | 1.2898 | 1.583 | 1.228 | .7731 | 50 |
| 20 | 5348 | .6330 | 1.1835 | 1.870 | 1.580 | .84495 | 40 | 20 | .6338 | .8195 | 1.2929 | 1.578 | 1.220 | .7747 | 40 |
| 30 | 5373 | .6371 | 1.1857 | 1.861 | 1.570 | .84339 | 30 | 30 | .6361 | .8243 | 1.2959 | 1.572 | 1.213 | .7762 | 30 |
| 40 | 5398 | .6412 | 1.1879 | 1.853 | 1.560 | .84182 | 20 | 40 | .6383 | .8292 | 1.2991 | 1.567 | 1.206 | .7777 | 20 |
| 50 | 5422 | .6453 | 1.1901 | 1.844 | 1.550 | .84025 | 10 | 50 | .6406 | .8342 | 1.3022 | 1.561 | 1.199 | .7791 | 10 |
| 33 | 5446 | .6494 | 1.1924 | 1.836 | 1.540 | .83867 | 57 | 40 | .6428 | .8391 | 1.3054 | 1.556 | 1.192 | .7804 | 50 |
| 10 | 5471 | .6536 | 1.1946 | 1.828 | 1.530 | .83708 | 50 | 10 | .6450 | .8441 | 1.3086 | 1.550 | 1.185 | .7817 | 50 |
| 20 | 5495 | .6577 | 1.1969 | 1.820 | 1.520 | .83549 | 40 | 20 | .6472 | .8491 | 1.3118 | 1.545 | 1.178 | .7829 | 40 |
| 30 | 5519 | .6619 | 1.1992 | 1.812 | 1.511 | .83389 | 30 | 30 | .6494 | .8541 | 1.3151 | 1.540 | 1.171 | .7841 | 30 |
| 40 | 5544 | .6661 | 1.2015 | 1.804 | 1.501 | .83228 | 20 | 40 | .6517 | .8591 | 1.3184 | 1.535 | 1.164 | .7853 | 20 |
| 50 | 5568 | .6703 | 1.2039 | 1.796 | 1.492 | .83066 | 10 | 50 | .6539 | .8642 | 1.3217 | 1.529 | 1.157 | .7866 | 10 |
| 34 | 5592 | .6745 | 1.2062 | 1.788 | 1.483 | .82904 | 56 | 41 | .6561 | .8693 | 1.3251 | 1.524 | 1.150 | .7877 | 40 |
| 10 | 5616 | .6787 | 1.2086 | 1.781 | 1.473 | .82741 | 50 | 10 | .6583 | .8744 | 1.3284 | 1.519 | 1.144 | .7889 | 50 |
| 20 | 5640 | .6830 | 1.2110 | 1.773 | 1.464 | .82577 | 40 | 20 | .6604 | .8796 | 1.3318 | 1.514 | 1.137 | .7900 | 40 |
| 30 | 5664 | .6873 | 1.2134 | 1.766 | 1.455 | .82413 | 30 | 30 | .6626 | .8847 | 1.3352 | 1.509 | 1.130 | .7911 | 30 |
| 40 | 5688 | .6916 | 1.2158 | 1.758 | 1.446 | .82248 | 20 | 40 | .6648 | .8899 | 1.3386 | 1.504 | 1.124 | .7922 | 20 |
| 50 | 5712 | .6959 | 1.2183 | 1.751 | 1.437 | .82082 | 10 | 50 | .6670 | .8952 | 1.3421 | 1.499 | 1.117 | .7933 | 10 |
| 35 | 5736 | .7002 | 1.2208 | 1.743 | 1.428 | .81915 | 55 | 42 | .6691 | .9004 | 1.3456 | 1.494 | 1.111 | .7944 | 40 |
| 10 | 5760 | .7046 | 1.2233 | 1.736 | 1.419 | .81748 | 50 | 10 | .6713 | .9057 | 1.3492 | 1.490 | 1.104 | .7955 | 50 |
| 20 | 5783 | .7089 | 1.2258 | 1.729 | 1.411 | .81580 | 40 | 20 | .6734 | .9110 | 1.3527 | 1.485 | 1.098 | .7966 | 40 |
| 30 | 5807 | .7133 | 1.2283 | 1.722 | 1.402 | .81412 | 30 | 30 | .6756 | .9163 | 1.3563 | 1.480 | 1.091 | .7977 | 30 |
| 40 | 5831 | .7177 | 1.2309 | 1.715 | 1.393 | .81242 | 20 | 40 | .6777 | .9217 | 1.3600 | 1.476 | 1.085 | .7988 | 20 |
| 50 | 5854 | .7221 | 1.2335 | 1.708 | 1.385 | .81072 | 10 | 50 | .6799 | .9271 | 1.3636 | 1.471 | 1.079 | .7999 | 10 |
| 36 | 5878 | .7265 | 1.2361 | 1.701 | 1.376 | .80902 | 54 | 43 | .6820 | .9325 | 1.3673 | 1.466 | 1.072 | .8010 | 40 |
| 10 | 5901 | .7310 | 1.2387 | 1.695 | 1.368 | .80730 | 50 | 10 | .6841 | .9380 | 1.3711 | 1.462 | 1.066 | .8021 | 50 |
| 20 | 5925 | .7355 | 1.2413 | 1.688 | 1.360 | .80558 | 40 | 20 | .6862 | .9435 | 1.3748 | 1.457 | 1.060 | .8032 | 40 |
| 30 | 5948 | .7400 | 1.2440 | 1.681 | 1.351 | .80386 | 30 | 30 | .6884 | .9490 | 1.3786 | 1.453 | 1.054 | .8043 | 30 |
| 40 | 5972 | .7445 | 1.2466 | 1.675 | 1.343 | .80212 | 20 | 40 | .6905 | .9545 | 1.3824 | 1.448 | 1.048 | .8054 | 20 |
| 50 | 5995 | .7490 | 1.2494 | 1.668 | 1.335 | .80038 | 10 | 50 | .6926 | .9601 | 1.3863 | 1.444 | 1.042 | .8065 | 10 |
| 37 | 6018 | .7536 | 1.2521 | 1.662 | 1.327 | .79864 | 53 | 44 | .6947 | .9657 | 1.3902 | 1.440 | 1.036 | .8076 | 40 |
| 10 | 6041 | .7581 | 1.2549 | 1.655 | 1.319 | .79688 | 50 | 10 | .6967 | .9713 | 1.3941 | 1.435 | 1.030 | .8087 | 50 |
| 20 | 6065 | .7627 | 1.2577 | 1.649 | 1.311 | .79512 | 40 | 20 | .6988 | .9770 | 1.3980 | 1.431 | 1.024 | .8098 | 40 |
| 30 | 6088 | .7673 | 1.2605 | 1.643 | 1.303 | .79335 | 30 | 30 | .7009 | .9827 | 1.4020 | 1.427 | 1.018 | .8109 | 30 |
| 40 | 6111 | .7720 | 1.2633 | 1.636 | 1.295 | .79158 | 20 | 40 | .7030 | .9884 | 1.4061 | 1.422 | 1.012 | .8120 | 20 |
| 50 | 6134 | .7766 | 1.2661 | 1.630 | 1.288 | .78980 | 10 | 50 | .7050 | .9942 | 1.4101 | 1.418 | 1.006 | .8131 | 10 |
| 38 | 6157 | .7813 | 1.2690 | 1.624 | 1.280 | .78801 | 52 | | .7071 | 1. | 1.414 | 1.414 | 1. | .7071 | 45 |
| 10 | 6180 | .7860 | 1.2719 | 1.618 | 1.272 | .78622 | 50 | | | | | | | | |
| 20 | 6202 | .7907 | 1.2748 | 1.612 | 1.265 | .78442 | 40 | | | | | | | | |
| 30 | 6225 | .7954 | 1.2778 | 1.606 | 1.257 | .78261 | 30 | | | | | | | | |
| 40 | 6248 | .8002 | 1.2808 | 1.601 | 1.250 | .78079 | 20 | | | | | | | | |
| 50 | 6271 | .8050 | 1.2838 | 1.595 | 1.242 | .77897 | 10 | | | | | | | | |

Cosin. Cotg. Cosec. Sec. Tan. Sin. Angle

Cosin. Cotg. Cosec. Sec. Tan. Sin. Angle

497. → W



428 N.