

Proposed High School  
 for  
 DANVILLE INDIANA  
 Glen Hovermale, Supt.  
 of  
 City Schools.

BASEMENT FLOOR PLAN  
 Scale  $\frac{1}{16}'' = 12''$   
 BOARD OF EDUCATION:  
 Walter Hendrick, Secy.    John C. Taylor, Pres.  
 Frank Roberts, Treas.    Mrs. Minnie Bridges.

HENKEL & HANSON  
 Architects & Engineers  
 Connersville - Ind.

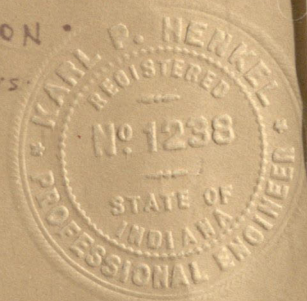

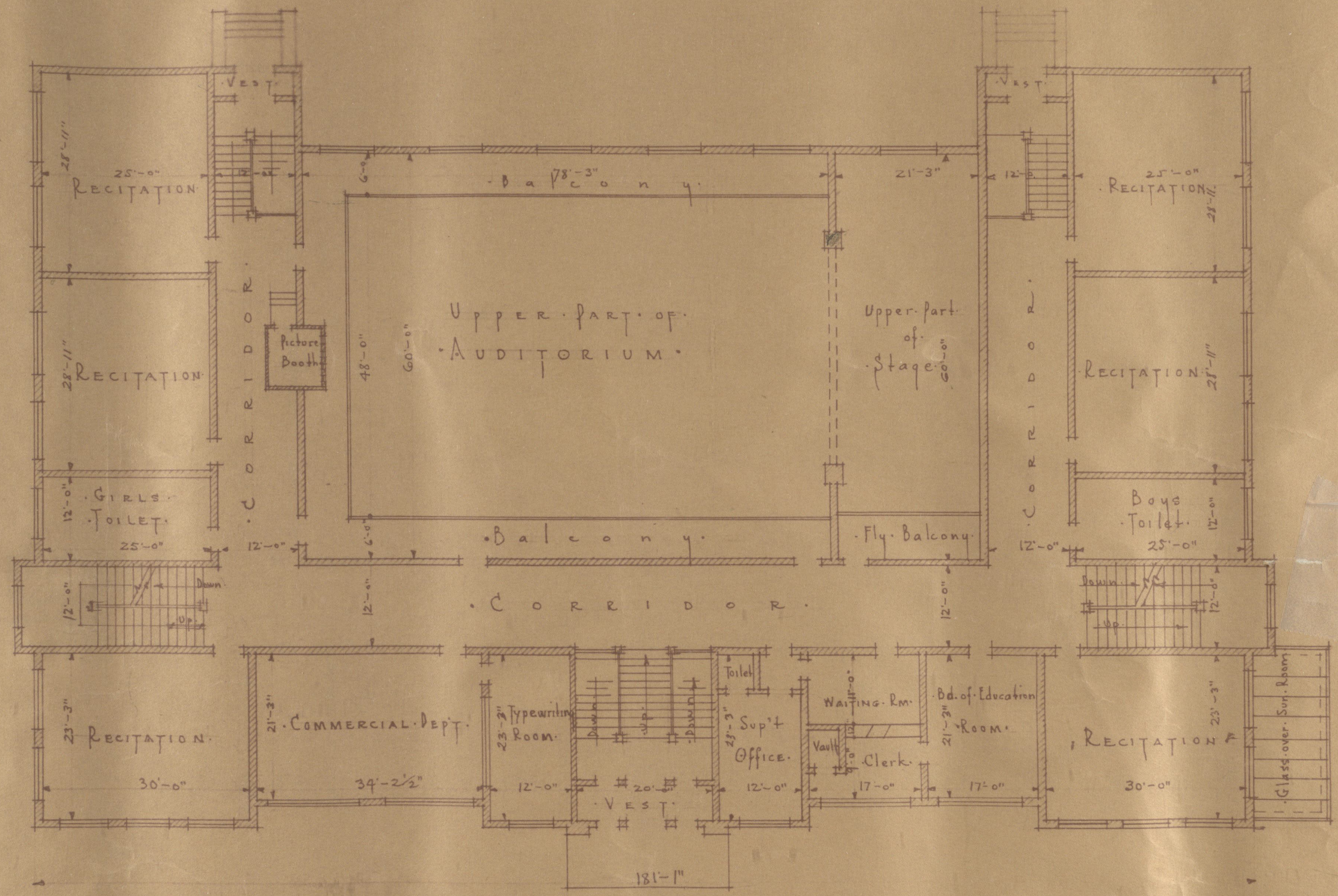

PROPOSED HIGH SCHOOL  
 FOR  
 DANVILLE, INDIANA  
 Glen Hovermale, Supt  
 of  
 City Schools.

FIRST FLOOR PLAN  
 Scale  $\frac{1}{16}'' = 12''$   
 BOARD OF EDUCATION  
 Walter Hendrick, Secy    John C. Taylor, Pres.  
 Frank Roberts, Treas.    Mrs. Minnie Bridges.

HENKEL & HANSON  
 Architects & Engineers  
 Connersville, Ind.

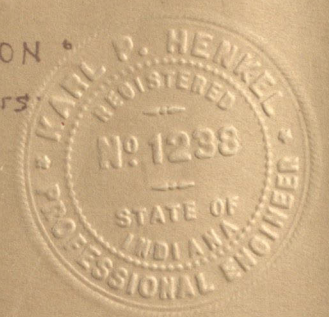

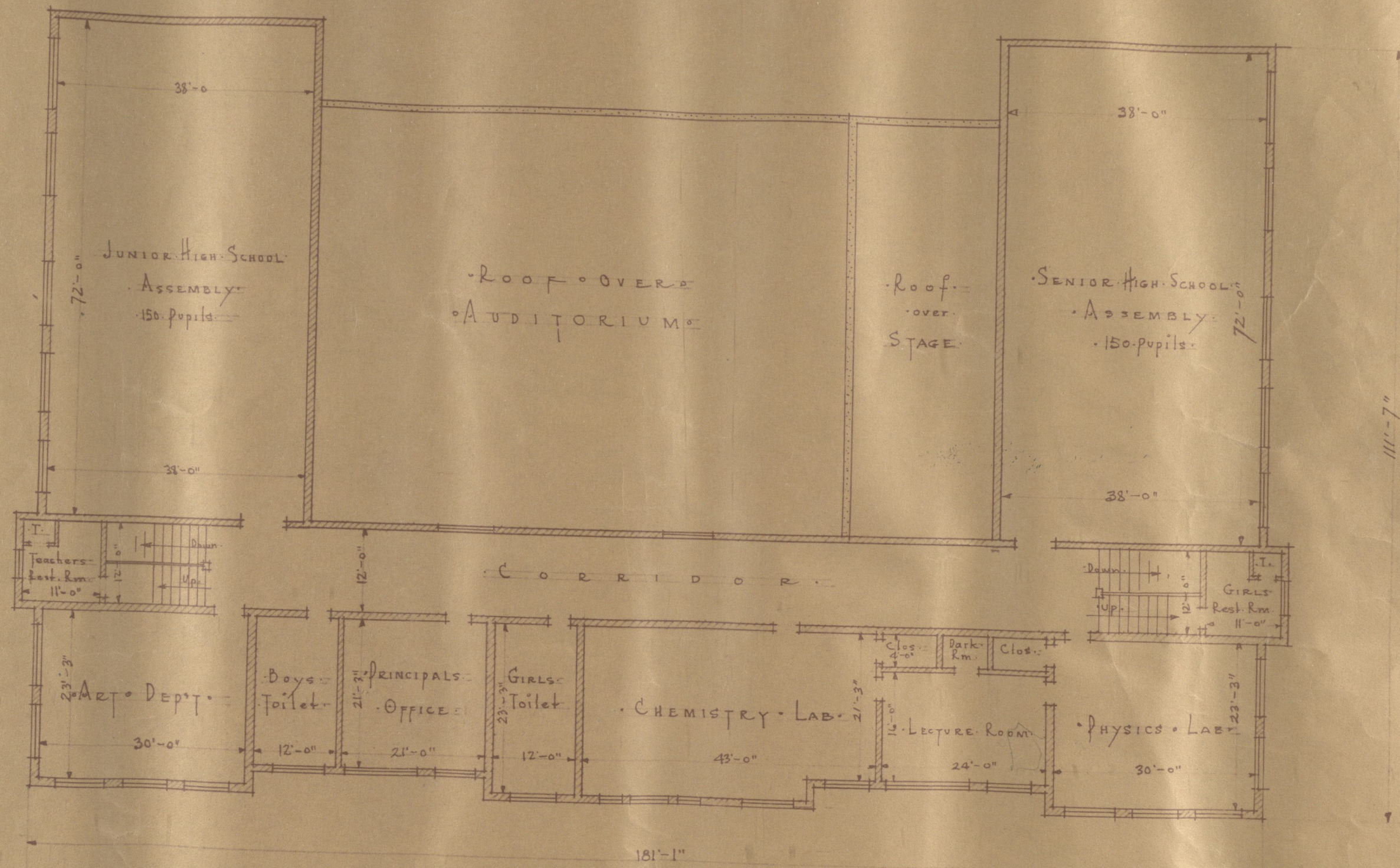

• PROPOSED HIGH SCHOOL •  
 FOR:  
 • DANVILLE INDIANA •  
 Glen Hovermale, Supt.  
 of City School.

• SECOND FLOOR PLAN •  
 Scale  $\frac{1}{16}'' = 12''$   
 • BOARD OF EDUCATION •  
 Walter Hendrick, Secy    John C. Taylor, Pres.  
 Frank Roberts, Treas.    Mrs. Minnie Bridges.

• HENKEL & HANSON •  
 Architects & Engineers  
 • Connersville, Ind. •

